



Vitotherm



Instruction
manual

Automatic forced draught burner

MONO-block | LowNOx

AUTOFLAME[®]

EN (English) original instructions

Burner type

VGI-sXXXX MONO-block for gaseous fuels

VG0I-sXXXX MONO-block for gaseous and liquid fuels

VOI-sXXXX MONO-block for liquid fuels

Original instructions

The original manual is written in UK English. All other language versions are translations of the original manual.

Copyright

All rights reserved © 2020Vitotherm BV.

No part of this publication may be reproduced and/or published by print, photoprint, microfilm or any other means without the written consent of Vitotherm BV.

Disclaimer of liability

The manufacturer cannot be held responsible for personal injury, damage to the burner or property damage caused by incorrect use, foreseeable misuse or failure to follow the instructions in this manual. This also applies to unauthorised modifications of the burner and the use of non-approved spare parts, tools or accessories.

The manufacturer reserves the right to modify this manual without notification beforehand.

Customer service

Our customer service department is available 24 hours a day to provide any required technical information and support.

Please have the burner plate information of the burner available when you contact our customer service department (see §3.9).

+31 (0) 15 369 47 57

Warranty

The equipment supplied by Vitotherm has a one-year warranty covering materials from date of commissioning against defective parts, limited to the delivery of parts only. Warranty is only valid when the installation has been realised in accordance with our instructions and commissioning is executed by a Vitotherm engineer or by Vitotherm authorised personnel.

During the period of the warranty any failures to Vitotherm equipment will be repaired within 10-14 days. Our local service expert for future regular maintenance will be at our daily rate.

Table of Contents

1	Introduction	3			
1.1	About this document	3	4.4	Installing the boiler thermostat set	43
1.2	Relevant documentation	3	4.5	Electrical connections	44
1.3	Symbols and labels	3	4.6	Installing the gas line adapter	44
1.4	Used terms and definitions	4	4.7	Installing the Vitopack	46
1.5	Conformity	4	4.8	Installing the oil pump or firing set	49
2	Safety	7	5	Commissioning	53
2.1	Introduction	7	6	Operation	55
2.2	Intended use	7	6.1	Control panel	55
2.3	Reasonably foreseeable misuse	7	6.2	Frequency drive	57
2.4	Qualification of personnel	8	6.3	Emergency shut down	57
2.5	Protective measures	8	7	Troubleshooting	59
2.6	Residual risks	9	8	Maintenance	63
2.7	Warning labels	10	8.1	Pre-emptive parts replacement schedule	63
2.8	Emergency measures	11	8.2	Annual Periodic Maintenance	64
2.9	Safety precautions	12	8.3	Maintenance of the burner	66
3	Design and function	15	9	Decommissioning and disposal	71
3.1	Burner overview	16	9.1	Decommissioning	71
3.2	Combustor	17	9.2	Dismantling the burner	71
3.3	Gas train (< 7.25 psi)	17	9.3	Disposal	71
3.4	Control panel	18	10	Transport and storage	73
3.5	Boiler thermostat set	19	10.1	Transport	73
3.6	Oil pump	20	10.2	Storage	75
3.7	Modulating oil firing set	21	Appendices		76
3.8	Optional components	22	A	Burner system overview	76
3.9	Burner plate	29	B	Declaration of conformity	77
3.10	Dimensions	30	C	Performance data (Metric)	78
3.11	Performance data	32	D	Checklist Periodic Maintenance	80
4	Installation	35			
4.1	Checking the delivery	35			
4.2	Installing the combustor	36			
4.3	Installing the fan housing	39			

 **therm**



Vitotherm
Firing technology
becomes standard

...the most efficient and most reliable
...the most efficient and most reliable
...the most efficient and most reliable

1 Introduction

1.1 About this document

This manual contains instructions and safety information for operation, installation, commissioning and maintenance of the Vitotherm Automatic forced draught burner.

This manual is intended for:

- the owner of the burner system;
- the worker that operates the burner system;
- the qualified technician that performs the installation of the burner system;
- the engineer that is authorized by Vitotherm to perform (re)commissioning, adjustments, troubleshooting, maintenance and repairs of the burner system.

1.2 Relevant documentation

This manual contains references to external documents that are part of the burner's technical file:

NOTICE The technical file is provided on a USB-drive, located inside the control panel.

- Order confirmation; a document that contains essential information about your specific burner system configuration
- Electrical wiring diagram
- OEM manuals & documentation
- Commissioning report
- Installation overview; a 3D drawing of the setup of your specific burner system configuration

1.3 Symbols and labels

1.3.1 Safety warnings

This manual contains safety warnings that may result in injury when ignored. Each safety warning is indicated with a signal word. The signal word corresponds with the level of risk of the described hazardous situation:

Signal word	Level of risk	If not avoided
⚠ DANGER	High	Will result in death or serious injury
⚠ WARNING	Medium	Could result in death or serious injury
⚠ CAUTION	Low	Could result in moderate or minor injury

Safety warnings given at the start of a section apply to the entire section.

Format example of a safety warning:

Contact with live parts can cause electric shocks, burns or even death.	
⚠ WARNING	<ul style="list-style-type: none">▶ Only perform work on electrical equipment if you are an authorised electrician.▶ Before you start working on electrical equipment: Switch off and lock out the power supply isolator and verify that no voltage is present.

Safety warnings at the start of a section, apply to the entire section.

1.3.2 Notices

Messages that are not hazard-related are indicated with the signal word **NOTICE**. These messages do not have a safety alert symbol.

Format example of a message that is not hazard-related:

NOTICE	Operating the engine at an oil level below the minimum limit value can damage the engine.
	<ul style="list-style-type: none">▶ Regularly check the oil level and refill when necessary.

1.3.3 Other symbols



- This symbol identifies a reference to an external document, such as an OEM manual.
- ▶ This symbol identifies an action or prohibition that serves to avoid a hazardous situation or property damage.

1.4 Used terms and definitions

Term	Definition
Burner	MONO-block burner unit, which includes the fan and combustor.
Burner system	Complete burner assembly as delivered, including gas train and control panel.
Boiler	The heating appliance to which the burner system is connected. A water boiler is the most common type of heating appliance and will be used as the main example in this document.
Boiler house	The building in which the burner system and boiler are installed.
OEM manual	User manual of the original equipment manufacturer.

1.5 Conformity

Vitotherm gas burners carry the CE and EAC marks as a proof of compliance to the following EU directives:

1. GAR 2016-426-EU
2. MD 2006-42-EG
3. PED 2014-68-EU
4. EMC 2014-30-EU
5. LVD 2014-35-EU
6. CE-PIN: 2009/142/EC

See Appendix B for the full declaration of conformity.

[illegible]



2 Safety

2.1 Introduction

Observe the instructions in this manual before you start working with the burner. If you fail to follow the instructions from this manual you can put persons, surroundings, the environment and the burner at risk. Store this manual in an accessible place near the burner for future reference.

- ▶ Always comply with the information, such as labels and the burner plate, attached directly to the burner and keep the information in a legible condition.
- ▶ Always comply with applicable local laws and regulations.

The burner is equipped with several safety components that ensure safe working with the burner.

2.2 Intended use

The Vitotherm Automatic forced draught burner is a burner for intermittent firing and continuous firing of a boiler or other heating appliance.

The range of applications and type of fuels that the delivered burner type can handle are explained in the Declaration of Conformity. Other fuels must be confirmed by Vitotherm BV.

- The burner must only be operated with the type of fuel as indicated on the burner plate and in the order confirmation.
- The fuel supply pressure must not exceed the pressure given on the burner plate.
- The burner must not be operated outside its operating range (see load values on the burner plate).
- The burner must only be used for an application in compliance with the requirements in the order confirmation.
- The burner only be used under ambient conditions in compliance with the requirements in the order confirmation.
- The burner must only be used in compliance with applicable local laws and regulations.

Safe use of the burner is only guaranteed if it is used as intended.

2.3 Reasonably foreseeable misuse

The following is considered foreseeable misuse:

- Operation and use of the burner that deviates from the intended use as described in the previous section.
- Failure to comply with the instructions in this manual.
- Failure to eliminate faults, malfunctions or defects of the burner that impose safety risks.
- Failure to carry out the inspections and maintenance operations as described in this manual.
- Unauthorized removal or modification of parts or safety components of the burner.
- Use of spare parts or accessories that have not been approved by the manufacturer.
- Operation in a closed-off or poorly ventilated room.

2.4 Qualification of personnel

Only authorised personnel is allowed to operate and clean the burner. They must possess the following qualifications:

- are legal of age;
- are familiar with and abide by the safety instructions and sections of this manual related to operating the burner;
- are familiar with and abide by the applicable local, national and international laws and regulations;
- are officially trained and certified by Vitotherm B.V.
- have received adequate training to operate and clean the burner;
- have obtained authorisation to access the burner.

Only authorised technicians are allowed to perform installation and maintenance of the burner. They must possess the following qualifications:

- are legal of age;
- are familiar and abide by the safety instructions and sections of this manual related to installation and maintenance of the burner;
- are familiar with and abide by the applicable local, national and international laws and regulations;
- are able to recognize the possible dangers of the burner and take the necessary measures to protect persons and property;
- have received adequate training in the safe maintenance of the burner;
- have obtained authorisation to access the burner.

2.5 Protective measures

2.5.1 Personal protective equipment (PPE)

Personnel that operates the burner must equip themselves with the following:

Technicians that install or perform maintenance on the burner must equip themselves with the following:



Wear foot protection



Wear foot protection



Wear eye protection



Wear eye protection



Wear ear protection (above 80 dB).



Wear protective gloves



Wear head protection (during lifting work)

2.5.2 Organizational measures

The owner is responsible for carrying out the necessary organizational measures to ensure safe use. Amongst other measures this is achieved by, but not limited to:

- Training and authorising personnel. Vitotherm is responsible for distributing passwords to authorised personnel only.
- Performing hazard assessments of the complete system that incorporates the burner and informing personnel of the possible dangers and protective measures.
- Performing good housekeeping in the facility that houses the burner.
- Running a preventive maintenance program.

2.6 Residual risks

Despite the safe design and construction of the burner and the prescribed protective measures, the burner poses residual risks. This manual provides safety messages to indicate these risks. The formatting and appearance of safety messages that are dedicated to a particular section or sentence are explained in chapter 1. Overall safety messages are grouped in the following sections.

2.6.1 Combustible materials

⚠ WARNING

The burner system contains pressurized components and piping containing combustible fuels.

- ▶ Install pipework in accordance with the applicable rules and standards.
- ▶ Protect pipework against corrosion and mechanical forces.
- ▶ Take fire prevention and control measures in accordance with governmental rules and regulations.
- ▶ Provide proper means of emergency escape.
- ▶ Store the fuel in accordance with governmental rules and regulations.
- ▶ Always consider your own safety, that of others and the risks for the environment that may arise due to fuel escaping.

2.6.2 Combustion process

⚠ WARNING

An incomplete combustion process can produce toxic gases.

- ▶ Equip the boiler house with properly sized vents. The boiler must have a gas-tight gas flue to the outside in accordance with locally applicable standards.
- ▶ Make sure that the burner is always supplied with sufficient clean combustion air.
- ▶ Do not store or process anything near the air intake vents.
- ▶ Make sure that fan opening is never blocked (e.g. by a loose object such as pieces of paper).
- ▶ Provide proper means of emergency escape.

2.6.3 Electricity

⚠ WARNING

Contact with live parts can cause electric shocks, burns or even death.

- ▶ Only perform work on electrical equipment if you are an authorised electrician.
- ▶ Perform the work on electrical equipment in accordance with the local safety standards.
- ▶ Do not make changes to the burner system if you are not qualified to do so.
- ▶ Before you start working on electrical equipment: Switch off and lock out the power supply and verify that no voltage is present.
- ▶ Use fuses that correspond with the installed power of the burner.
- ▶ Regularly check the electrical wiring for loose connections and damage and repair them without delay.

2.6.4 Mechanical

⚠ WARNING

The burner system contains moving, pressurized and sharp parts that can crush, cut or hit.

- ▶ Do not operate the burner with covers or guards removed.
- ▶ Do not operate the burner with missing pipework or components.
- ▶ Never touch the air damper box during operation.
- ▶ Be aware of sharp edges.

2.6.5 Temperature

⚠ CAUTION

The interior parts and surfaces of the burner that reach high temperatures cannot be reached under normal operating conditions.

- ▶ Do not expose and/or touch interior parts and surfaces of the burner during operation or shortly after operation.
- ▶ Properly isolate hot surfaces of the burner system.

2.7 Warning labels

Always comply with warning labels and information signs on the burner. The warning labels and information signs must be kept legible and must be replaced if necessary. For this purpose, contact the manufacturer.

2.8 Emergency measures

The following emergency situations require special measures to be taken:

2.8.1 Gas leak

For VGI or VGOI

The smell of gas nearby the burner can indicate a leak in the gas supply of the burner system.

⚠ WARNING

Gas leaking from the burner system is highly flammable.

- ▶ Switch off or remove any potential sources of ignition when a potential gas leak is detected.
- ▶ No smoking! Avoid open flames and sparks.
- ▶ Open doors and windows of the boiler house.
- ▶ Close the gas shut-off valve.
- ▶ Shut down the burner system.

To fix a gas leak:

1. Use gas leak spray or a gas detection device to trace/detect the leak.

NOTICE

Gas leaks usually occur at the gaskets or couplings of the gas train.

If the leak occurs at a gasket or coupling:

1. Switch off the gas supply.
2. Replace the gasket or coupling.
3. Tighten all nuts, bolts and flanges.
4. Apply a soap solution to the new gasket or coupling.
5. Pressurize the gas train.
6. Check for any soap bubbles.

2.8.2 Oil leak

For VOI or VGOI

Oil leaks can be dealt with similarly to gas leaks. The main difference is that oil leaks can be visually detected.

⚠ CAUTION

Oil flows through the installation at pressures of up to 435 psi.

- ▶ Always keep a safe distance from an oil leak.

2.8.3 Fire

When fire is detected on or around the burner, take the following measures:

⚠ WARNING

Fires on or around a burner system can lead to a gas explosion.

- ▶ Always store a fire extinguisher close to the burner.
-

1. Call the emergency number.
2. Use the control switch on the control panel to close the fuel supply to the burner.
3. Use the manual emergency shut-off switch outside the boiler house to close the gas supply to the boiler house.
4. Use the fire switch outside the boiler house to cut off the power to the burner.

2.9 Safety precautions

A burner system is equipped with several safety components that help prevent dangerous situations.

For more information about safe use of the burner, see chapter 4.



For more information about the integration of the safety components into the system, please refer to the electrical wiring diagram.

2.9.1 Flame sensor

The flame sensor monitors the intensity of the flame. In case the flame intensity does not correspond with the control mode and sequence, the system is switched off and an alarm is activated.

2.9.2 Gas safety valve

The gas safety valve is an integrated hydraulic component that automatically closes the fuel supply when a low intensity or absent flame is detected.

2.9.3 Gas leak detection system

The gas leak detector is an integrated system that checks the gas safety valves for internal leaks via a 2-fase test.

2.9.4 Low water level cut-off system

The low water cut-off system consists of a low water sensor in the boiler and a cut-off relay in the control panel. The sensor is part of the boiler thermostat set (see §3.5).

The cut-off system shuts down the burner when the water level in the boiler is too low.

2.9.5 Max. thermostat

The maximum temperature thermostat (fail safe) boiler shuts down the burner if the water temperature exceeds the boiler design temperature.

The thermostat is part of the boiler thermostat set (see §3.5).

2.9.6 Min. air pressure sensor

The minimum air pressure sensor shuts down the burner if the produced pressure by the combustion air fan is too low.

The air pressure sensor is part of the burner (see §3.1).

2.9.7 Min. & Max. gas pressure sensors

The minimum gas pressure sensor shuts down the burner if the gas supply pressure is too low. The maximum gas pressure sensor shuts down the burner if the gas supply pressure is too high.

The gas pressure sensors are part of the gas train (see §3.3).



TK-Topboiler
Kesselbau GmbH

3 Design and function

The Vitotherm Automatic forced draught burner consists of a MONO-block burner unit and a low NOx burner head. The standard burner system consists of the following components:

NOTICE

The illustrations shown in this manual show a VGOI burner system configuration with a Vitopack and an Autoflame MK8 control system. Your specific burner system configuration may differ from these illustrations.

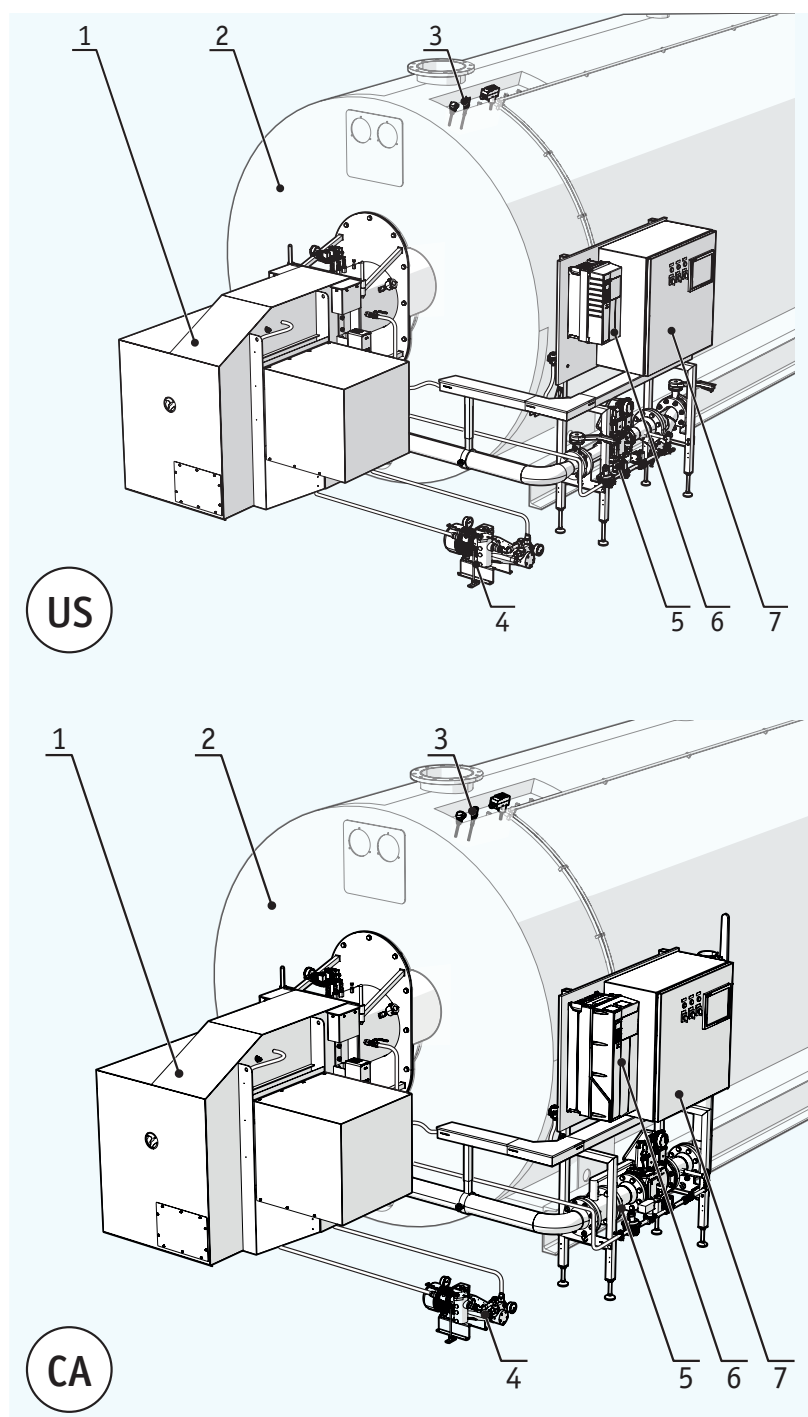

The exact configuration of the burner depends on the following factors:

Control system

► Autoflame MK8

Lamtec Etamatic

Fuel type(s)

VGI (gas)

VOI (oil)

VGOI (gas & oil)

Optional components

See §3.8

1. Burner
2. Boiler
3. Boiler thermostat set
4. Oil pump (for V(G)OI)
5. Gas train
6. Frequency drive
7. Control panel

3.1 Burner overview

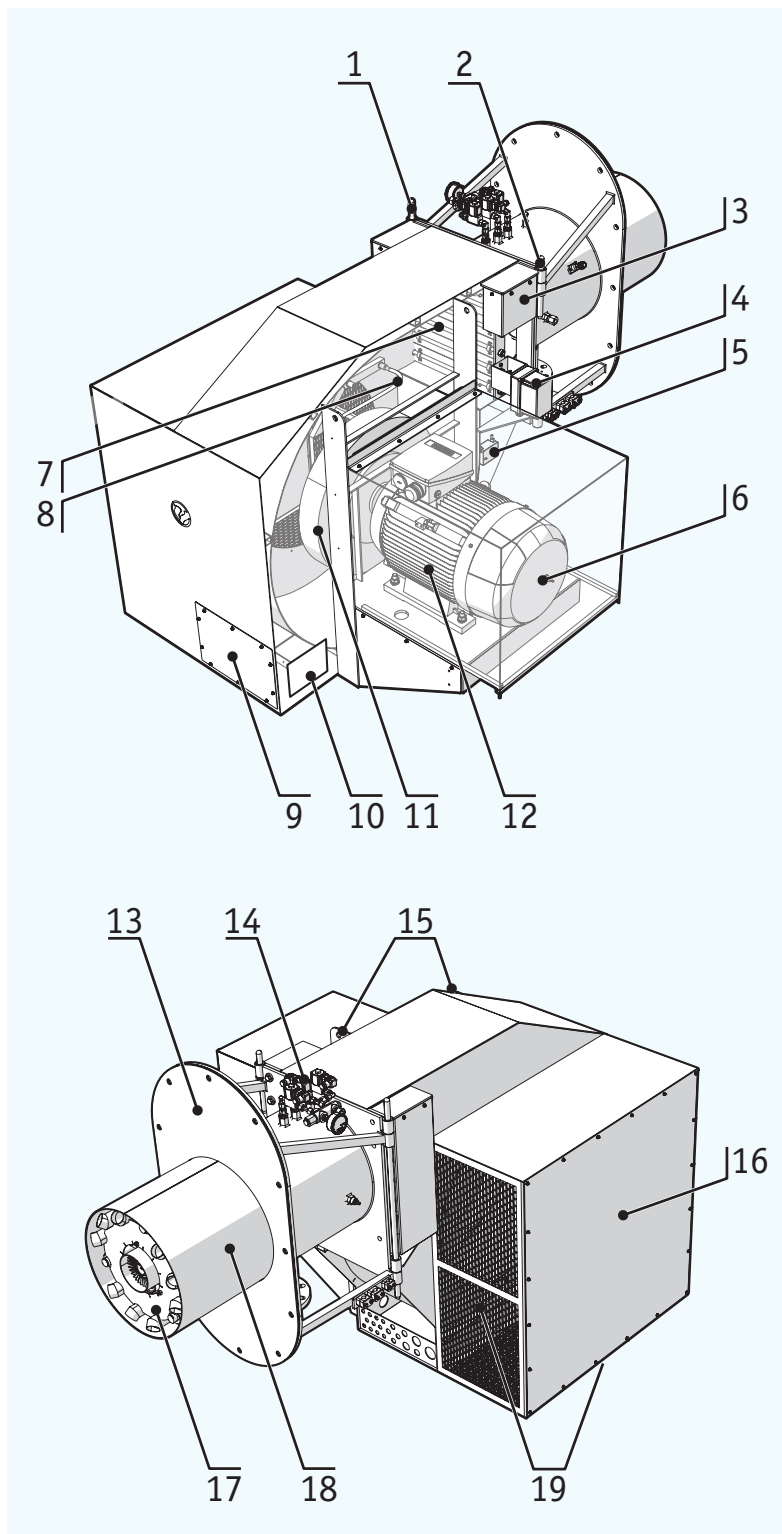

1. Hinge pin
2. Locking pin
3. Air damper position switches
4. Air damper servomotor
5. Ignition transformer
6. Proximity switch
7. Air valves
8. Air tube
9. Junction box
10. Burner plate
11. Burner fan
12. Blower motor
13. Combustor mounting flange
14. Oil supply valves (VGOI only)
15. Hoisting holes
16. Fan housing
17. Low-NOx burner head
18. Combustor housing
19. Air inlets

3.2 Combustor

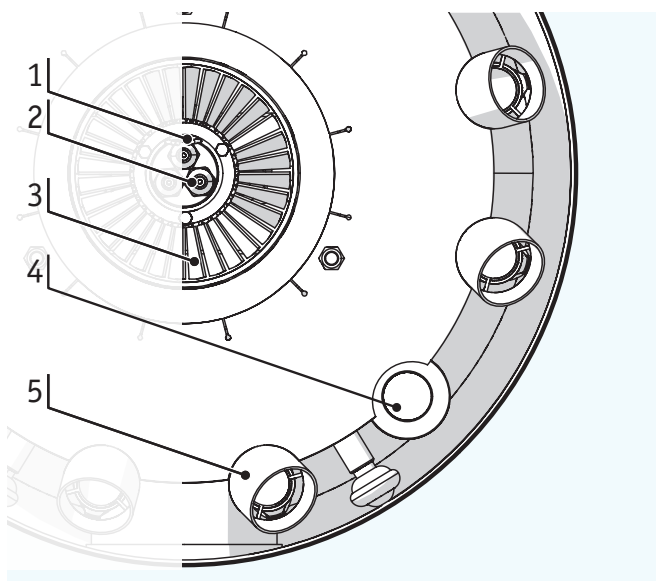

1. Ignition pin
2. Oil nozzle(s):

burner	nozzles		
	1	2	3
VGOI 100-400		●	
VGOI 450-1250			●
VGOI & VOI (modulating)	●		

3. Air swirler pilot flame
4. Stabilising gas nozzle
5. Gas firing nozzle

3.3 Gas train (< 7.25 psi)

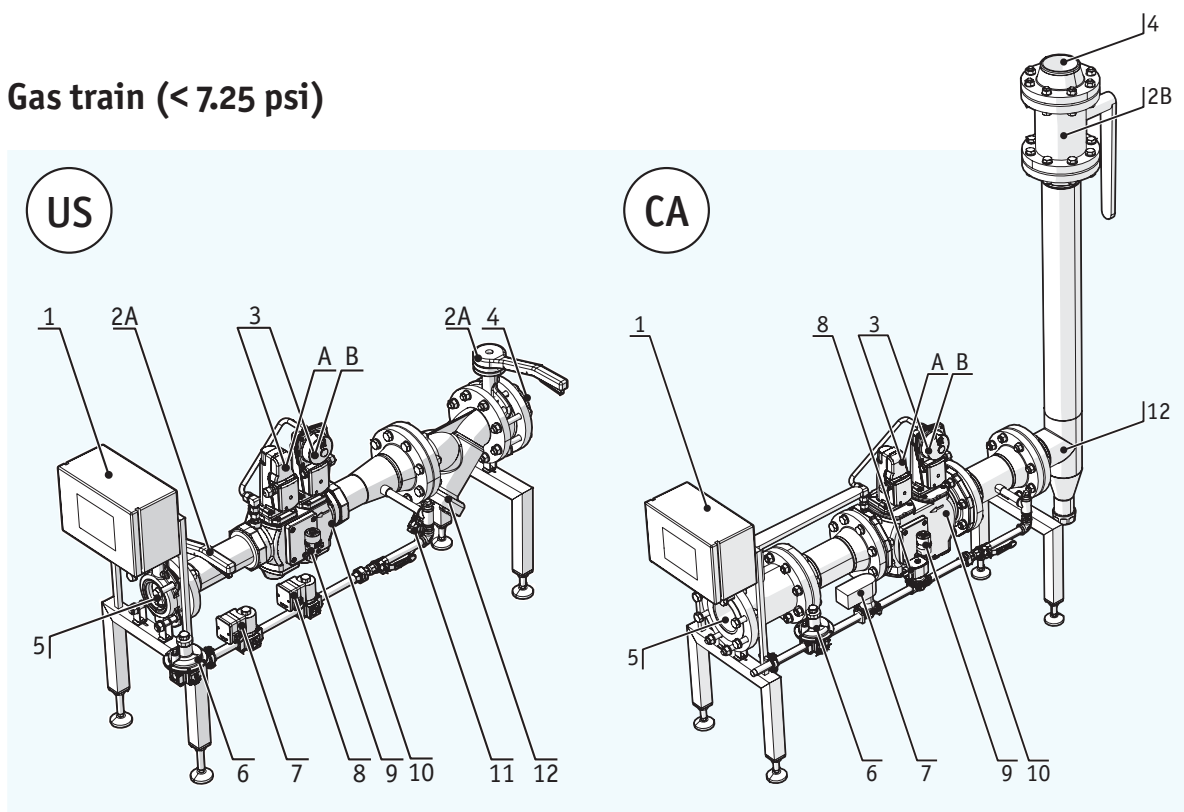

1. Junction box
2. A) Butterfly valve
B) Lubricated plug valve
3. Actuators
A) VA1 – Open/close
B) VA2 – Regulator
4. Gas supply line connection
5. Gas line adapter connection

6. Gas pilot pressure regulator (DR2)
7. Pilot gas valve (MK2)
8. Pilot gas valve (MK1)
9. Gas pressure sensors (LT + HD)
10. Safety shut-off valves (double valve block)
11. Relief valve (US only)
12. Gas filter

3.4 Control panel

The burner is supplied with a control panel. The control panel is equipped with two displays, operation switches and indicator lights.

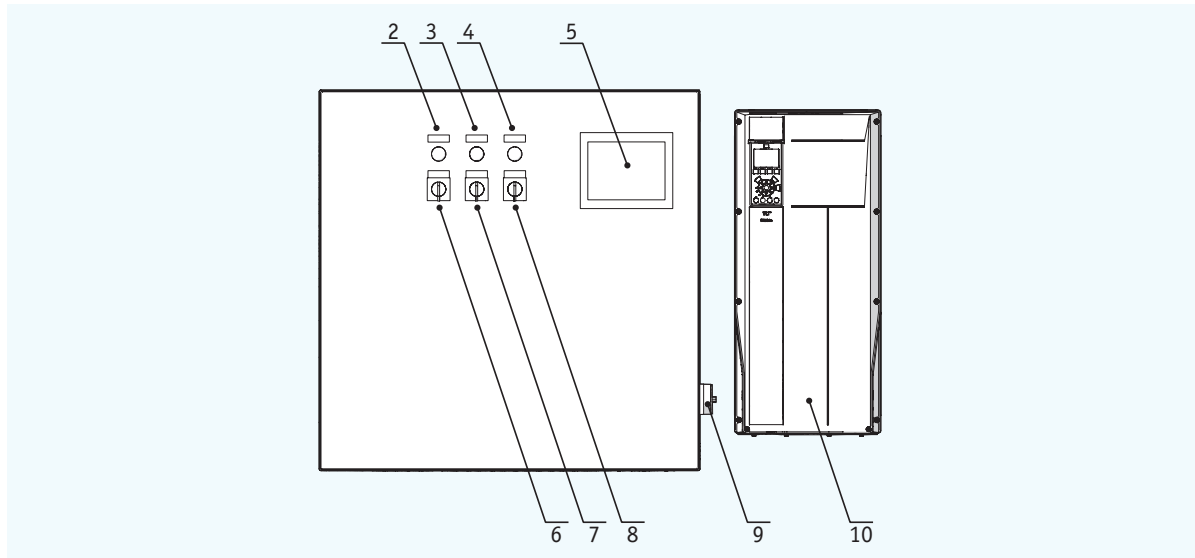

The following switches and lights are available on a standard control panel:

No.	Description		Function
1	Vitotherm display		Displays system failures and manufacturer information
2	Computer functional light		Lights green when the external computer is active
3	Failure light		Lights red when a system failure is active
4	Reset button		Resets the complete burner system
5	Burner management display		Manual burner controls
6	Control switch	Computer	Switches control to external computer
		Off	Switches control off
		Manual	Switches control to burner management system
7	Mode switch	Automatic	Switches to automatic burner control
		Low	Sets the burner to low flame state
		Manual	Switches to manual burner control
8	Fuel switch (VGOI only)	Gas	Selects gas as the fuel supply
		Oil	Selects (modulating) oil as an additional fuel supply.
9	Main power switch		Activates the control panel
10	Frequency drive		Controls the speed of the burner fan

Depending on the configuration of the burner system, the control panel may have additional buttons, lights and displays. For more information, please refer to the electrical wiring diagram.



For more information about the burner management display, please refer to the OEM manual.

3.4.1 Frequency drive

The fan motor is frequency driven. A separate frequency controller is mounted next to the control panel.



For more information and instructions, please refer to the OEM manual or §6.2 of this manual.

3.4.2 Servomotors

The combined control of the gas supply valve and the air damper by servomotors regulate the gas and air flow for the burner.

3.5 Boiler thermostat set

The boiler thermostat set consists of three components:

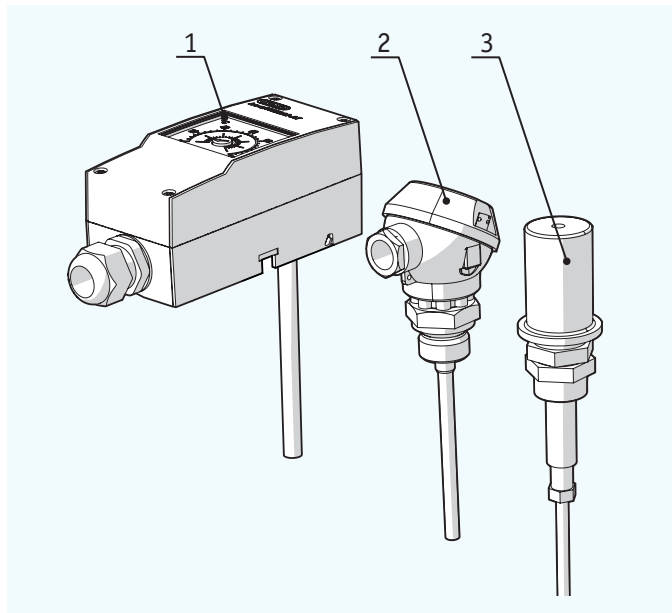

1. Max. boiler temperature thermostat
2. Temperature sensor (pt1000)
3. Low water level sensor

The low water level sensor is connected to a cut-off relay in the control panel to form a low water cut-off system (see §2.9).

The boiler thermostat set is not yet installed upon delivery. For installation instructions, see §4.4.



For more information, please refer to the OEM manuals (JUM0).

3.6 Oil pump

For VOI or VGOI

An oil pump can be mounted next to the burner to enable the burner to run on oil for short periods of time. The oil pump is equipped with a mounting frame.

When this option is present in the system, a fuel control switch is added to the control panel.

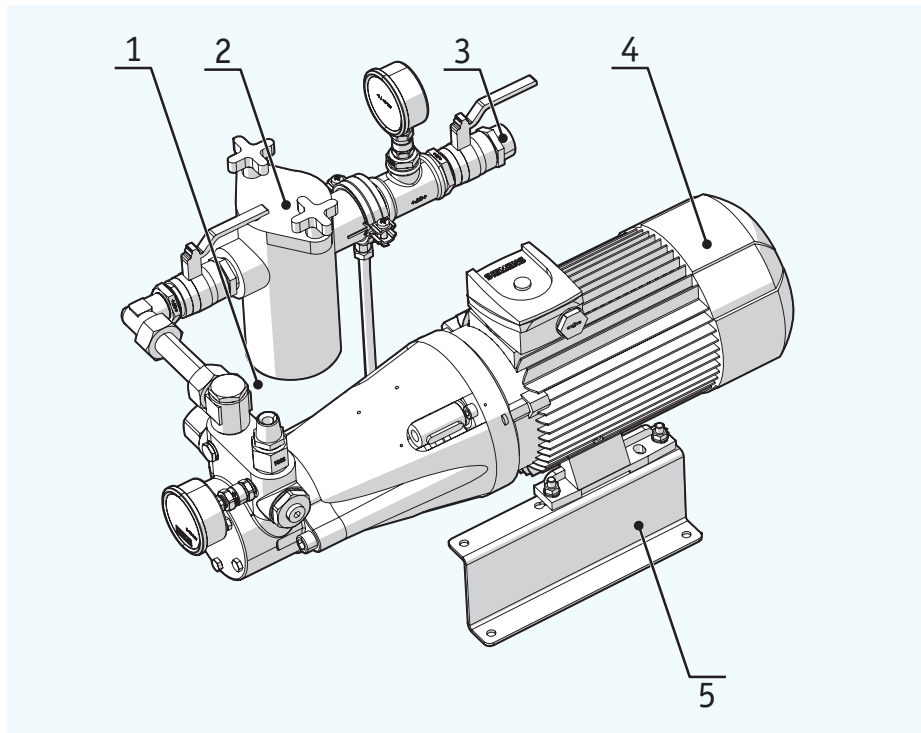

1. Burner oil supply connection
($\frac{1}{2}$ " NPT)
2. Oil filter
3. Oil supply line connection
4. Oil pump
5. Mounting frame

3.7 Modulating oil firing set

For VOI or VGOI

The modulating oil firing set enables the burner to run partially or completely on oil for long periods of time. The oil supply is automatically controlled based on the return pressure.

When this option is present in the system, a fuel control switch is added to the control panel.

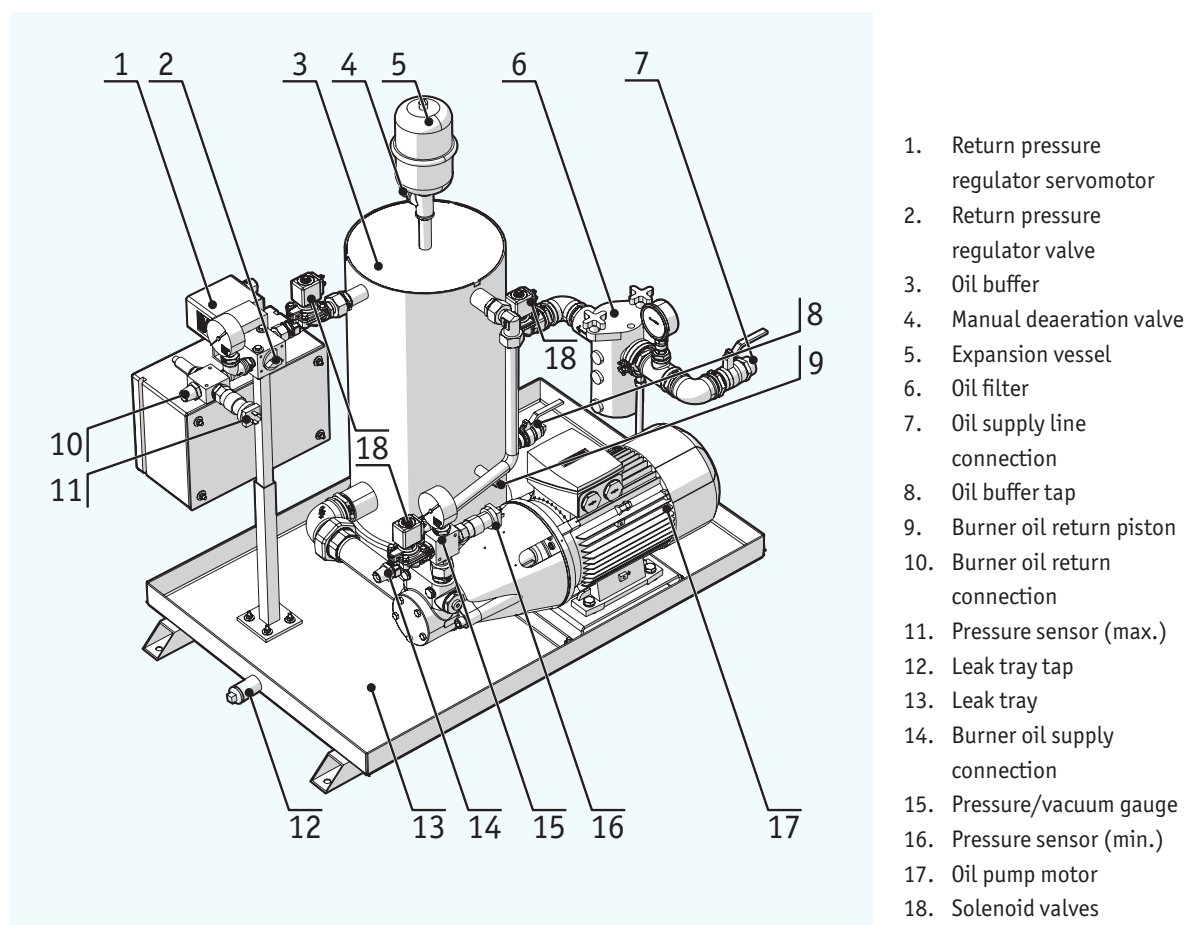

3.8 Optional components

Optional components can be added to the burner to adapt it to special circumstances or add new functions. For an overview of a burner system with all optional components, see Appendix A.

3.8.1 Backup two-stage oil firing set (80%)

For VGOI

The back-up two-stage oil firing set enables the burner to run on oil for short periods of time (max. 48 hours) in emergency situations (e.g. a gas supply blockage). The back-up set can provide 80% of the burner's regular power.

When this option is present in the system, a fuel control switch is added to the control panel.

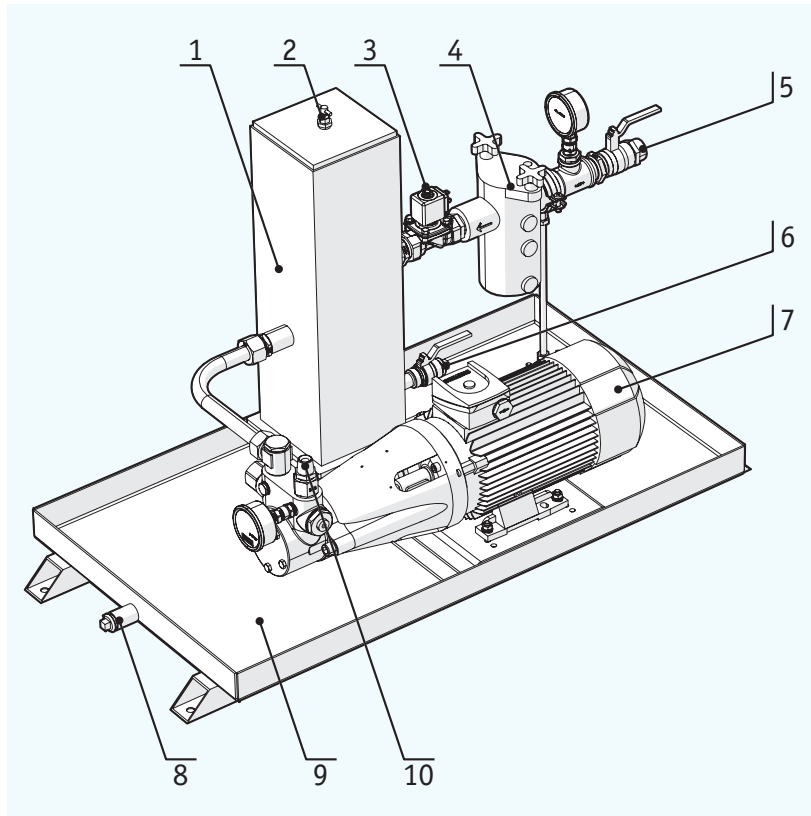

3.8.2 Vitopack

The Vitopack is a premade installation that integrates a gas train, a gas line adapter with butterfly valve, a control panel and a frequency drive.

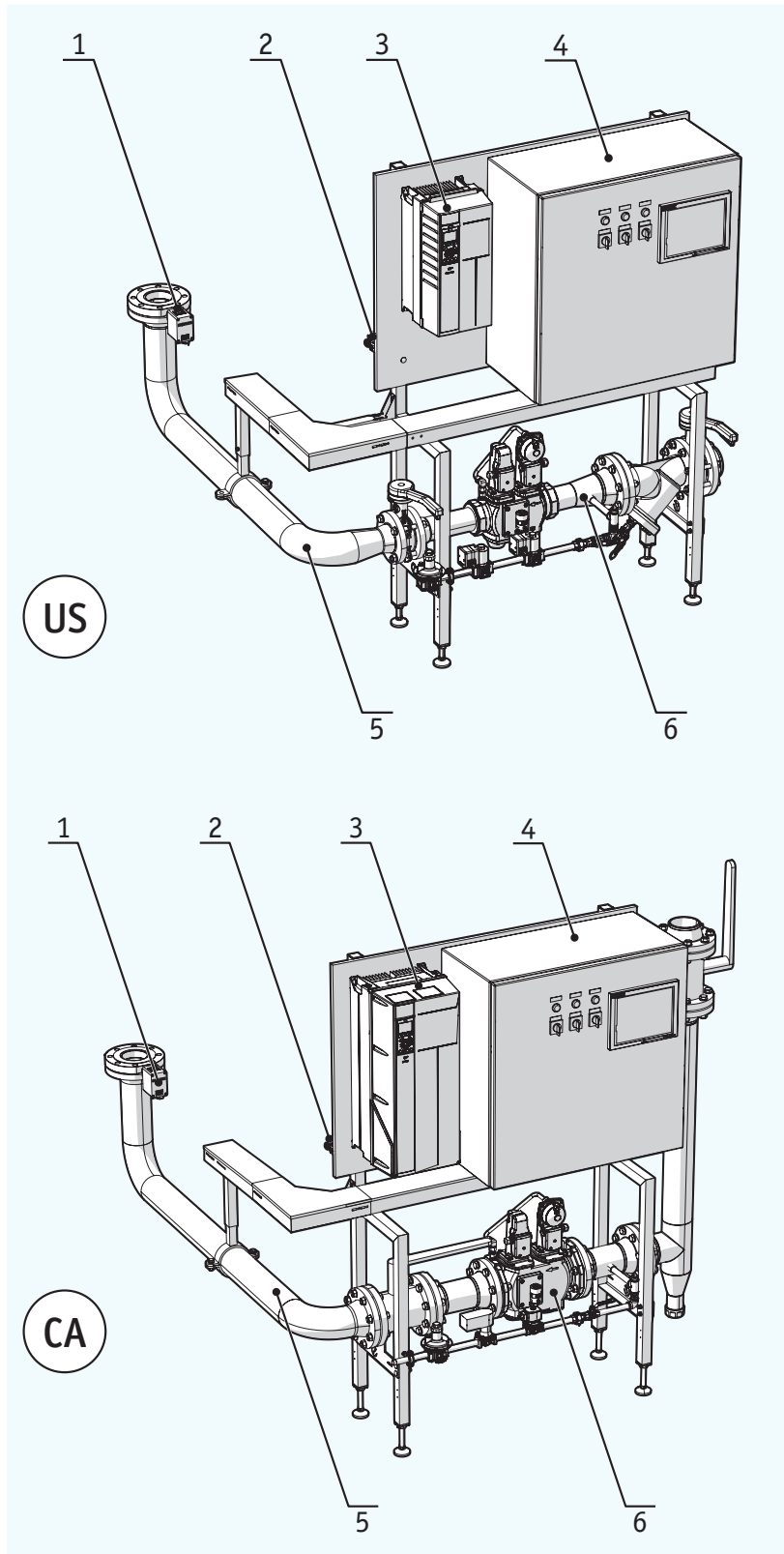

Vitopack 1 is the standard configuration. Vitopack 2 is also available, and includes a blast tube mounting with refractory and pre-wiring of the boiler. Both configurations come with the option of being fully pre-wired, with connections to all parts of the burner system.

1. Butterfly valve
2. Air pressure sensor
3. Frequency drive
4. Control panel
5. Gas line adapter
6. Gas train (< 7.25 psi)

3.8.3 Vitotherm gas line adapter

A Vitotherm gas line adapter connects the gas train to the burner head. Vitotherm offers the option of a custom design that fits your installation.

The gas line adapter is made of powder-coated steel. A standard delivery includes all components necessary for installation (bolts, nuts, rings, gaskets). For instructions on how to install this component, see §4.6.

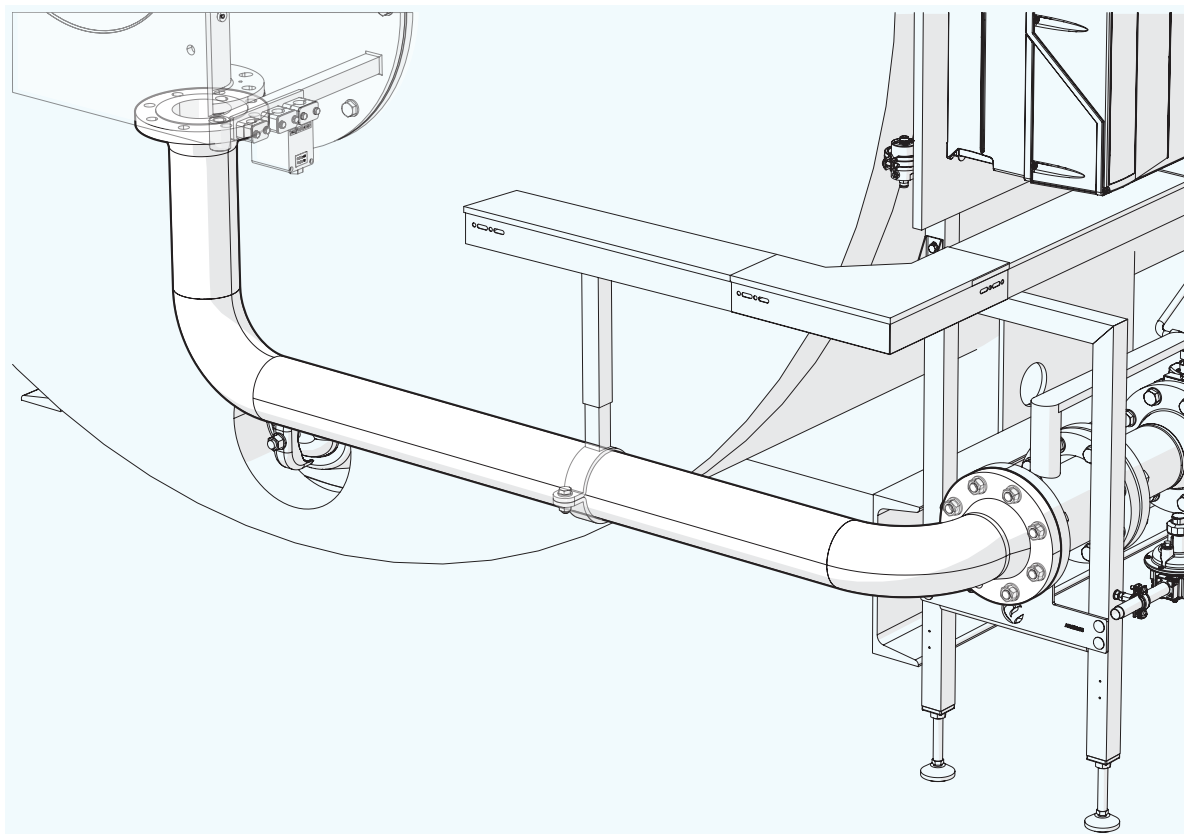

3.8.4 High pressure gas regulator set

58-116 psi to 2.9-4.4 psi

A high pressure gas regulator set can be added to a standard gas train to adapt it to higher gas supply pressures. The set can reduce supply pressures of 58-116 psi to 2.9-4.4 psi.

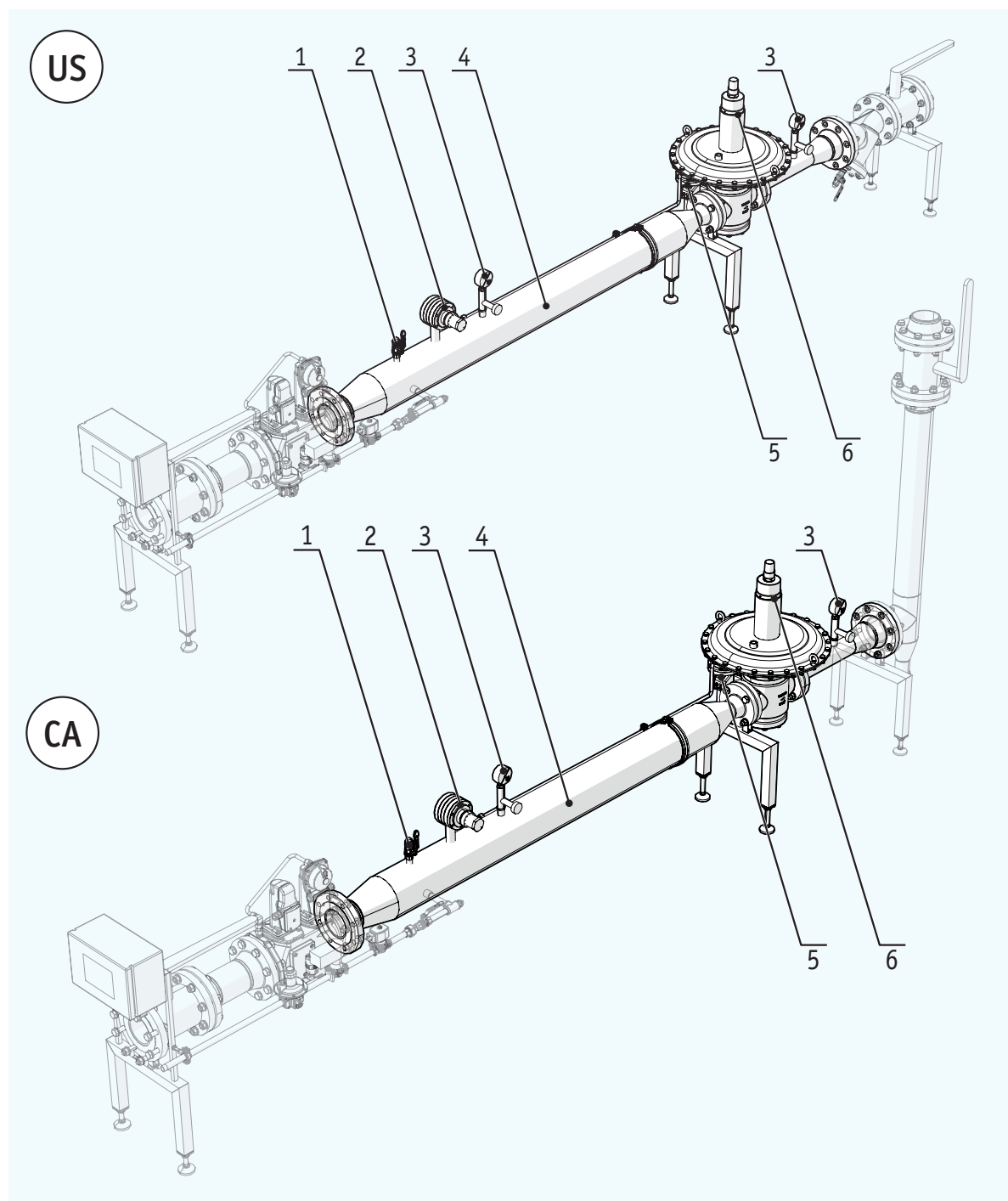

- | | |
|---------------------------------|--|
| 1. Relief valve | 4. Pressure stabilising section (outflow tube) |
| 2. Safety pressure relief valve | 5. Safety shut-off valve |
| 3. Pressure gauge | 6. Pressure regulator |

3.8.5 Spareparts set

A set of spare parts is available. This set contains parts of the burner that are to be replaced within 1 or 2 years (see §8.1).

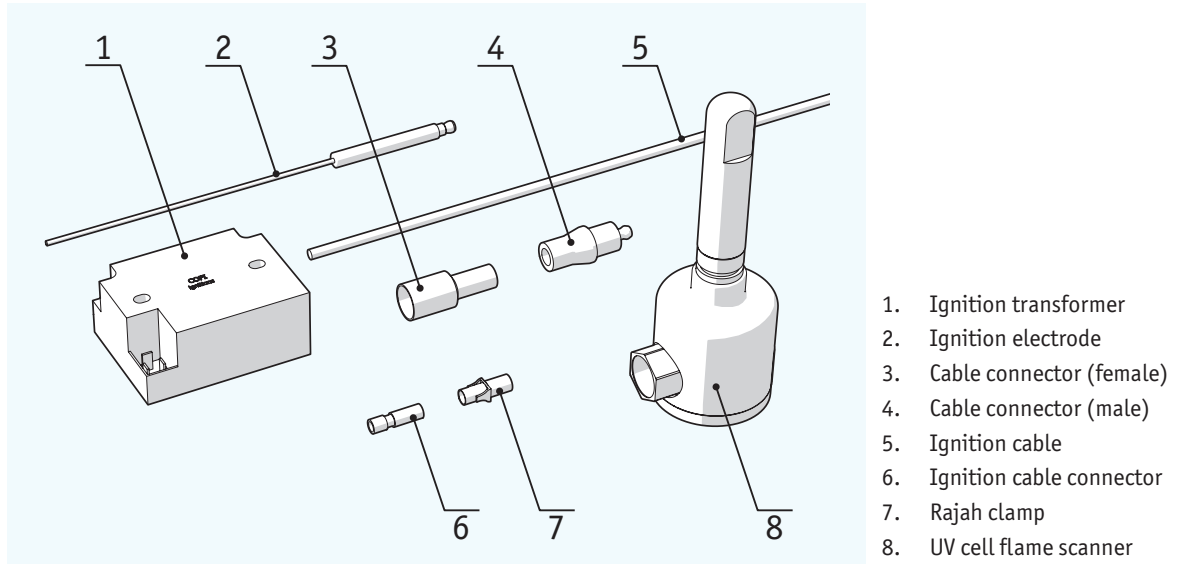

3.8.6 Gas train actuator heating elements

Heating elements can be placed on the actuator of the gas train. The heating elements keep the hydraulic oil in the actuator up to temperature in cold environments. Vitotherm recommends to include this option in an outdoor burner system or in a cold boiler house.

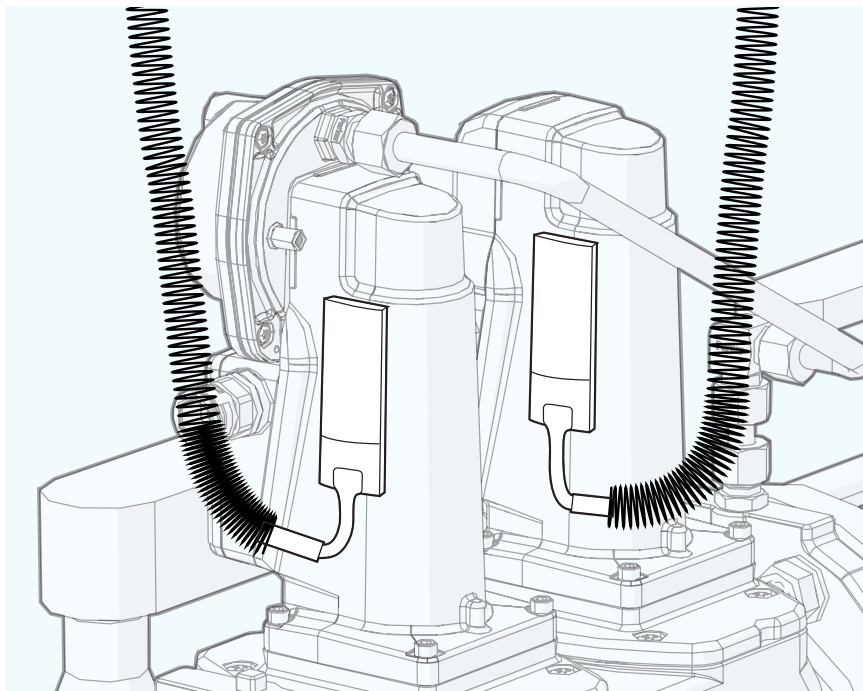

3.8.7 Flue gas valve circuit

A flue gas valve circuit controls the flue gas valve of CO₂ systems equipped with a CO₂ collector with multiple CO₂ sources. The circuit closes the flue gas valve in the flue gas outlet to the CO₂ collector when CO is detected in the flue gas of the system (e.g. when the burner is activated). This prevents CO from entering the CO₂ collector.

3.8.8 Vitotherm CO detector

type VCD2 with sampling pump

A Vitotherm CO detector checks the flue gas that is transported from the burner to external applications (e.g. greenhouses) for carbon monoxide. The CO detector is mounted near the flue gas exhaust.

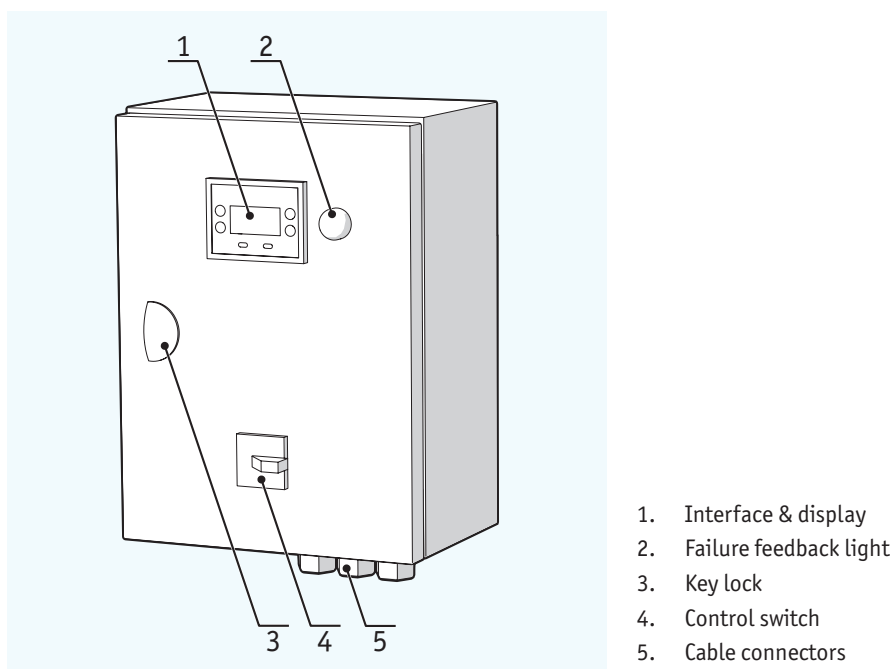

For more information, please refer to the Vitotherm CO detector user manual.

3.8.9 O₂ controller

EGA

An O₂ controller regulates the amount of O₂ that is added to the fuel mixture. This compensates for differences in gas quality (caloric value) and improves the efficiency of the burner.



For more information, please refer to the OEM manual.

3.8.10 Remote access monitoring

DTI

A server solution is available that enables remote access to information about the burner (e.g. measurement data, logs, error codes). This enables Vitotherm to monitor the burner and provide improved technical support.

Remote access monitoring is recommended for burners in remote locations.



For more information, please refer to the OEM manual.

3.8.11 Facilities for a one-pass boiler

A one-pass boiler must be equipped with a safety circuit that prevents the flue gases and return water from becoming too cold. This can cause condensation to form in the flue gas pipes, causing corrosion damage.

The safety circuit consists of:

- Minimum flue gas temperature monitor
- An extra max. boiler temperature thermostat
- An extra low water level sensor

When this option is present in the system, a fuel control switch is added to the control panel.

3.8.12 Seaworthy packaging

If the burner needs to be well protected or shipped overseas, it can be packed in wooden crates treated according to ISPM 15.

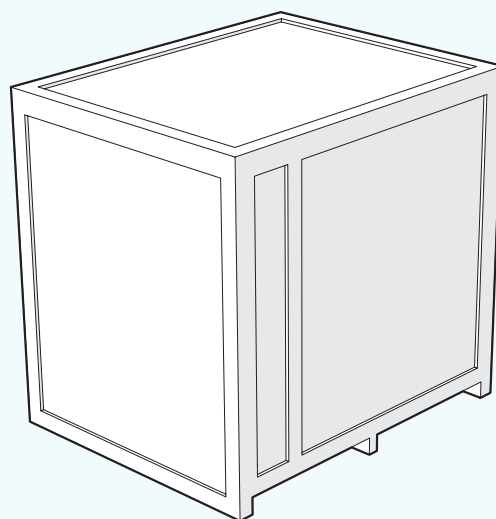

3.9 Burner plate

The burner is marked in accordance with the applicable legislation requirements. The location of the burner plate is indicated in §3.1.



Vitotherm

Vitotherm BV
 Overgauwseweg 8
 2641 NE Pijnacker
 Tel: 015-3694757
 Fax: 015-3697742

1	•	Type: <input style="width: 90%;" type="text"/>	•	10
2	•	Serial nr.: <input style="width: 90%;" type="text"/>	•	11
3	•	Production year: <input style="width: 90%;" type="text"/>	•	12
4	•	Destination country: <input style="width: 90%;" type="text"/>	•	13
5	•	Max. Input-gas: <input style="width: 90%;" type="text"/> kW (Hi):	•	14
6	•	Min. Input: <input style="width: 90%;" type="text"/> kW (Hi)	•	15
7	•	Max. Input-oil: <input style="width: 90%;" type="text"/> kg/h	•	
8	•	Pin no: <input style="width: 90%;" type="text" value="0461BR0858"/>	•	
9	•	Nobo: <input style="width: 90%;" type="text" value="0461/18"/>	•	
		Gas cat: <input style="width: 90%;" type="text"/>	•	
		Voltage: <input style="width: 90%;" type="text"/> V	•	
		Frequency: <input style="width: 90%;" type="text"/> Hz	•	
		Current: <input style="width: 90%;" type="text"/> A	•	
		Gas pressure: <input style="width: 90%;" type="text"/> mbar	•	
		Burner cat.: <input style="width: 90%;" type="text" value="B23"/>	•	
			•	16

This burner must be installed according to the rules in force, and should be used only in a well ventilated area.

Before the burner is installed and put into operation, the instruction manual must be read.

The electrical part of the burner is built according to the EN 60529, the voltage and amperage is as indicated on the nameplate of the burner.

When servicing the burner the main switch and the gas supply must be switched off at all times.

- | | |
|---|---|
| <ol style="list-style-type: none"> 1. Burner type 2. Serial number 3. Year of manufacture 4. Country of destination 5. Maximum load (kW) 6. Minimum load (kW) 7. Maximum oil consumption (kg/h) 8. Pin number | <ol style="list-style-type: none"> 9. Notified body 10. Gas category 11. Voltage (V) 12. Frequency (Hz) 13. Current (A) 14. Gas pressure (mbar) 15. Burner category 16. CE and EAC markings |
|---|---|

3.10 Dimensions

This section contains the standard dimensions of a MONO-block burner. For technical data regarding your specific burner system configuration, please refer to the burner plate (see §3.9) or the order confirmation.

3.10.1 Combustor mounting flange

The combustor must be mounted on a boiler by using a mounting flange. The design and dimensioning of this mounting flange depends on the heating capacity of the burner:

Art.Nr.	Burner type	D1 (in)	D2 (in)	D3 (in)	D4 (in)	D5 (in)	D6 (in)	A1 (deg)	Nuts (ISO)
100168	VG(0) Is-1250	44 $\frac{19}{64}$	24 $\frac{39}{64}$	$\frac{15}{32}$	20 $\frac{9}{32}$	22 $\frac{1}{4}$	9 $\frac{27}{32}$	45	M16
100167	VG(0) Is-1000	44 $\frac{19}{64}$	24 $\frac{39}{64}$	$\frac{15}{32}$	18 $\frac{5}{16}$	22 $\frac{1}{4}$	9 $\frac{27}{32}$	45	M16
100166	VG(0) Is-700- 800	32 $\frac{31}{64}$	22 $\frac{41}{64}$	$\frac{15}{32}$	16 $\frac{11}{32}$	20 $\frac{9}{32}$	9 $\frac{27}{32}$	60	M16
100165	VG(0) Is-450- 500-600	26 $\frac{37}{64}$	18 $\frac{45}{64}$	$\frac{15}{32}$	14 $\frac{11}{64}$	16 $\frac{11}{32}$	$7\frac{7}{8}$	60	M16
100164	VG(0) Is-350- 400	26 $\frac{37}{64}$	18 $\frac{45}{64}$	$\frac{15}{32}$	12 $\frac{13}{32}$	16 $\frac{11}{32}$	$7\frac{7}{8}$	60	M16
100163	VG(0) Is-200- 250-300	-	13 $\frac{25}{32}$	$\frac{15}{32}$	10 $\frac{53}{64}$	12 $\frac{13}{32}$	-	60	M12
100162	VG(0) Is-150	-	13 $\frac{25}{32}$	$\frac{15}{32}$	9 $\frac{29}{64}$	12 $\frac{13}{32}$	-	60	M12
100161	VG(0) Is-100	-	13 $\frac{25}{32}$	$\frac{15}{32}$	8 $\frac{17}{64}$	12 $\frac{13}{32}$	-	60	M12

3.10.2 MONO-block

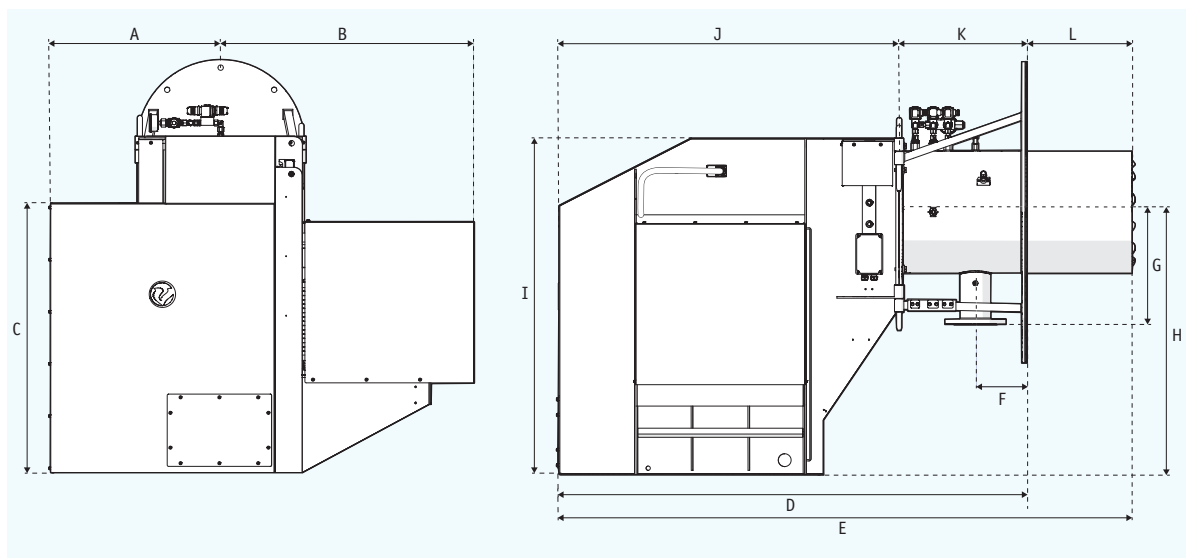

Burner type	A (in)	B (in)	C (in)	D (in)	E (in)	F (in)	G (in)	H (in)
V...Is-100	14 ⁴⁹ / ₆₄	21 ¹⁷ / ₆₄	26 ³⁹ / ₆₄	50 ¹³ / ₆₄	65 ¹⁵ / ₁₆	5 ⁵ / ₁₆	11 ¹⁹ / ₆₄	24 ¹ / ₄
V...Is-150	14 ⁴⁹ / ₆₄	21 ¹⁷ / ₆₄	26 ³⁹ / ₆₄	50 ¹³ / ₆₄	65 ¹⁵ / ₁₆	5 ⁵ / ₁₆	11 ¹³ / ₁₆	24 ¹ / ₄
V...Is-200	14 ⁴⁹ / ₆₄	21 ¹⁷ / ₆₄	26 ³⁹ / ₆₄	50 ¹³ / ₆₄	65 ¹⁵ / ₁₆	5 ⁵ / ₁₆	13 ²⁵ / ₆₄	24 ¹ / ₄
V...Is-250-300	16 ⁹ / ₆₄	24 ⁷ / ₃₂	28 ³ / ₁₆	52 ⁹ / ₁₆	68 ⁵ / ₁₆	5 ⁵ / ₁₆	13 ²⁵ / ₆₄	26 ¹⁷ / ₆₄
V...Is-350	17 ¹³ / ₃₂	24 ⁵⁹ / ₆₄	32 ²⁹ / ₃₂	56 ¹³ / ₁₆	72 ⁹ / ₁₆	5 ⁵ / ₁₆	14 ¹¹ / ₆₄	30 ⁵ / ₁₆
V...Is-400	17 ¹³ / ₃₂	31 ⁷ / ₃₂	32 ²⁹ / ₃₂	56 ¹³ / ₁₆	72 ⁹ / ₁₆	5 ⁵ / ₁₆	14 ¹¹ / ₆₄	30 ⁵ / ₁₆
V...Is-450-500	17 ¹³ / ₃₂	31 ⁷ / ₃₂	32 ²⁹ / ₃₂	56 ¹³ / ₁₆	72 ⁹ / ₁₆	5 ⁵ / ₁₆	14 ⁶¹ / ₆₄	30 ⁵ / ₁₆
V...Is-600	22 ³ / ₆₄	33 ⁴⁷ / ₆₄	37 ⁴¹ / ₆₄	60 ¹⁵ / ₆₄	65 ¹⁵ / ₁₆	5 ⁵ / ₁₆	14 ⁶¹ / ₆₄	35 ³ / ₆₄
V...Is-700	22 ³ / ₆₄	33 ⁴⁷ / ₆₄	37 ⁴¹ / ₆₄	60 ¹⁵ / ₆₄	65 ¹⁵ / ₁₆	5 ⁵ / ₁₆	16 ⁹ / ₆₄	35 ³ / ₆₄
V...Is-800	22 ³ / ₆₄	36 ²⁹ / ₆₄	37 ⁴¹ / ₆₄	60 ¹⁵ / ₆₄	65 ¹⁵ / ₁₆	5 ⁵ / ₁₆	16 ⁹ / ₆₄	35 ³ / ₆₄
V...Is-1000	24 ⁵⁹ / ₆₄	37 ²¹ / ₆₄	39 ³⁹ / ₆₄	68 ¹ / ₂	84 ¹ / ₄	7 ⁹ / ₃₂	16 ¹⁷ / ₃₂	38 ³⁷ / ₆₄
V...Is-1250	24 ⁵⁹ / ₆₄	37 ²¹ / ₆₄	39 ³⁹ / ₆₄	68 ¹ / ₂	84 ¹ / ₄	7 ⁹ / ₃₂	17 ³³ / ₆₄	38 ³⁷ / ₆₄

Burner type	I (in)	J (in)	K (in)	L (in)	M (DN/ANSI)	N (Ø in)	O* (in)	Weight (lbs)
V...Is-100	30 ²⁵ / ₃₂	33 ²¹ / ₃₂	16 ¹⁷ / ₃₂	15 ³ / ₄	50	7 ²⁹ / ₃₂	78 ⁴⁷ / ₆₄	452
V...Is-150	30 ²⁵ / ₃₂	33 ²¹ / ₃₂	16 ¹⁷ / ₃₂	15 ³ / ₄	50	9 ³ / ₃₂	78 ⁴⁷ / ₆₄	474
V...Is-200	30 ²⁵ / ₃₂	33 ²¹ / ₃₂	16 ¹⁷ / ₃₂	15 ³ / ₄	65/80	10 ³³ / ₆₄	78 ⁴⁷ / ₆₄	507
V...Is-250-300	33 ⁴⁷ / ₆₄	36 ¹ / ₃₂	16 ¹⁷ / ₃₂	15 ³ / ₄	65/80	10 ³³ / ₆₄	78 ⁴⁷ / ₆₄	661,4
V...Is-350	39 ⁴¹ / ₆₄	40 ⁹ / ₃₂	16 ¹⁷ / ₃₂	15 ³ / ₄	65/80	12 ³ / ₆₄	78 ⁴⁷ / ₆₄	683,4
V...Is-400	39 ⁴¹ / ₆₄	40 ⁹ / ₃₂	16 ¹⁷ / ₃₂	15 ³ / ₄	65/80	12 ³ / ₆₄	78 ⁴⁷ / ₆₄	925,9
V...Is-450-500	39 ⁴¹ / ₆₄	40 ⁹ / ₃₂	16 ¹⁷ / ₃₂	15 ³ / ₄	65/80	13 ¹³ / ₁₆	78 ⁴⁷ / ₆₄	937
V...Is-600	45 ¹⁵ / ₁₆	43 ⁴⁵ / ₆₄	16 ¹⁷ / ₃₂	15 ³ / ₄	65/80	13 ¹³ / ₁₆	78 ⁴⁷ / ₆₄	1124,4
V...Is-700	45 ¹⁵ / ₁₆	43 ⁴⁵ / ₆₄	16 ¹⁷ / ₃₂	15 ³ / ₄	65/80	15 ⁶³ / ₆₄	78 ⁴⁷ / ₆₄	1256,6
V...Is-800	45 ¹⁵ / ₁₆	43 ⁴⁵ / ₆₄	16 ¹⁷ / ₃₂	15 ³ / ₄	65/80	15 ⁶³ / ₆₄	78 ⁴⁷ / ₆₄	1891,6
V...Is-1000	49 ³¹ / ₆₄	50	18 ¹ / ₂	15 ³ / ₄	100	17 ⁶¹ / ₆₄	78 ⁴⁷ / ₆₄	1642,4
V...Is-1250	49 ³¹ / ₆₄	50	18 ¹ / ₂	15 ³ / ₄	100	19 ⁵⁹ / ₆₄	78 ⁴⁷ / ₆₄	1907

*O (in) is the required minimal free distance around the burner in all directions.

3.10.3 Seaworthy packaging

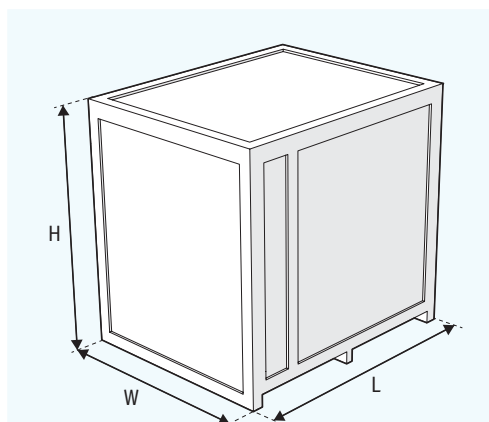

Burner type	L (in)*	W (in)*	H (in)*
VG(0)Is-100-500	85 ³ / ₆₄	63 ²⁵ / ₆₄	62 ⁶³ / ₆₄
VG(0)Is-600-1250	85 ³ / ₆₄	81 ⁷ / ₆₄	62 ⁶³ / ₆₄
Vitopack configuration	t.b.d.	t.b.d.	t.b.d.

*Actual sizes may vary.

NOTICE

When optional features are included in the burner system (e.g. Vitopack, high pressure gas regulator set), the packaging is put together specifically for this project.

3.11 Performance data

This section contains the standard performance data of a MONO-block burner in imperial units.

For technical data regarding your specific burner system configuration, please refer to the burner plate (see §3.9) or the order confirmation. For performance data in metric units, please refer to Appendix C of this manual.

3.11.1 MONO-block low NOx gas burner

	Boiler capacity (n=93%)	Burner input	Control	Gas pressure	Max. boiler backpressure	Motor / drive power	Turn down	Consumption	Max. height
Type	HP	MMBTU	Gas	PSI	"wc	HP	Gas	Gas (ft ³)	ft
VGIs-100	119	4	Modulating	1,45-4,35	4,0	3,0	1:5	5015	1640
VGIs-150	178	6	Modulating	1,45-4,35	4,0	5,4	1:5	7522	1640
VGIs-200	237	9	Modulating	1,45-4,35	4,0	5,4	1:5	10029	1640
VGIs-250	296	11	Modulating	1,45-4,35	4,0	7,5	1:5	12537	1640
VGIs-300	356	13	Modulating	1,45-4,35	4,8	10,2	1:6	15044	1640
VGIs-350	415	15	Modulating	1,45-4,35	4,8	10,2	1:6	17198	1640
VGIs-400	474	17	Modulating	1,45-4,35	4,8	15,0	1:6	20059	1640
VGIs-450	534	19	Modulating	1,45-4,35	4,8	15,0	1:6	22566	1640
VGIs-500	593	21	Modulating	1,45-4,35	4,8	20,4	1:7	25073	1640
VGIs-600	711	26	Modulating	1,45-4,35	5,2	25,2	1:7	30088	1640
VGIs-700	830	30	Modulating	2,90-4,35	5,6	29,9	1:8	35103	1640
VGIs-800	948	34	Modulating	4,35	6,0	40,8	1:8	40117	1640
VGIs-1000	1186	43	Modulating	4,35	6,8	50,4	1:10	50147	1640
VGIs-1250	1423	51	Modulating	4,35	6,8	61,2	1:10	60176	1640

3.11.2 MONO-block low NOx gas & emergency back-up oil burner

Type	Boiler capacity (n=93%)	Burner input	Control		Gas pressure	Max. boiler backpressure	Motor / drive power	Turn down		Con- sumption	Max. height
	HP	MMBTU	Gas	Oil	PSI	"wc	HP	Gas	Oil	Gas (ft ³)	ft
V(G)OIs-100	119	4	Modulating	2-stage	1,45-4,35	4,0	3,0	1:5	1:2	5015	1640
V(G)OIs-150	178	6	Modulating	2-stage	1,45-4,35	4,0	5,4	1:5	1:2	7522	1640
V(G)OIs-200	237	9	Modulating	2-stage	1,45-4,35	4,0	5,4	1:5	1:2	10029	1640
V(G)OIs-250	296	11	Modulating	2-stage	1,45-4,35	4,0	7,5	1:5	1:2	12537	1640
V(G)OIs-300	356	13	Modulating	2-stage	1,45-4,35	4,8	10,2	1:6	1:2	15044	1640
V(G)OIs-350	415	15	Modulating	2-stage	1,45-4,35	4,8	10,2	1:6	1:2	17198	1640
V(G)OIs-400	474	17	Modulating	2-stage	1,45-4,35	4,8	15,0	1:6	1:2	20059	1640
V(G)OIs-450	534	19	Modulating	2-stage	1,45-4,35	4,8	15,0	1:6	1:2	22566	1640
V(G)OIs-500	593	21	Modulating	2-stage	1,45-4,35	4,8	20,4	1:7	1:2	25073	1640
V(G)OIs-600	711	26	Modulating	2-stage	1,45-4,35	5,2	25,2	1:7	1:2	30088	1640
V(G)OIs-700	830	30	Modulating	2-stage	2,90-4,35	5,6	29,9	1:8	1:2	35103	1640
V(G)OIs-800	948	34	Modulating	2-stage	4,35	6,0	40,8	1:8	1:2	40117	1640
V(G)OIs-1000	1186	43	Modulating	2-stage	4,35	6,8	50,4	1:10	1:2	50147	1640
V(G)OIs-1250	1423	51	Modulating	2-stage	4,35	6,8	61,2	1:10	1:2	60176	1640

3.11.3 MONO-block low NOx gas & long term oil dual fuel burner

Type	Boiler capacity (n=93%)	Burner input	Control		Gas pressure	Max. boiler backpressure	Motor / drive power	Turn down		Con- sumption	Max. height
	HP	MMBTU	Gas	Oil	PSI	"wc	HP	Gas	Oil	Gas (ft ³)	ft
V(G)OIs-100	119	4	Modulating		1,45-4,35	4,0	3,0	1:5	1:5	5015	1640
V(G)OIs-150	178	6	Modulating		1,45-4,35	4,0	5,4	1:5	1:5	7522	1640
V(G)OIs-200	237	9	Modulating		1,45-4,35	4,0	5,4	1:5	1:5	10029	1640
V(G)OIs-250	296	11	Modulating		1,45-4,35	4,0	7,5	1:5	1:5	12537	1640
V(G)OIs-300	356	13	Modulating		1,45-4,35	4,8	10,2	1:6	1:5	15044	1640
V(G)OIs-350	415	15	Modulating		1,45-4,35	4,8	10,2	1:6	1:5	17198	1640
V(G)OIs-400	474	17	Modulating		1,45-4,35	4,8	15,0	1:6	1:5	20059	1640
V(G)OIs-450	534	19	Modulating		1,45-4,35	4,8	15,0	1:6	1:5	22566	1640
V(G)OIs-500	593	21	Modulating		1,45-4,35	4,8	20,4	1:7	1:5	25073	1640
V(G)OIs-600	711	26	Modulating		1,45-4,35	5,2	25,2	1:7	1:5	30088	1640
V(G)OIs-700	830	30	Modulating		2,90-4,35	5,6	29,9	1:8	1:5	35103	1640
V(G)OIs-800	948	34	Modulating		4,35	6,0	40,8	1:8	1:5	40117	1640
V(G)OIs-1000	1186	43	Modulating		4,35	6,8	50,4	1:10	1:5	50147	1640
V(G)OIs-1250	1423	51	Modulating		4,35	6,8	61,2	1:10	1:5	60176	1640



4 Installation

This chapter provides instructions for the basic installation of a burner system onto a boiler or other heating appliance. For information about custom set-ups, please contact Vitotherm.

⚠ CAUTION The burner system may only be installed by qualified personnel. Handling the burner unit and supporting components without the required knowledge and experience may damage the burner system or cause hazardous situations during installation and use.

⚠ WARNING The burner system may only be installed in a sufficiently ventilated boiler house.

NOTICE The burner system must always be installed according to national and local laws and regulations.

NOTICE The components shown in this chapter may differ from your specific burner system configuration.

4.1 Checking the delivery

Required tools:

- Forklift truck with adequate lifting capacity.

To check the delivery:

1. Transport the crate(s) to an accessible place near the boiler.
2. Remove the lid of the crate(s).
3. Remove the sides of the crate(s).
4. Remove the lashing straps and packaging materials.
5. Remove any screws that connect parts to the bottom of the crate(s).
6. Check if all parts have been delivered according to the agreed scope.
If a part is missing, contact Vitotherm immediately.
7. Check all delivered parts for damage.

⚠ WARNING Damaged parts can affect the correct and safe functioning of the burner system.

- ▶ Do not install damaged parts.
 - ▶ If any parts are damaged upon delivery, please contact Vitotherm.
-

8. Check if the minimum and maximum load of the burner is within the operating range of the boiler. The load values are found on the burner plate of the burner.
9. Check if the delivered burner will fit in the designated area of the room. For the dimensions of the burner, see §3.10.

4.2 Installing the combustor

Provided tools

- Nuts and bolts ($\frac{3}{4}$ " or $\frac{15}{16}$ ")
- Gaskets

Required tools

- Mobile crane with adequate lifting capacity.
- Suitable hoisting sling.
- Ring wrench ($\frac{3}{4}$ " or $\frac{15}{16}$ ") or adjustable spanners

To install the combustor:

1. Collect the bag with fastener materials that is taped to the combustor.
2. Attach a hoisting sling around the combustor pipe section between the connection plates.

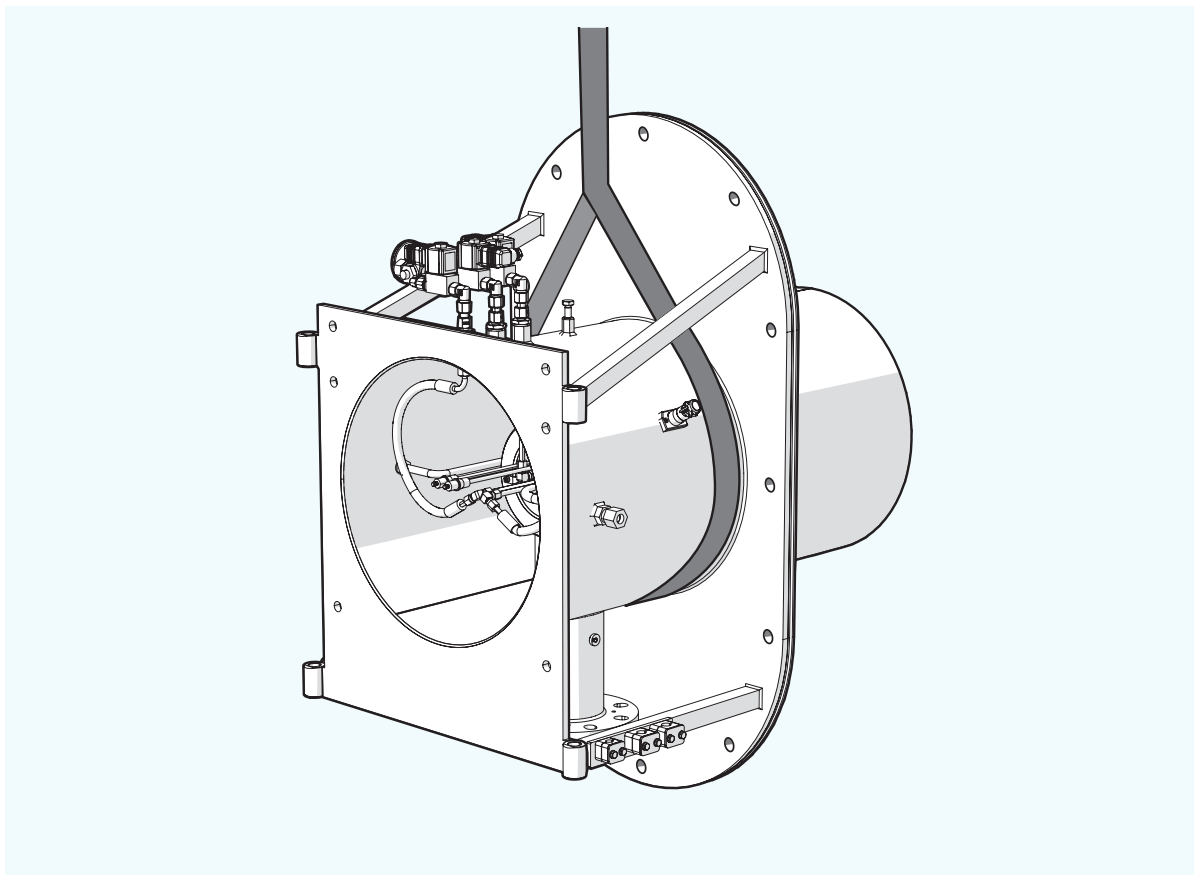

⚠ WARNING

Slings might shift due to hoisting movements, causing unforeseen movement or toppling of the combustor.

- ▶ Make sure that the sling is trapped in the combustor construction and cannot slide off.
- ▶ Do not attach slings to the open front section of the combustor, where the sling might slide off, or to the reinforcement bars.

3. Carefully lift the combustor.
4. Place the silicon gasket.
5. Carefully place the combustor into the boiler entrance.

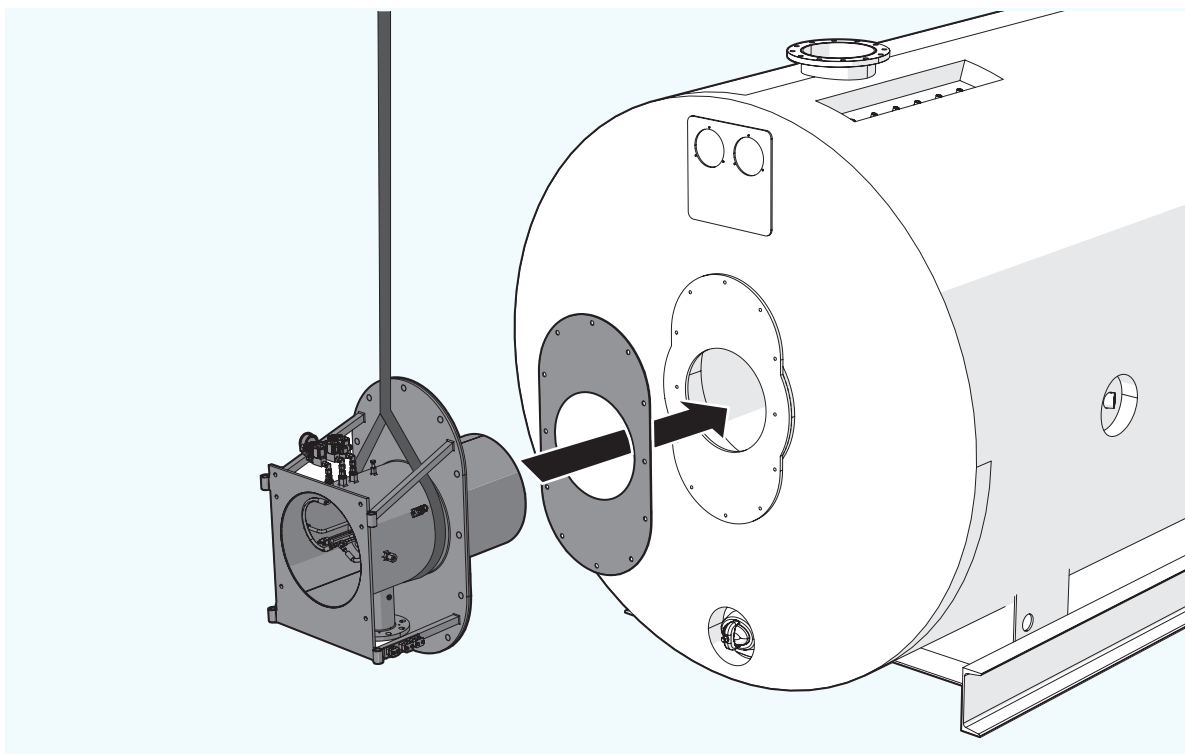

6. Place the provided bolts and loosely tighten them. Use the provided nuts if the flange holes of the boiler are not threaded.

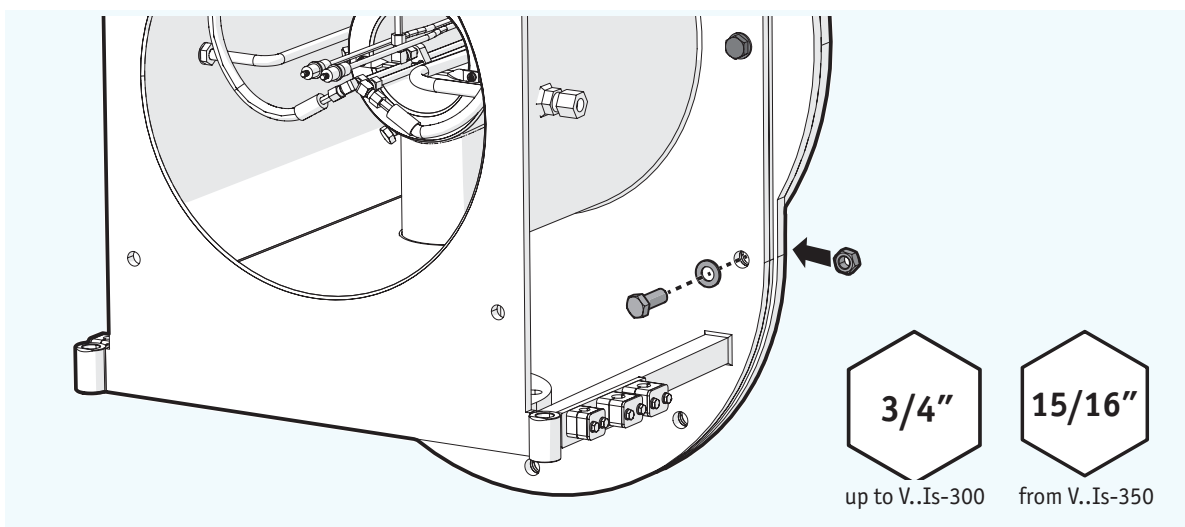

7. Level the combustor.

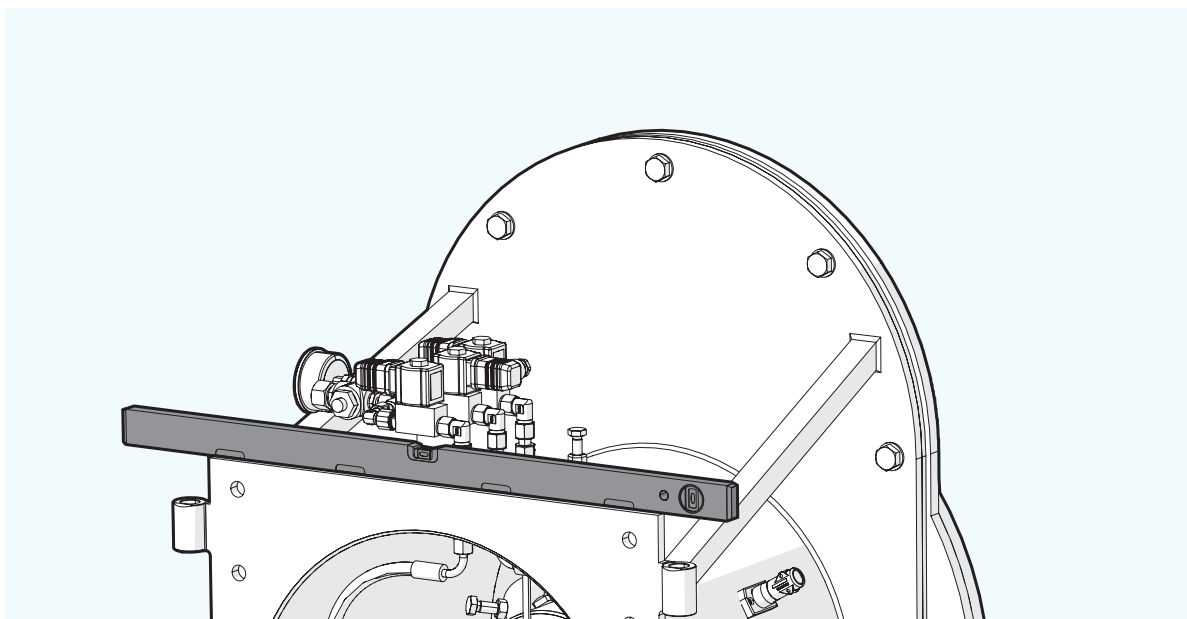

8. Tighten the bolts. Work in a crosswise pattern to make sure the gasket is compressed evenly.

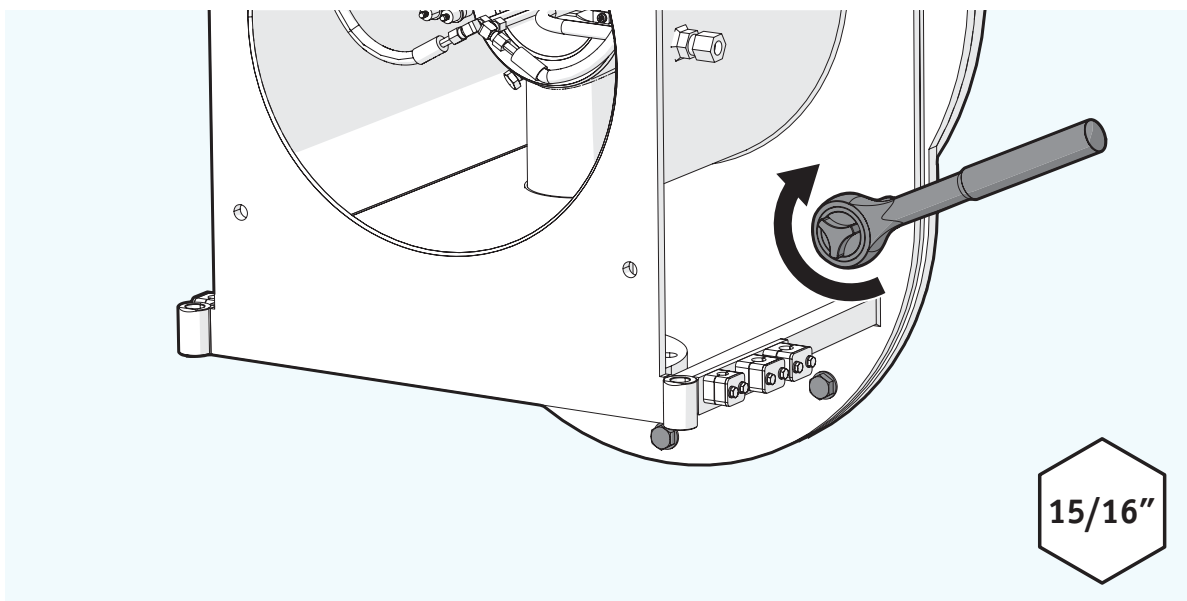

9. Remove the hoisting sling.



10. Inside the boiler, fill the ring-shaped gap between the combustor pipe and the chamber front head with refractory bricks.

NOTICE

Make sure that the refractory does not protrude the end of the combustor pipe. Keep the refractory at a distance of 4" inwards.

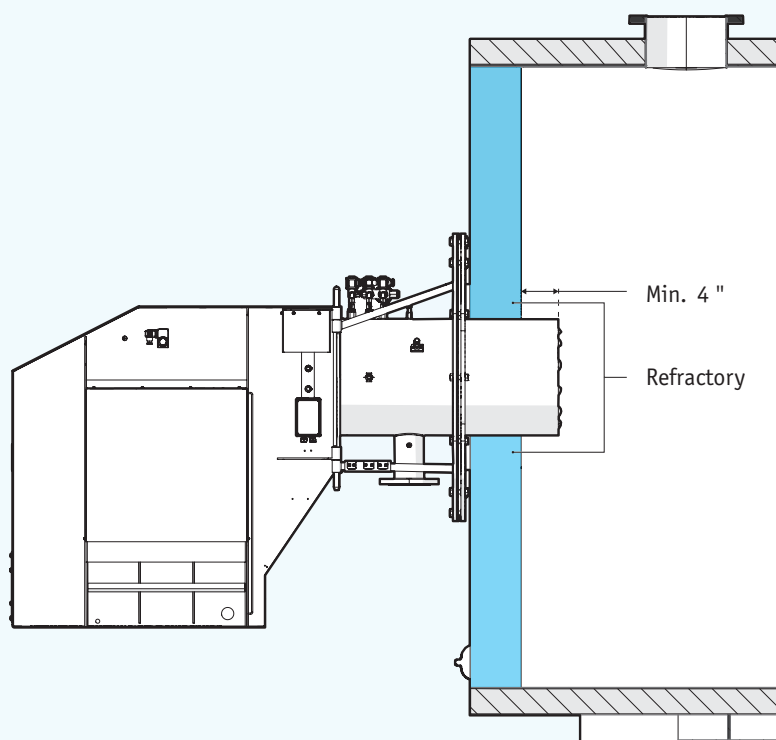
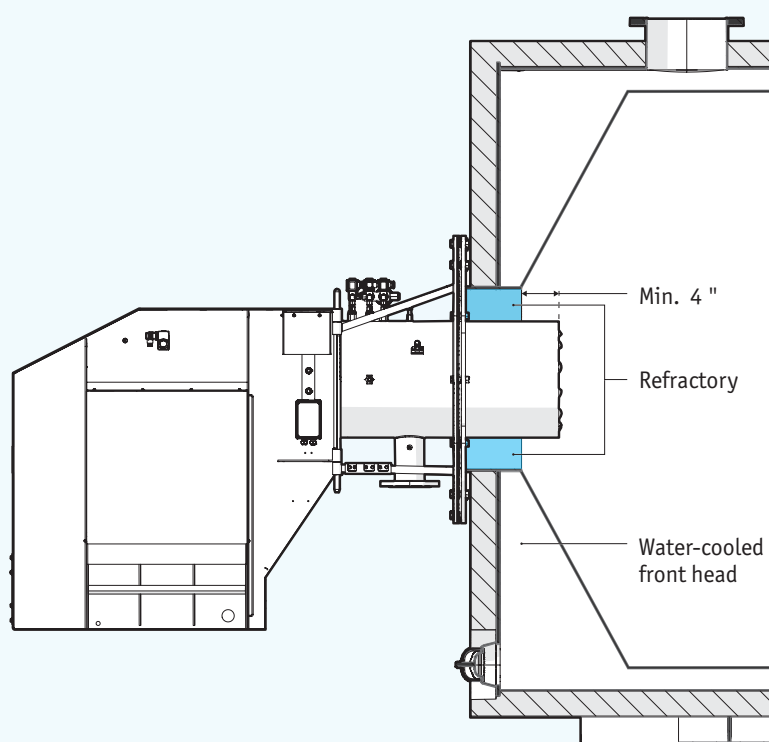

4.3 Installing the fan housing

Required tools

- Mobile crane with adequate lifting capacity
- Ring wrench ($\frac{3}{4}$ ") or adjustable spanners
- Suitable hoisting equipment:
 - D-shackles
 - Round sling

To install the fan housing:

1. Remove the hinge pin, the locking pin and the bolts.

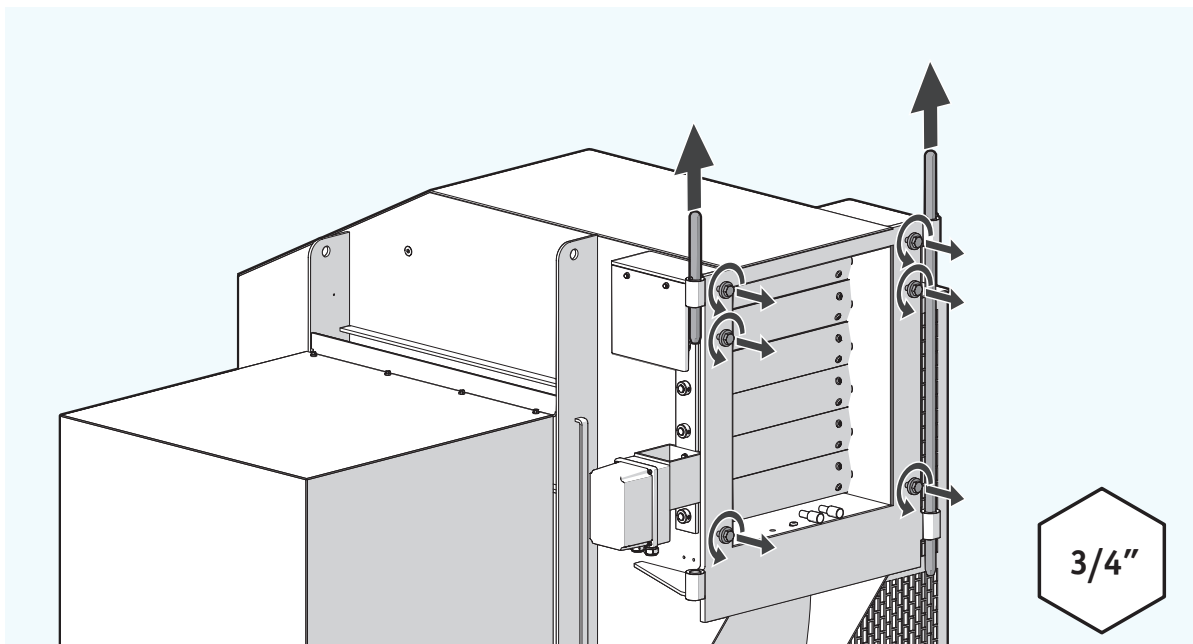

2. Connect your hoisting equipment to the hoisting eyes.

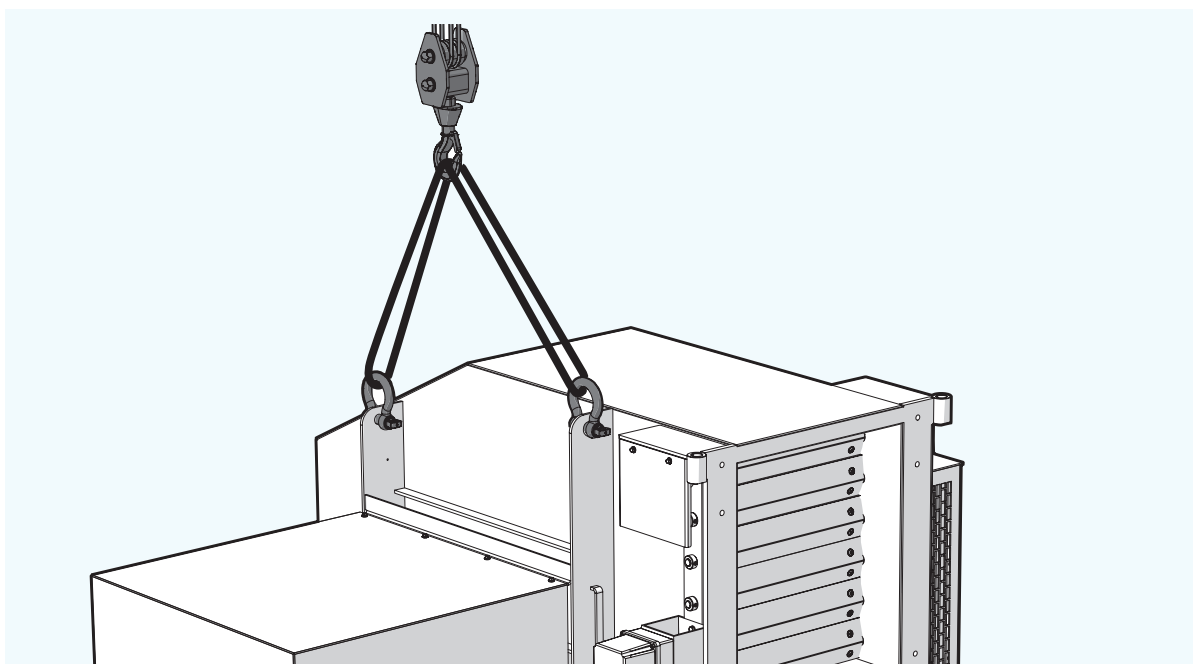

3. Carefully lift the fan housing close to the boiler.

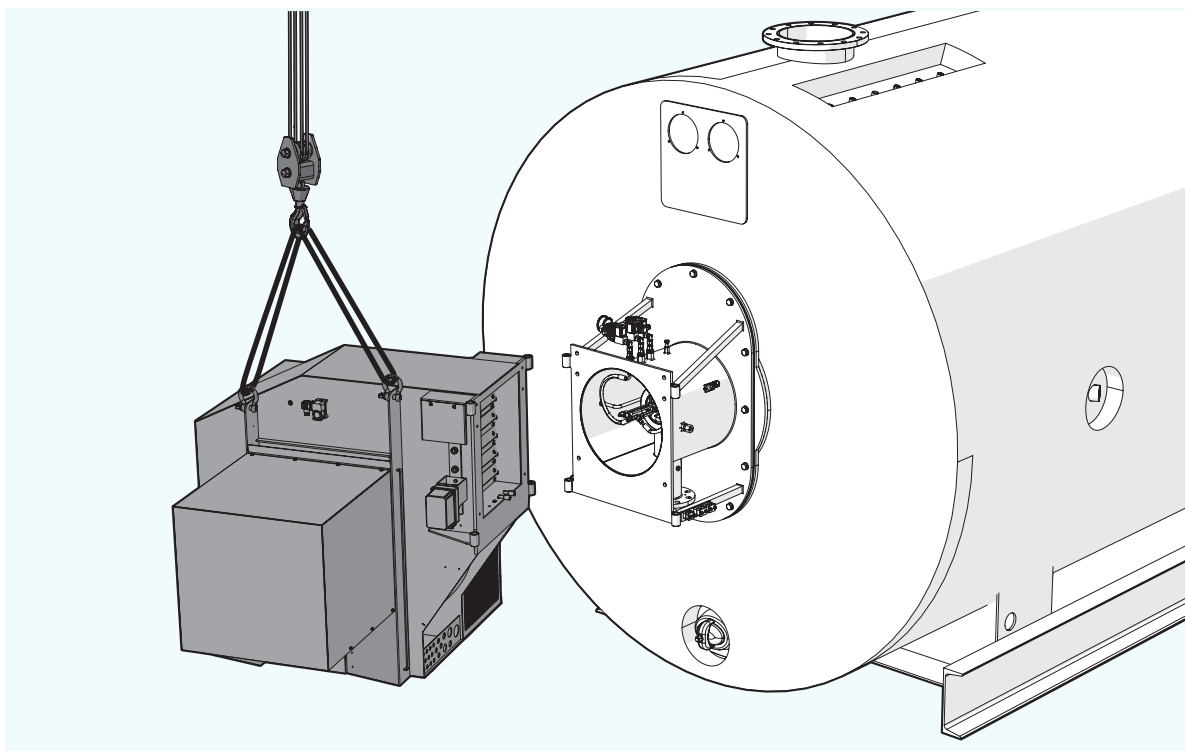

4. Check the designated hinge position (left or right hand) of the fan housing (see the installation overview).
5. Carefully align the fan housing pivot holes with the pivot holes of the combustor.

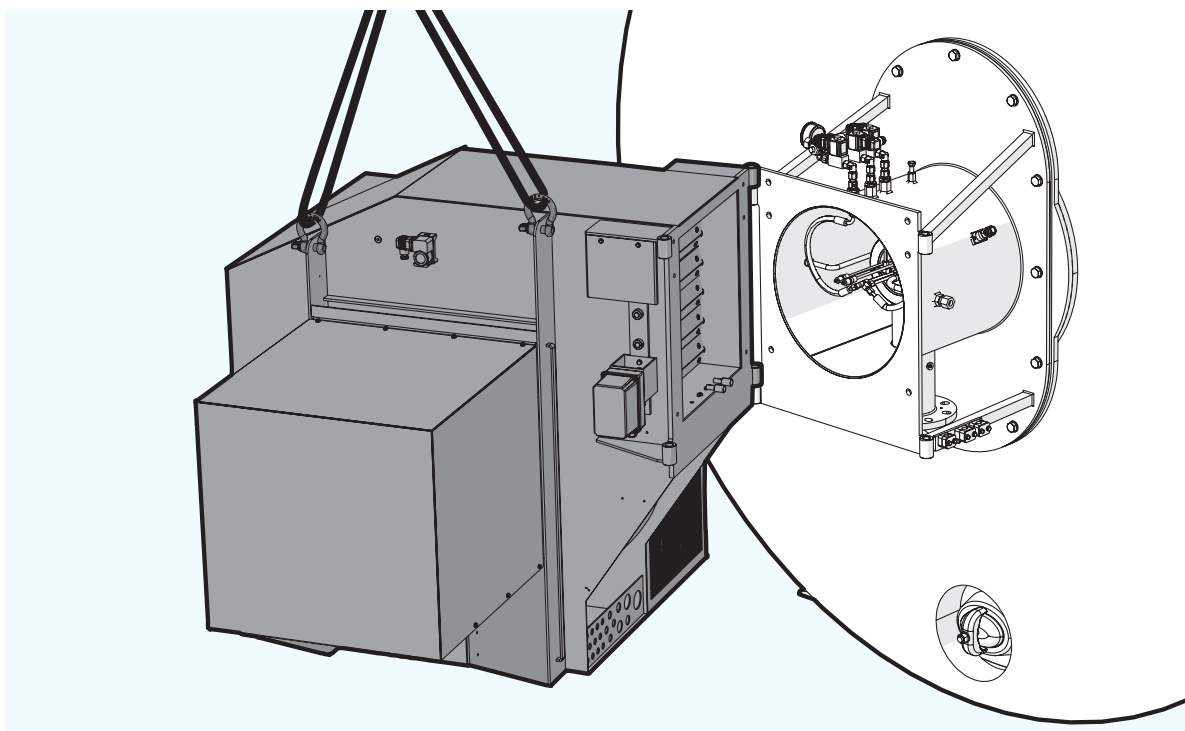

6. Insert the hinge pin through both pivot holes until the locking pin rests on the top of the combustor.

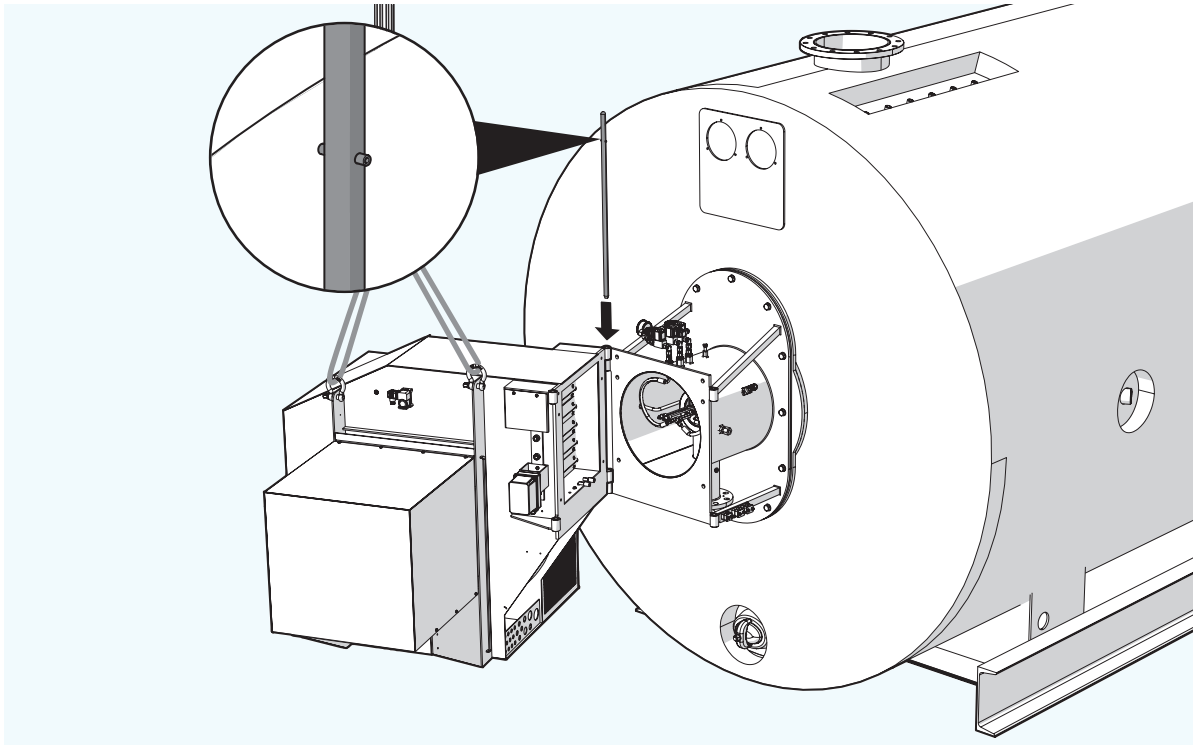

7. Connect the ignition cables of the combustor to the fan housing.
8. Remove the hoisting cables.
9. Close the fan housing.

NOTICE Make sure the ignition cable is not trapped between the combustor and the fan housing.

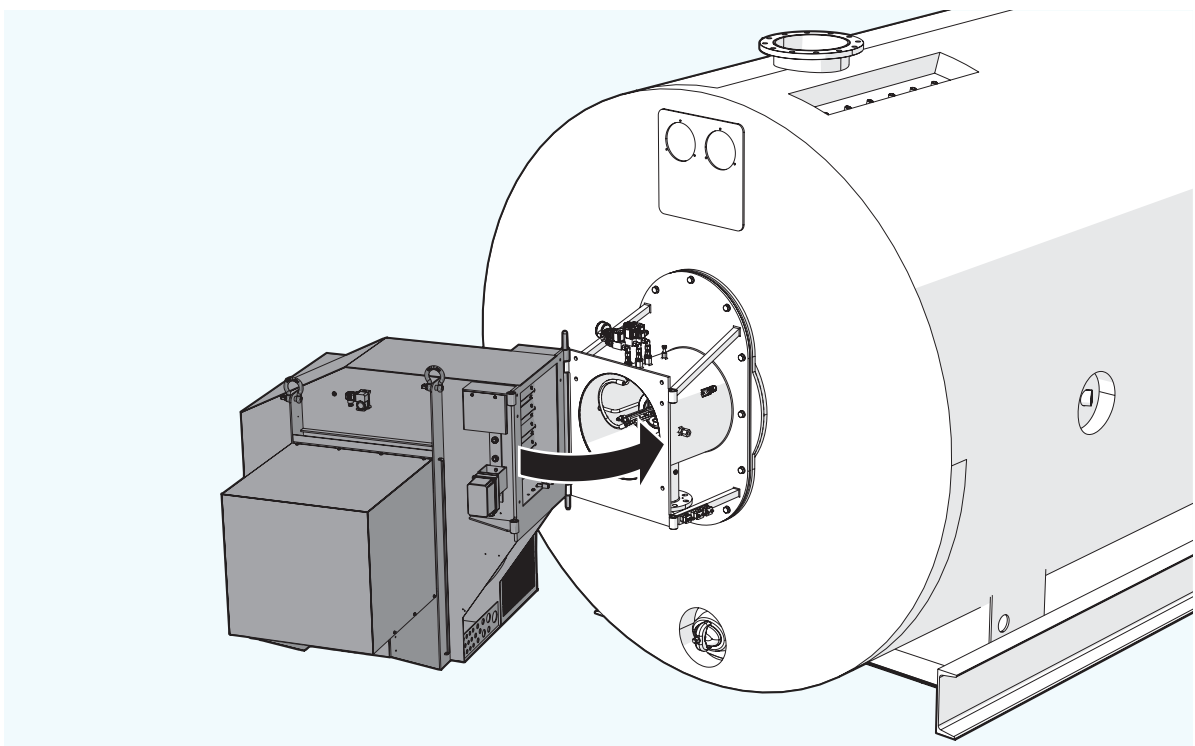

10. Place and loosely tighten the bolts.

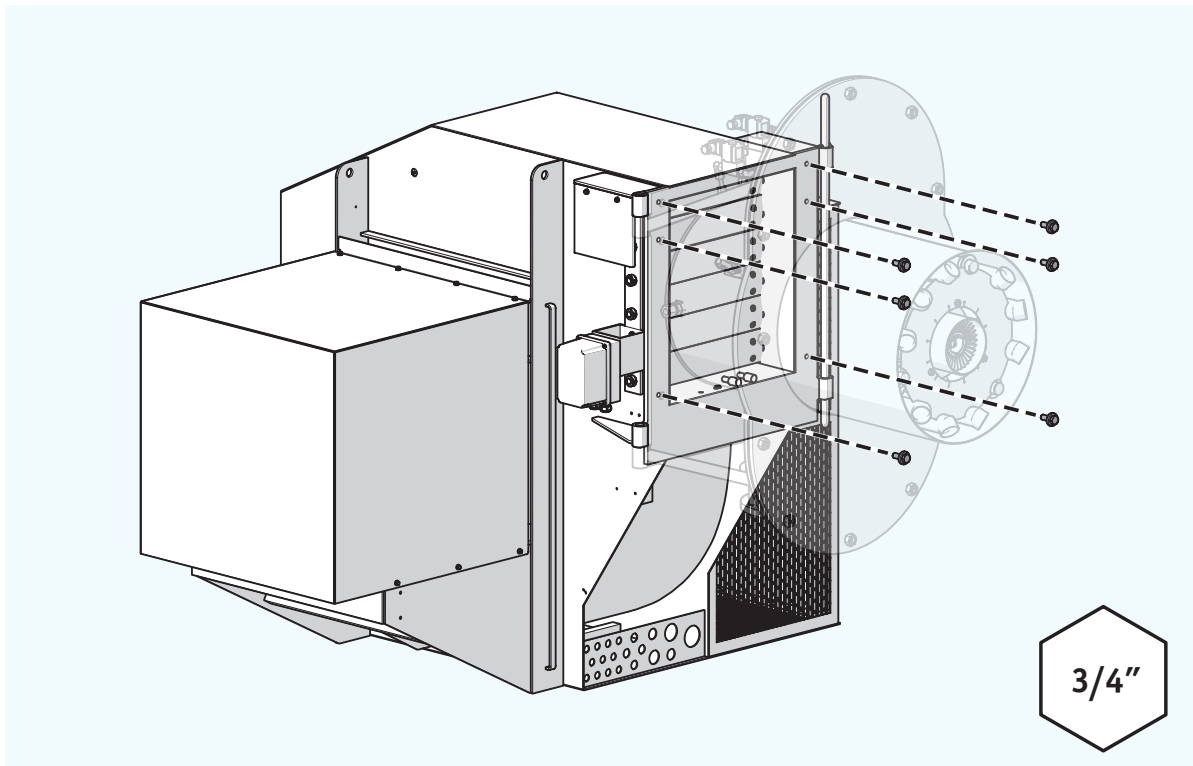

11. Carefully tighten the bolts more until the pivot holes of both the fan housing and the combustor are aligned.
12. Insert the locking pin.

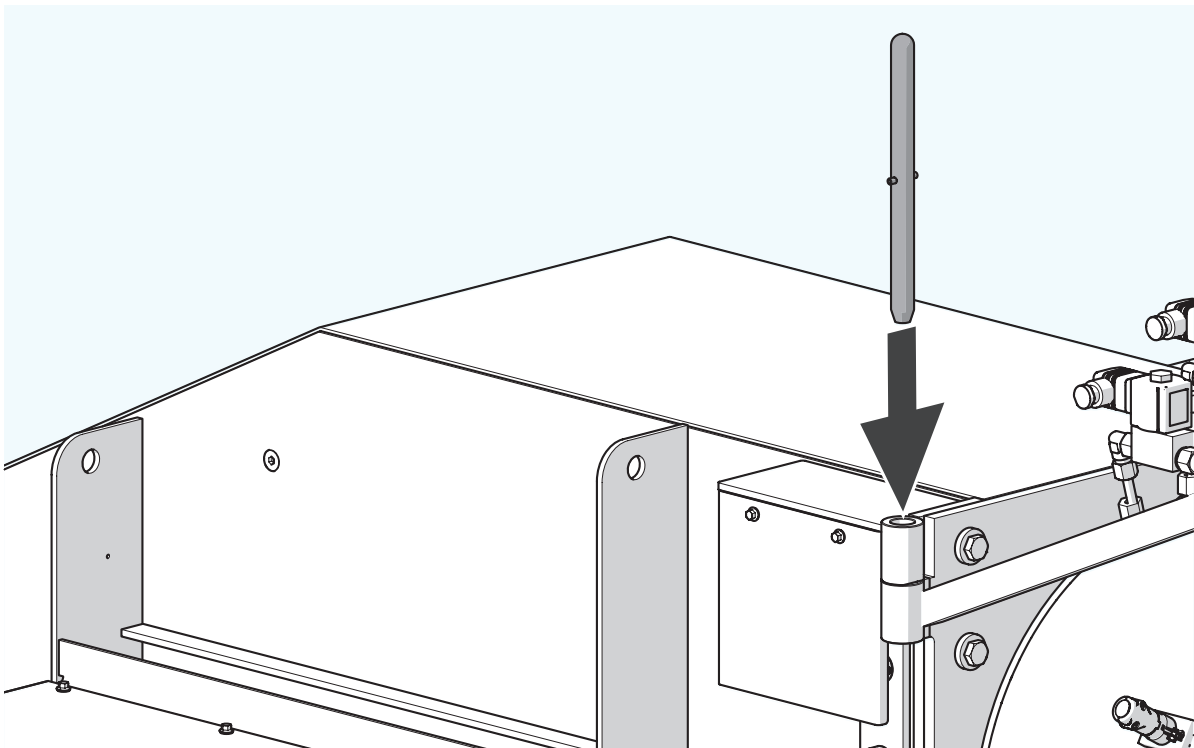

4.4 Installing the boiler thermostat set

The components of the boiler thermostat are installed directly onto the boiler.

To install the boiler thermostat set:

1. Connect cabling to each of the components.
2. Insert the components into the connection points of the boiler.

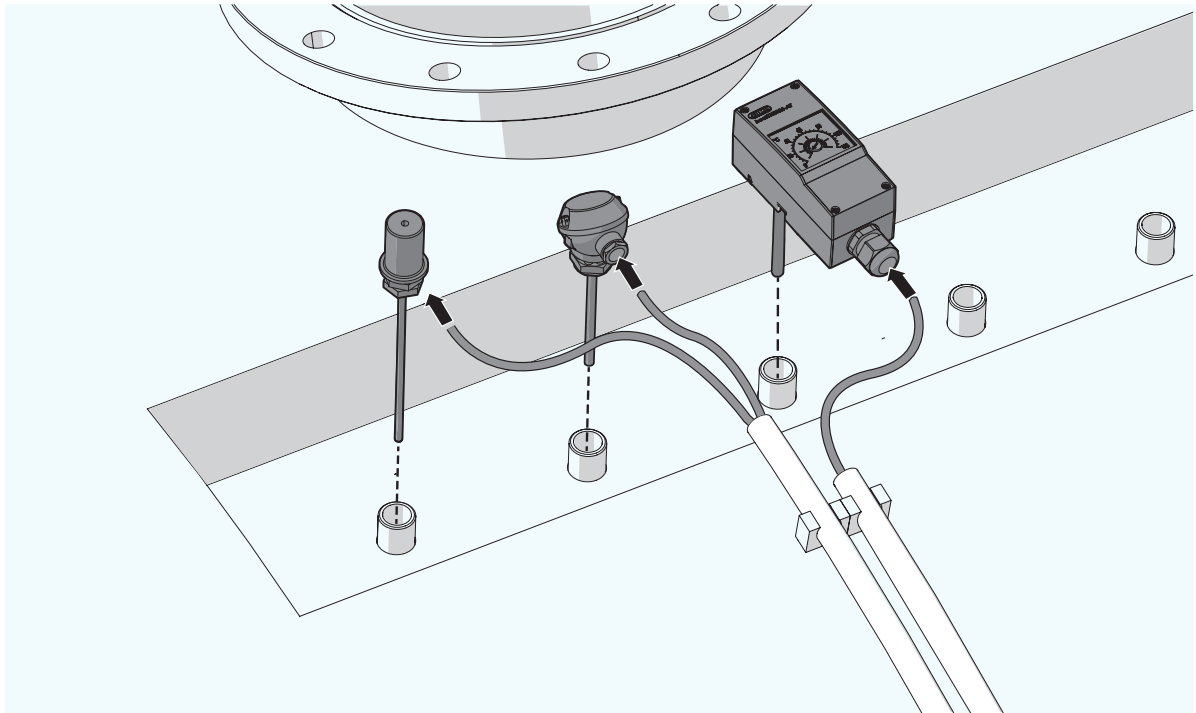

3. Connect the cabling to a junction box. For more information, please refer to the electrical wiring diagram.



For more information, please refer to the OEM manual of each component.

4.5 Electrical connections

All electric cabling is pre-wired to a junction box in the control panel. During installation, this cabling must be connected to the following components:

- Junction box in the fan housing (see §3.1)
- Boiler thermostat set (see §4.5)
- Junction box on the gas train (see §3.3)

NOTICE

For all electrical connections, the applicable local standards and the connection requirements must be taken into account.



For more information about the electrical connections and integrated circuits, please refer to the electrical wiring diagram.

4.6 Installing the gas line adapter

Optional

The gas line adapter can be installed to connect the gas train to the burner.

Provided tools

- Nuts and bolts ($\frac{15}{16}$ ")
- Gaskets

Required tools

- Ringwrench ($\frac{15}{16}$ ") or adjustable spanners

To install the gas line adapter:

1. Place a gasket and connect one end of the gas line adapter to the double valve block of the gas train.

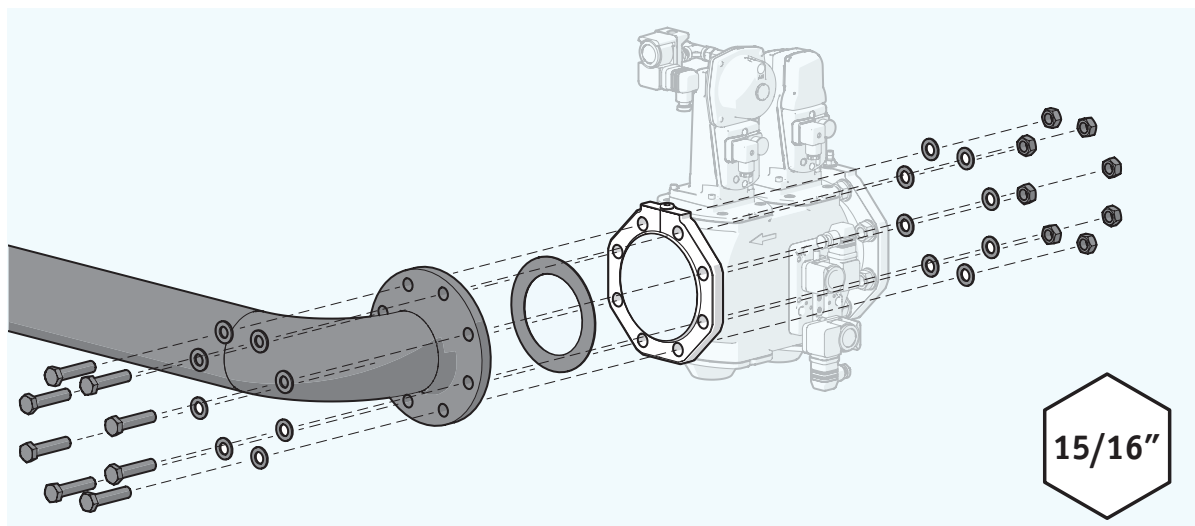

2. If necessary, adjust the height and location of the gas train to align the gas line adapter with the gas inlet on the combustor.

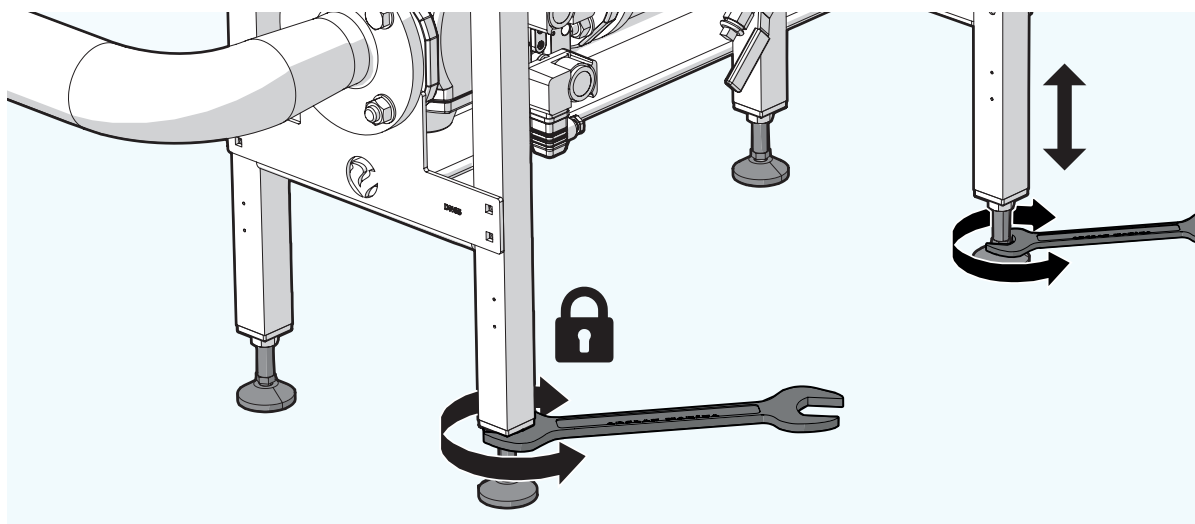

3. Disassemble the flange on the gas inlet of the combustor.
4. Place two gaskets and connect the other end of the gas line adapter to the combustor.

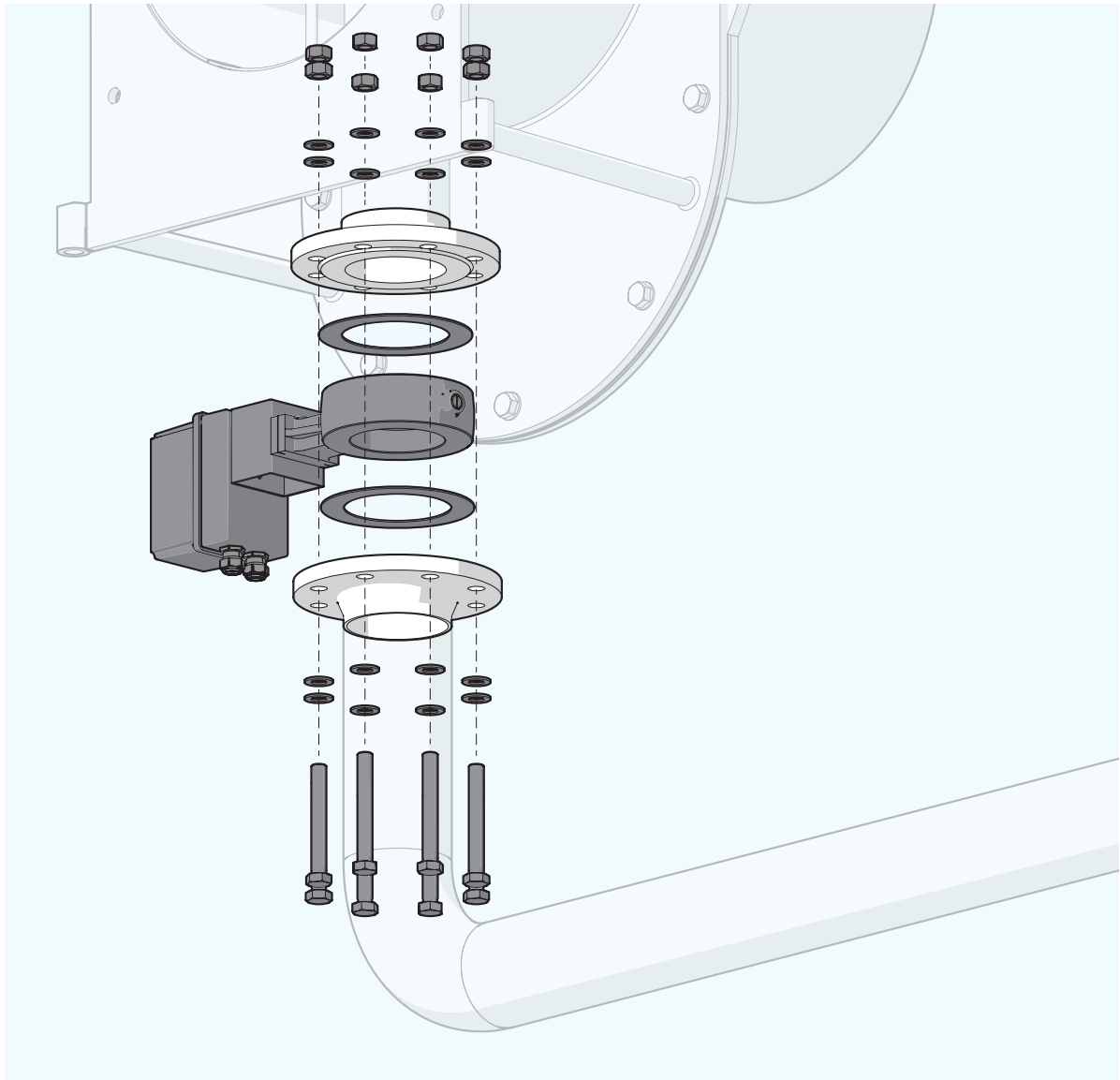

4.7 Installing the Vitopack

Optional

Provided tools

- Nuts and bolts ($\frac{15}{16}$ ")
- Gaskets
- Gas line ($\frac{19}{32}$ ") and connector pieces

Required tools

- Mobile crane with adequate lifting capacity.
- Suitable hoisting equipment:
 - D-shackles
 - Round sling
- Ringwrench ($\frac{15}{16}$ ") or adjustable spanners

To install the Vitopack:

1. Attach hoisting cables to the hoisting rings on top of the frame.

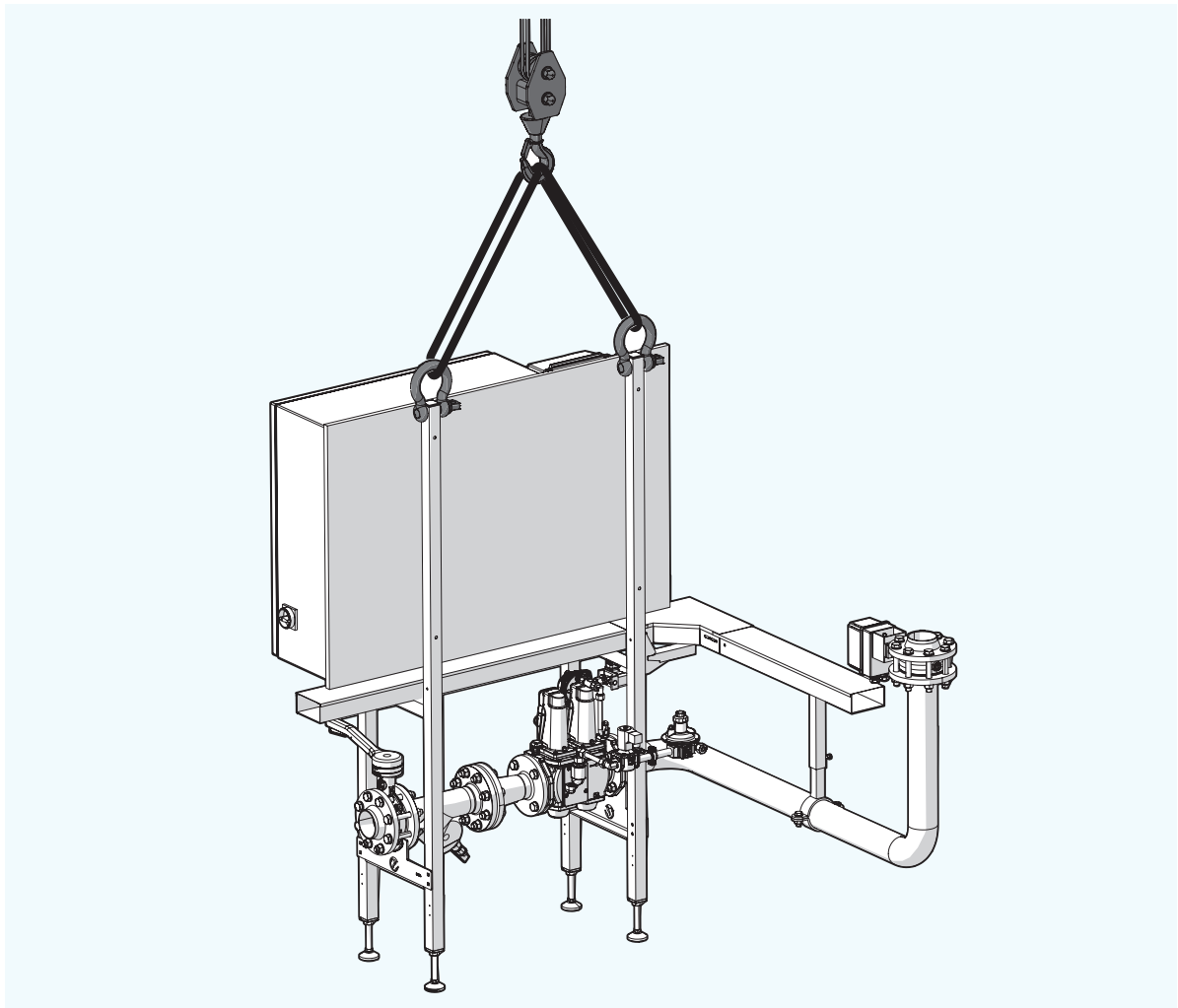

2. Carefully lift the Vitopack.

3. Place the Vitopack at the designated location, on either side of the boiler.

NOTICE

Make sure the gas line adapter aligns with the gas inlet on the combustor.

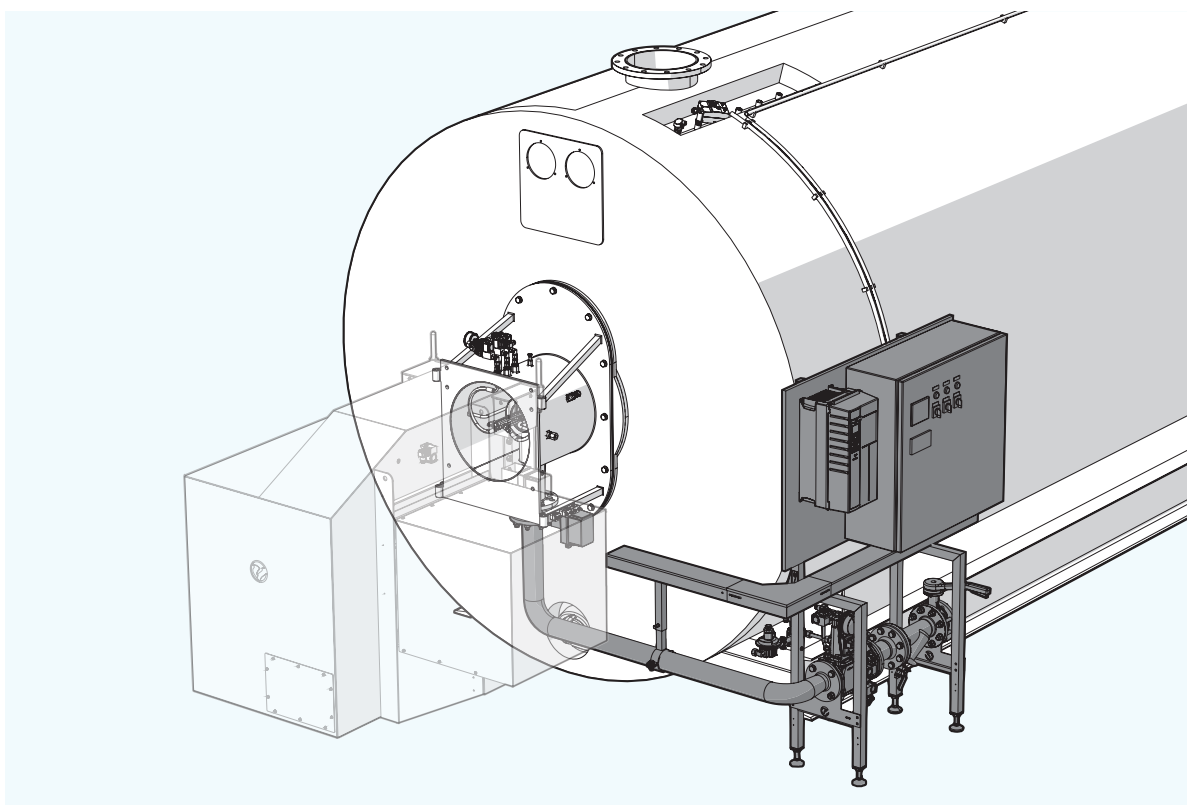

4. Level the Vitopack by adjusting the feet.

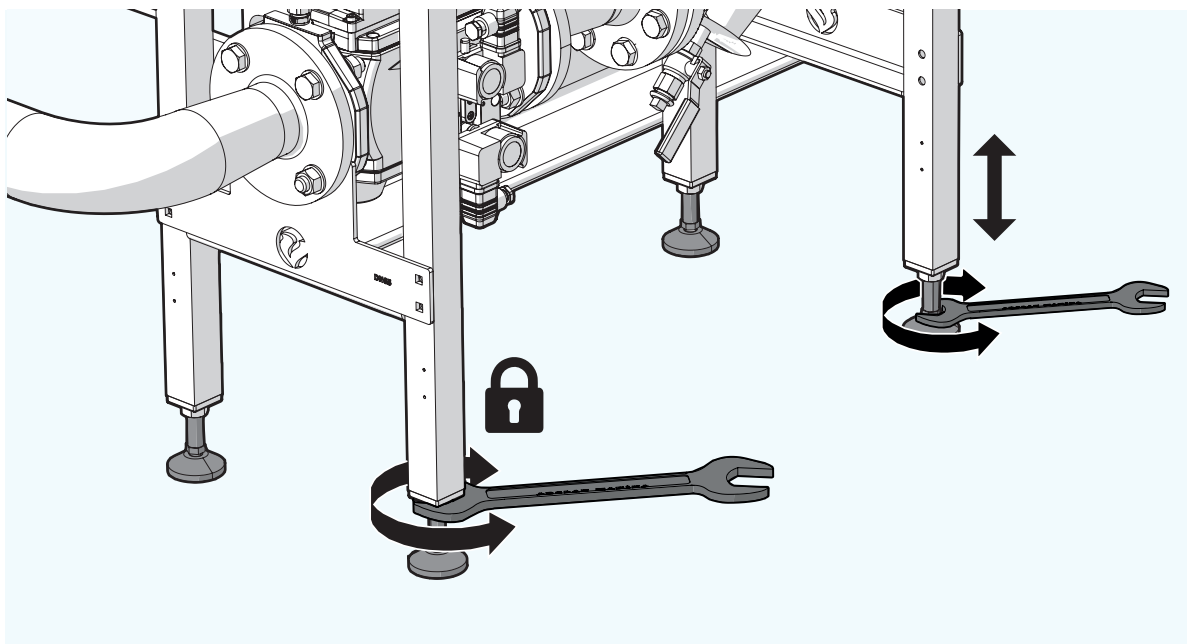

5. Remove the placeholder flange from the end of the gas line adapter.
6. Connect the gas line adapter to the gas inlet of the combustor. Place gaskets between this connection.

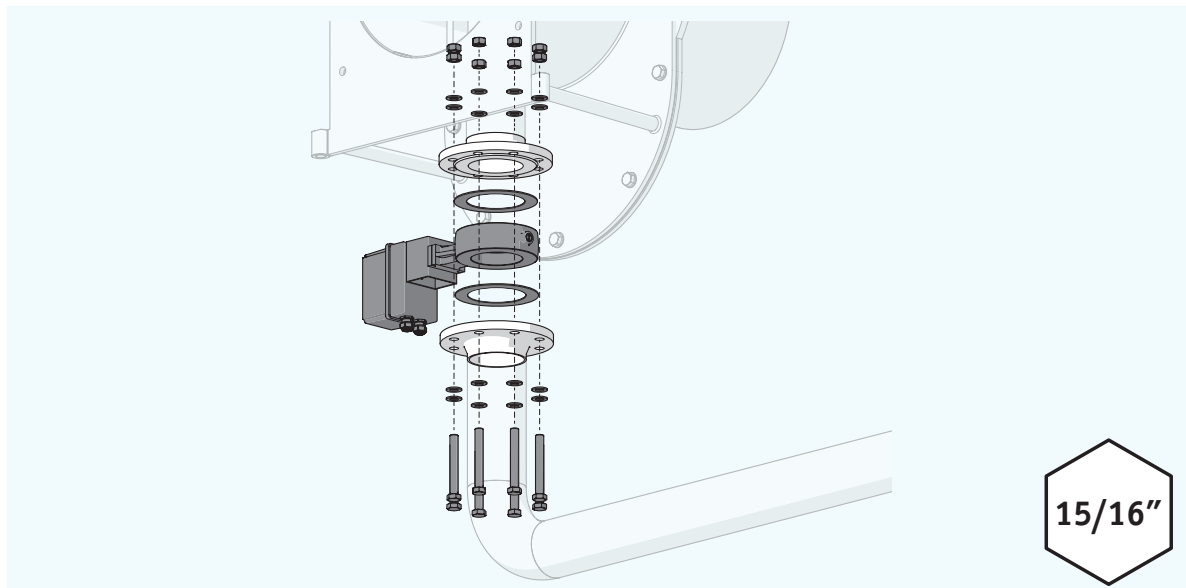

7. Attach the supply pipe to the gas train. Place gaskets between this connection.

NOTICE

Check that the supply line is clean so that the gas filter will not become blocked and that damage to the gas train cannot occur.

8. Install the ignition gas line.

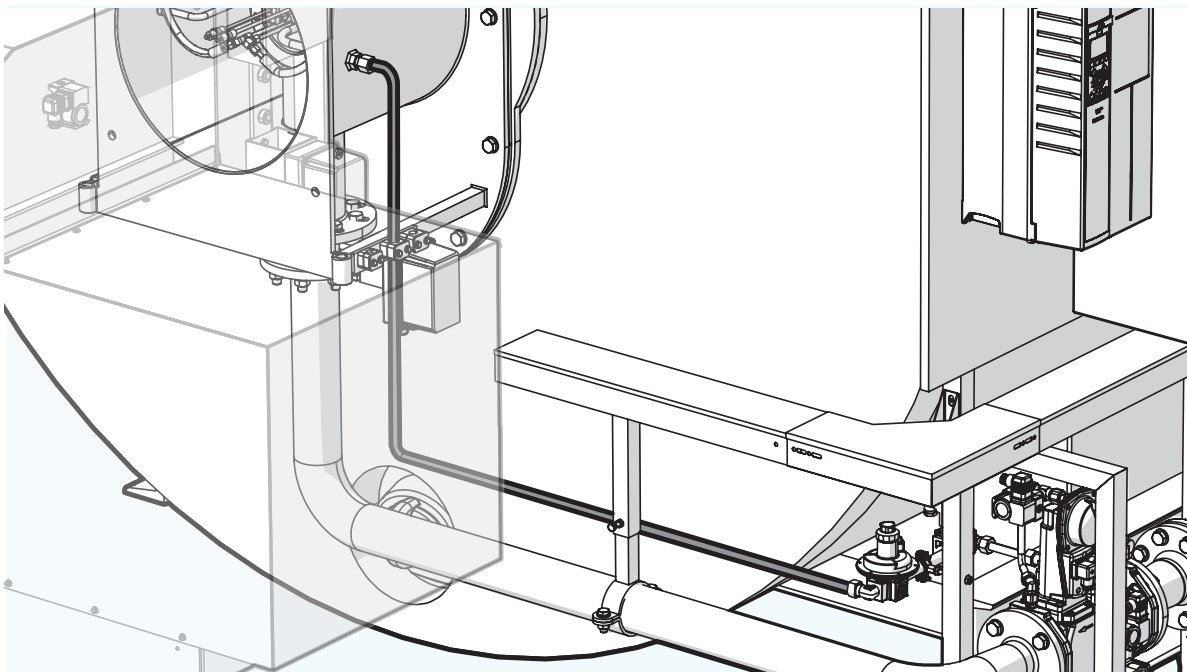

NOTICE

The gas line connection on the combustor can be changed by swapping around the air measure pipe and the pilot gas pipe inside the combustor housing.

4.8 Installing the oil pump or firing set

Only for VOI or VGOI

This section provides instructions for installing an oil pump or oil firing set (modulating or two-stage back-up).

NOTICE

While the illustrations in this section only show the installation for a standard oil pump, the instructions apply to the oil firing sets as well.

Provided tools:

- Oil line ($\frac{1}{2}$ " or $\frac{3}{4}$ ")
- Connector pieces

Required tools:

- Ring wrenches or adjustable spanners

To install the oil pump or firing set:

1. Place the oil pump or firing set next to the boiler, within range of the burner.
2. Connect the oil line to the oil supply line connection of the oil pump.
The width of the oil line depends on the size of the oil filter ($\frac{1}{2}$ " or $\frac{3}{4}$ ").
3. Connect the other end of the oil line to an external oil supply.
4. Connect the $\frac{1}{2}$ " oil line to the burner oil supply connection of the oil pump.

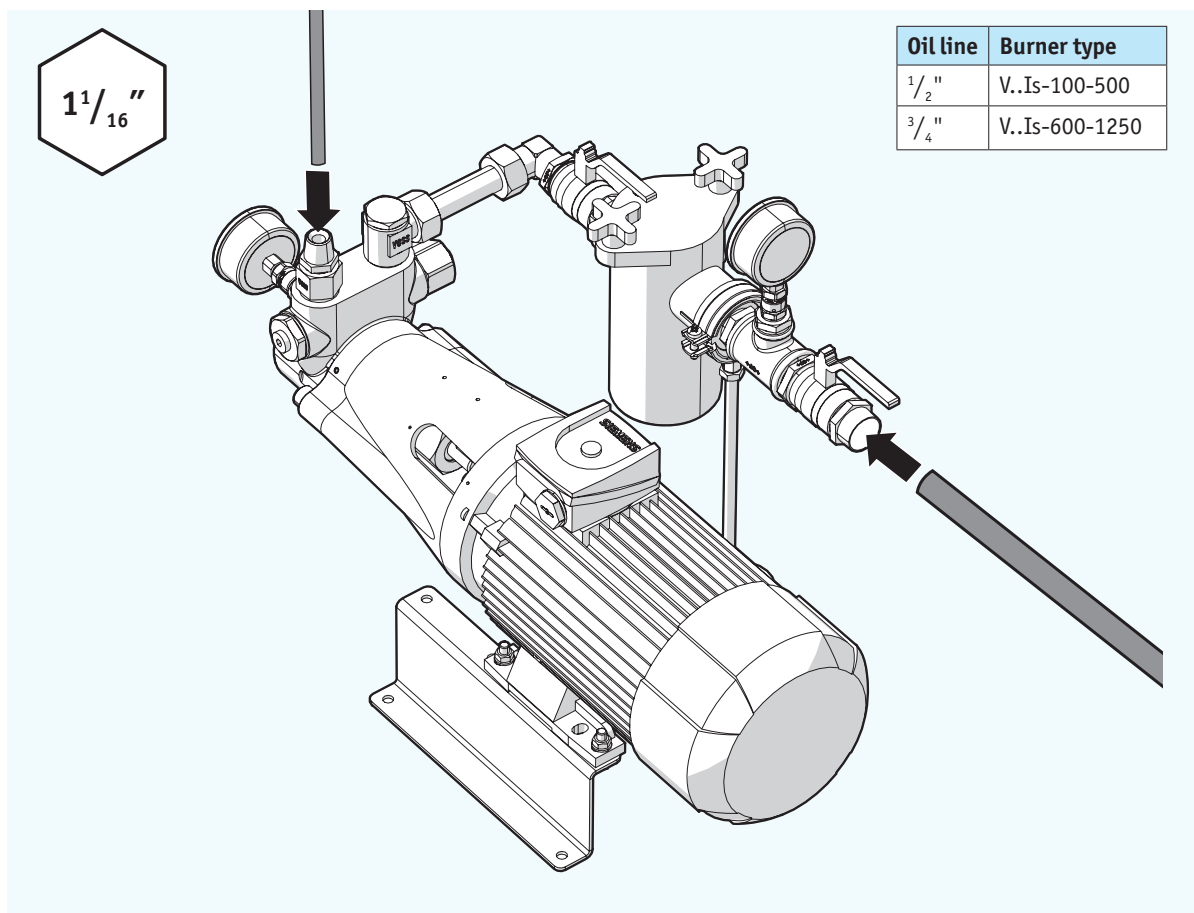

5. Connect the other end of the oil line to the combustor.

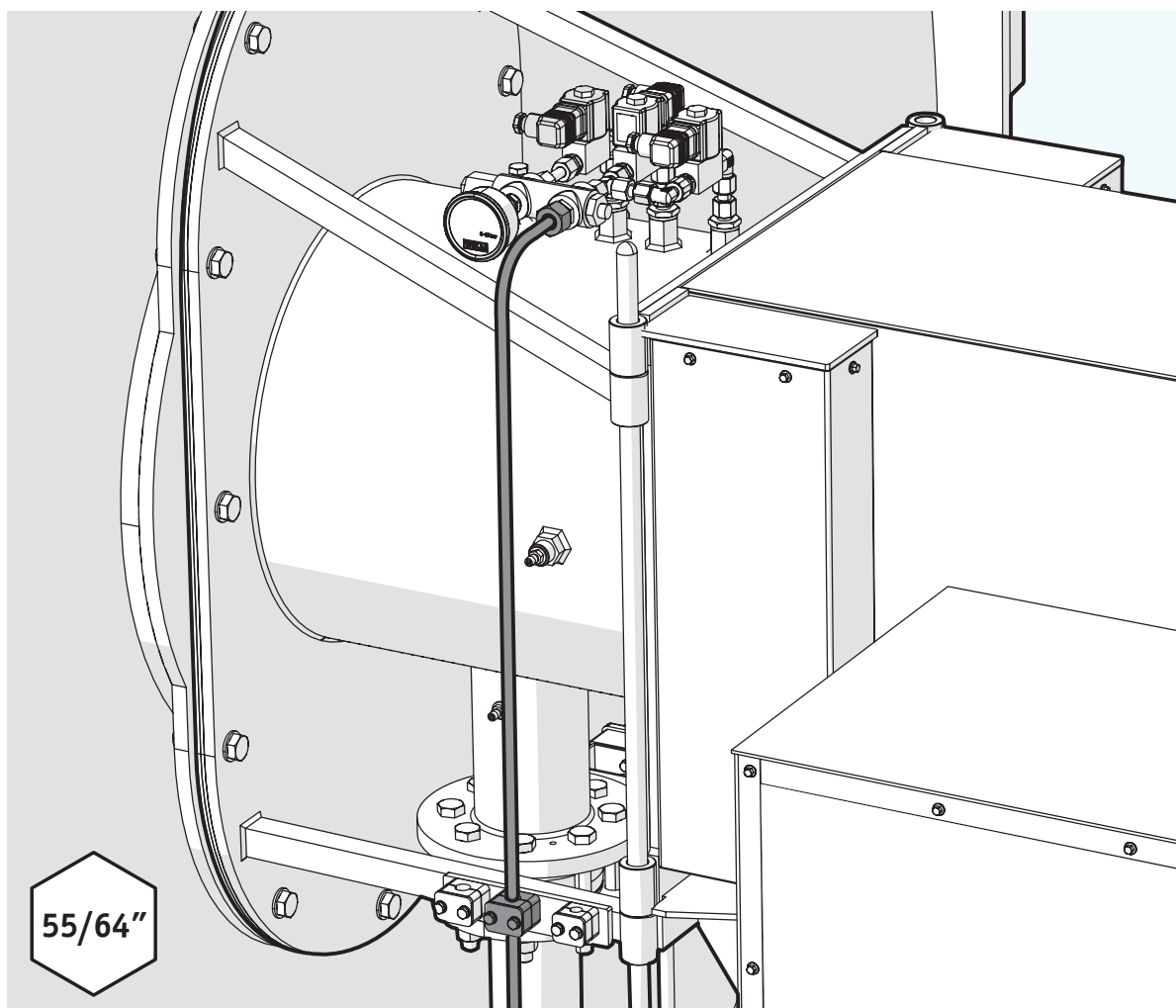



5 Commissioning

Before commissioning the burner system, make sure it meets the requirements below.

⚠ WARNING All mechanical screw connections (e.g. gas/oil line, flange connections, oil valves, electrical terminals) must be retightened prior to commissioning.

⚠ WARNING All components must be sealed with an appropriate sealant prior to commissioning.

NOTICE Commissioning of a Vitotherm installation may only be performed by certified personnel.

NOTICE A commissioning report is created after the burner system has been successfully commissioned. Keep this report near the burner for future reference.

- ☐ The burner system is completely installed according to the instructions in this manual, including:
 - ☐ Gas- and front pipes
 - ☐ Relief valve discharge tubes
 - ☐ Regulating pressure pipes
 - ☐ Explosion hatch
 - ☐ Refractory
 - ☐ Pilot gas tube
 - ☐ Oil pipe lines to pump and burner
- ☐ Electrical wiring is completed according to the provided electrical wiring diagram, free of errors, so that the electrical pre-start condition circuit (safety chain) is closed. Completion of electrical field wiring to the:
 - ☐ Burner
 - ☐ Gas train
 - ☐ Control panel
 - ☐ Boiler thermostat set
 - ☐ Control and safety equipment
- ☐ Electrical power is available on the boiler, burner, buffer and pumps (if applicable).
- ☐ The boiler is completely assembled, filled with a sufficient amount of heating medium, vented and ready for use.
- ☐ The water circuit to the boiler is tested and approved.
- ☐ Fuel inlet and outlet valves are closed.
- ☐ Fuel lines are purged free of air.
- ☐ Gas and/or oil pressure is available up to the burner A1 gas/oil valve.
- ☐ The gas supply pressure does not exceed the maximum permitted gas pressure as indicated on the burner plate (see §3.9).
- ☐ Safety components are functioning correctly and ready for operation (see §2.9).
- ☐ Equipment supplied by third parties that is present in the electrical burner panel (not related to burner control such as the pressure vessel) must be adjusted and programmed.
- ☐ Sufficient fresh air is available.
- ☐ Flue outlets are not obstructed.
- ☐ A blow-off facility is present and adjusted to the maximum boiler capacity.
- ☐ A demand for heat is present in the system.
- ☐ Possibility of heat release is present and controlled/supervised by local site supervisor.
- ☐ The necessary local work permits are available.
- ☐ Qualified personnel is available for instructions, system transfer and site acceptance test.
- ☐ A safe workspace is available, according to health and safety regulations and realistic commonsense.



6 Operation

This chapter describes the main operational procedures of the burner system.

6.1 Control panel

The burner is controlled via the control panel. This panel has several standard control switches and feedback LEDs, as well as controls that can be added to control optional features (e.g. an oil firing set). See §3.4 for an overview of the standard components of the control panel.

6.1.1 Main power switch

The control panel is activated by using the main power switch on the right side of the panel.

6.1.2 Internal components

The control panel can be opened with a key to gain access to:

- Relays and fuses
- A power outlet and modbus connection for a service laptop
- The USB drive with the technical file of the burner system
- This instruction manual

⚠ CAUTION

Contact with live parts can cause electric shocks, burns or even death.

- ▶ Only perform work on electrical equipment if you are an authorised electrician.
 - ▶ Before you start working on electrical equipment, switch off and lock out the power supply isolator and verify that no voltage is present.
-

6.1.3 Switching the burner on or off

The burner is switched on or off with the main switch. This switch has three options:

- 1 = Computer: ON - automatic controls.
- 0 = Off.
- 2 = MK8: ON - manual controls.

To operate the main switch:

- Set the main switch to 1 to cue the burner system to modulate based on the computer.
- Set the main switch to 2 to enable manual operation via the MK8 interface.
- Set the main switch to 0 to shut the burner system down.

6.1.4 Manually operating the burner

The burner system can be manually operated via the MK8 interface on the control panel.



For more information, please refer to the OEM manual.

6.1.5 Performing a system reset

A system reset must be performed after a failure in the burner or external boiler system has been resolved. This procedure allows the burner system to be put back into operation.

To reset the burner system:

- Press the reset button on the control panel.

6.1.6 Controlling the flame

The burner flame can be set to three different modes with the mode switch:

- 1 = Automatic; modulating flame
- 2 = Low flame; flame at lowest capacity (e.g. during inspection/maintenance)
- 3 = Manual; manual burner control

6.1.7 Switch between gas and oil

Only for VGOI

Burner systems that are equipped with an oil pump or oil firing set can switch between gas and oil. For these systems, a fuel switch is added on the control panel.

To switch from gas to oil supply:

1. Set the mode switch to **Low** and wait until the burner is on low.
2. Set the control switch to **Off**.
3. Set the fuel switch to **Oil**.
4. Change over the condenser flue gas valve to bypass the condenser.
5. Open all manual valves for the fuel supply at the:
 - Fuel tank
 - Burner
 - Oil pump or firing set
6. Set the control switch to **Manual**.
7. After ignition, set the mode switch to **Automatic**.
Make sure the boiler temperature is set to the required setting.

6.2 Frequency drive

The frequency drive is located next to the control panel and is used to control the motor of the burner fan. The frequency drive is operated via the interface in the top left corner.

NOTICE The factory settings of the frequency drive have been set by Vitotherm.

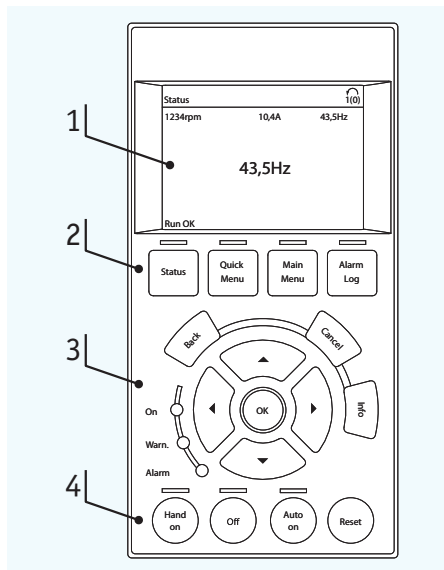

1. Graphical display with status information
2. Menu buttons and indicator LEDs
3. Navigation buttons and indicator LEDs
4. Operation buttons and indicator LEDs



For more information, please refer to the OEM manual.

6.3 Emergency shut down

Certain hazardous situations require an emergency shut down of the burner system (see §2.8).

To perform an emergency shut down:

1. Use the control switch on the control panel to close the fuel supply to the burner.
2. Use the manual emergency shut-off switch outside the boiler house to close the gas supply to the boiler house.
3. Use the fire switch outside the boiler house to cut off the power to the burner.

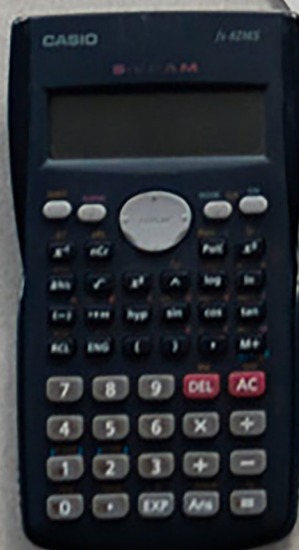
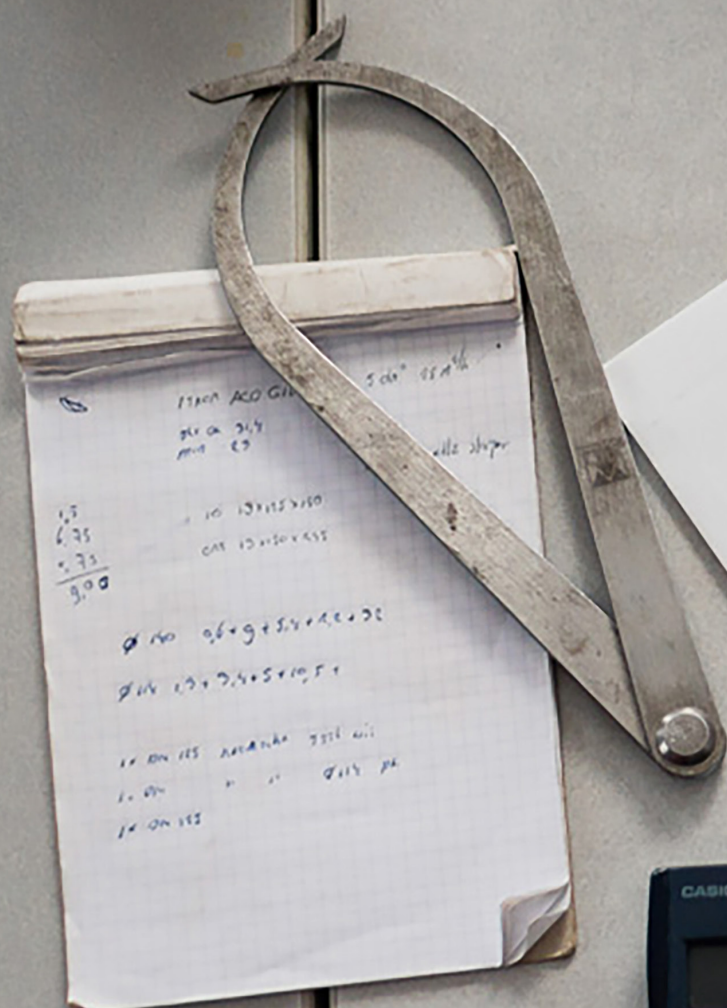

7 Troubleshooting

System failures are displayed on the interface of the control panel or frequency drive. The table below can be used to identify and solve the failure.



For more detailed information about these system failures, please refer to the OEM manual of the Autoflame MK8 operating system.

Description	Instructions
Leak test (LT) failure	A leak is detected between the main or pilot gas valves. All valves must be checked by a specialist to identify the leaking valve. This valve must be replaced.
Frequency controller failure	Check the display of the frequency drive and read out the failure. Use the OEM manual to solve the problem.
Electronic low water level boiler failure	Check the water level of the boiler to see if the level is high enough.
Low water level boiler failure	Remove any air in the system that may cause this problem.
Max. boiler water temperature failure	Check the water temperature of the boiler. Make sure that the water temperature inside the boiler is below the boiling point.
Gas supply pressure too low (LD) failure	Check if the gas pressure to the burner corresponds with the required pressure mentioned on the burner plate (see §3.9). Adjust if necessary.
Min. gas pressure (LD1) failure	
Max. gas pressure (HD) failure	Check if there are any differences between the gas pressure regulator and the commissioned value. Check if the maximum capacity has not been exceeded. Adjust if necessary.
Max. water temperature condenser failure	Check the water temperature of the condenser system. Make sure that the condenser is below 95 °C and that the pump is running.
Max. flue gas pressure condenser (HD eco) failure	Check the condenser or economiser for any flue gas blockage or leakage.
Emergency stop	The emergency stop is engaged. Evaluate the situation and restart the burner.
Min. air pressure (LD2) failure	Check the display of the frequency drive for failures. Check the air intake for blockage. If the combustion air fan is still producing the needed pressure for the operation, compare the air pressure to the commissioned value. Adjust if necessary.
Thermal overload oil pump	Check if the supply power corresponds with the value on the burner plate (see §3.9). Make sure all the manual valves are open.

Description	Instructions
Condensor bypass valve not open (ES OIL) failure	When switched over to emergency oil operation, check the condensor bypass valve. The bypass valve has to make sure that the flue gases are bypassed on the condensor to prevent blockage and corrosion when operating on oil.
Min. water boiler pressure failure	Check the water level of the boiler system to see if the level is ok. Remove any air in the system that can cause this problem.
Max. water pressure boiler failure	Check the water pressure in the heating system of the boiler.
Flame failure	Check the flame scanner. Check the complete ignition. Check the pilot and main gas valves. Check the flame stability and combustion.
Autoflame MK8 OEM failure	Check the screen of the Autoflame MK8 and read out the failure. Check the OEM manual of the burner control to solve the problem.
CO ₂ chimney valve not closed (ES CO ₂) failure	Check if the CO ₂ fluegas valve in the chimney to the CO ₂ collector is closed during the start-up procedure of the burner.



This image shows a full page of blank handwriting practice paper. It features 20 evenly spaced, horizontal blue lines running across the entire width of the page. The lines are thin and consistent in color, providing a guide for letter height and placement. There are no margins, text, or other markings on the paper.



8 Maintenance

8.1 Pre-emptive parts replacement schedule

Certain parts of the burner system should be replaced every X years to prevent failure of vital components. The table below gives an overview of these maintenance activities and the frequency with which they should be performed.

NOTICE

A set of the most commonly replaced parts is available (see §3.8.5). To order this set or other replacement parts, please contact Vitotherm or your supplier.

Task	Interval (years)							To be carried out by
	1	2	5	8	10	15	20	
Burner								
Ignition pins	●							
UV-cell		●						
Ignition cable		●						
Rajah clamps		●						
Pressure sensor					●			
End switches					●			
Oil nozzles		●						
Sound insulation					●			
Flexible oil hoses			●					
Gas valve train								
Actuators (Siemens SKP15)						●		
Actuators (Siemens SKP25)						●		
Pneumatic pressure hose (blue)		●						
Control panel								
Pneumatic timers					●			
Main power relay motor fan							●	
Interface relay					●			
Electronic timers					●			
Auxiliary relay					●			
VCD								
Pump		●						
CO sensor			●					
3-way valve			●					
Boiler / condenser								
HD condenser			●					
Maximum thermostat boiler				●				

8.2 Annual Periodic Maintenance

To guarantee the quality and safety of the burner system, Vitotherm advises annual Periodic Maintenance (PM) to be performed by their own certified service engineers.

⚠ CAUTION

To guarantee the quality and safety of the burner system, Vitotherm advises annual Periodic Maintenance (PM) to be performed by their own certified service engineers.

NOTICE

This section contains maintenance instructions for the standard components of a burner system. For maintenance instructions for any other (optional) components, please refer to the corresponding OEM manual.

A checklist of maintenance activities during Periodic Maintenance can be found in Appendix D of this manual.

8.2.1 Control panel

The following aspects of the control panel should be inspected:

- All electrical connections;
- The cables, for any sign of overload or burns;
- The circuit breaker fuses, for a correct rating;
- All switches and lights, for correct functioning;
- The cam timers, for correct functioning;
- The alarm display;
- The fuel interlocks.

8.2.2 Burner unit

To perform Periodic Maintenance on the burner unit, do the following:

1. Perform a visual check of all components for correct functioning.
2. Remove the burner head.
3. Clean and check:
 - the burner ignition system, including the HT lead and cap;
 - the igniters. Reset if necessary;
 - the condition of the atomizer cup, including concentricity;
 - the cup shroud. Ensure it is set correctly;
 - the splash wheel, for noise;
 - the primary air casing, for any signs of oil;
 - the condition of the burner quarrel and flame baffle;
 - the flame control sensor (UV-cell or ionization probe).
4. Replace the ignition pin.

8.2.3 Moveable parts

The linkages and moveable parts of the burner system require the following maintenance activities:

- Clean and check:
 - the operation of the linkage and cam unit, for wear free movement;
 - the modulation of the motor and clutch;
 - the operation of low and high fire micro switches;
 - the secondary air dampers, for free movement;
 - the primary air butterfly, for free movement.

8.2.4 Gas

For VGI and VGOI

- Check the gas supply to the burner for leaks and correct pressure;
- Check and test the gas train for correct functioning;
- Check the combustion performance for optimal efficiency for CO₂ and heat output.
 - Adjust if necessary.

8.2.5 Oil

For VOI and VGOI

- Perform a visual check of:
 - the installation for oil leaks;
 - the wiring and connections;
 - the condition of flexible oil hoses (if applicable), replace every 5 years;
 - the oil meter.
- Check and test:
 - the solenoid valves for correct functioning;
 - the test block heater and trace heat tape for correct functioning;
 - the thermostat for operational oil temperature;
 - the oil for correct temperature and pressure.
- Check the combustion performance for optimal efficiency for CO₂ and heat output.
 - Adjust if necessary.

8.2.6 Flue gas measurements

The concentration of the following gases in the flue gas must be measured and compared to the commissioning report:

- CO
- O₂
- NO_x

If the concentration of (one of) these gases differs from the values in the commissioning report, adjust back to the original settings.

8.3 Maintenance of the burner

This section provides information and instructions on how to perform maintenance on the MONO-block burner.

⚠ WARNING Make sure the burner system is completely shut down before performing maintenance on the burner:

- ▶ Use the control switch on the control panel to close the fuel supply to the burner.
- ▶ Interrupt the mains power supply to the burner system.

⚠ WARNING All mechanical screw connections (e.g. gas/oil line, flange connections, oil valves, electrical terminals) must be retightened prior to every Periodic Maintenance.

⚠ CAUTION To guarantee the quality and safety of the burner system, Vitotherm advises annual Periodic Maintenance (PM) to be performed only by their own certified service engineers.

Required tools:

- Ring wrenches or adjustable spanners.

To perform maintenance on the burner:

1. Perform maintenance on the fan housing:
 - a. Remove the sound cover of the fan motor. Check the sound material for defects and check if the sound material is still physically attached to the plate material.
 - b. Remove the side plate of the fan housing inlet. Check the sound material for defects and check if the sound material is still physically attached to the plate material.

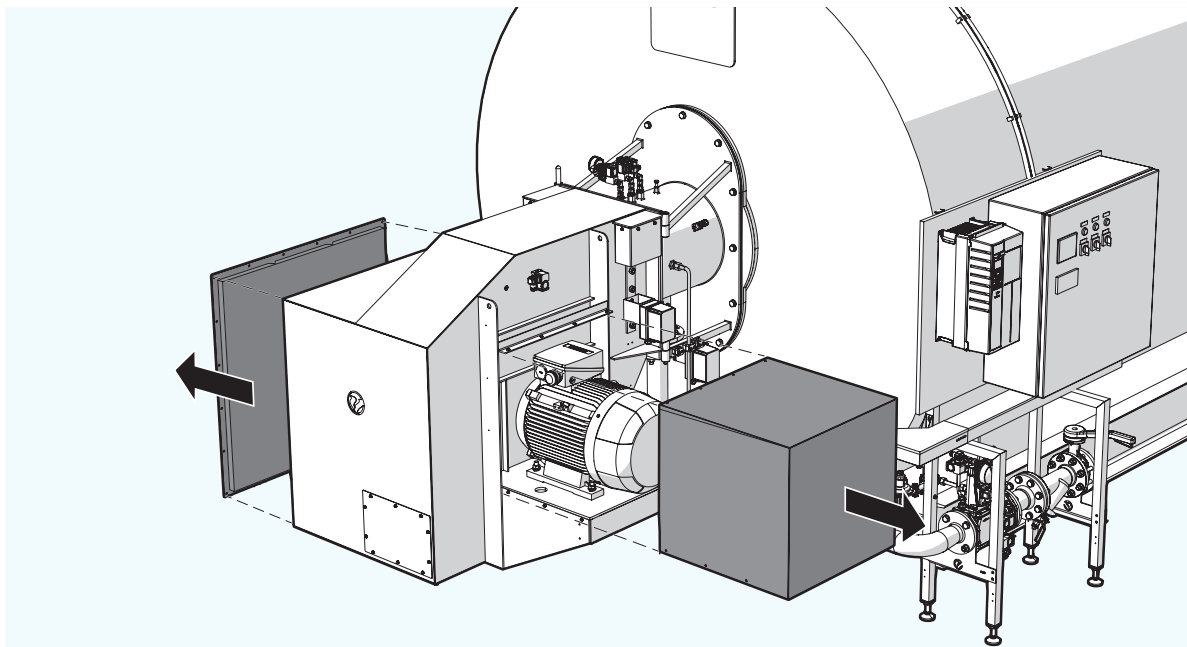

- c. Mark the position of the intake and remove it.
- d. Check the fan for any dirt or defects
- e. Check the fan motor for any defects and clean if necessary.
- f. Check and clean the inlet of the air pressure switch (LD2).
- g. Place the intake back and check if the fan is running free from the intake.
- h. Put back the side plate of the fan housing inlet and the sound cover of the fan motor.

2. Open the fan housing to access the combustor:
 - a. Remove the bolts.
 - b. Remove the (small) locking pin.
 - c. Slightly rotate the housing away from the combustor.
 - d. Disconnect the ignition cables.
 - e. Fully rotate the housing away from the combustor.
3. Check the following combustor components for any dirt or defects:
 - The air measure pipe
 - The UV cell
 - The pilot burner
 - The ignitors
 - The high voltage cable and the connectors for the ignitors
 - The combustor housing
 - If necessary, clean or replace the components above.
4. Check if the air valves are clean and open smoothly.
 - Clean the valves and the axles if necessary.
5. Disassemble the combustor:
 - a. Disconnect the air measure pipe.
 - b. Disconnect the oil lines (VOI and VGOI only)
 - c. Pull out the UV cell.
 - d. Disconnect the pilot gas pipe.
 - e. Remove the burner head locking bolt and the bracket it holds into place.

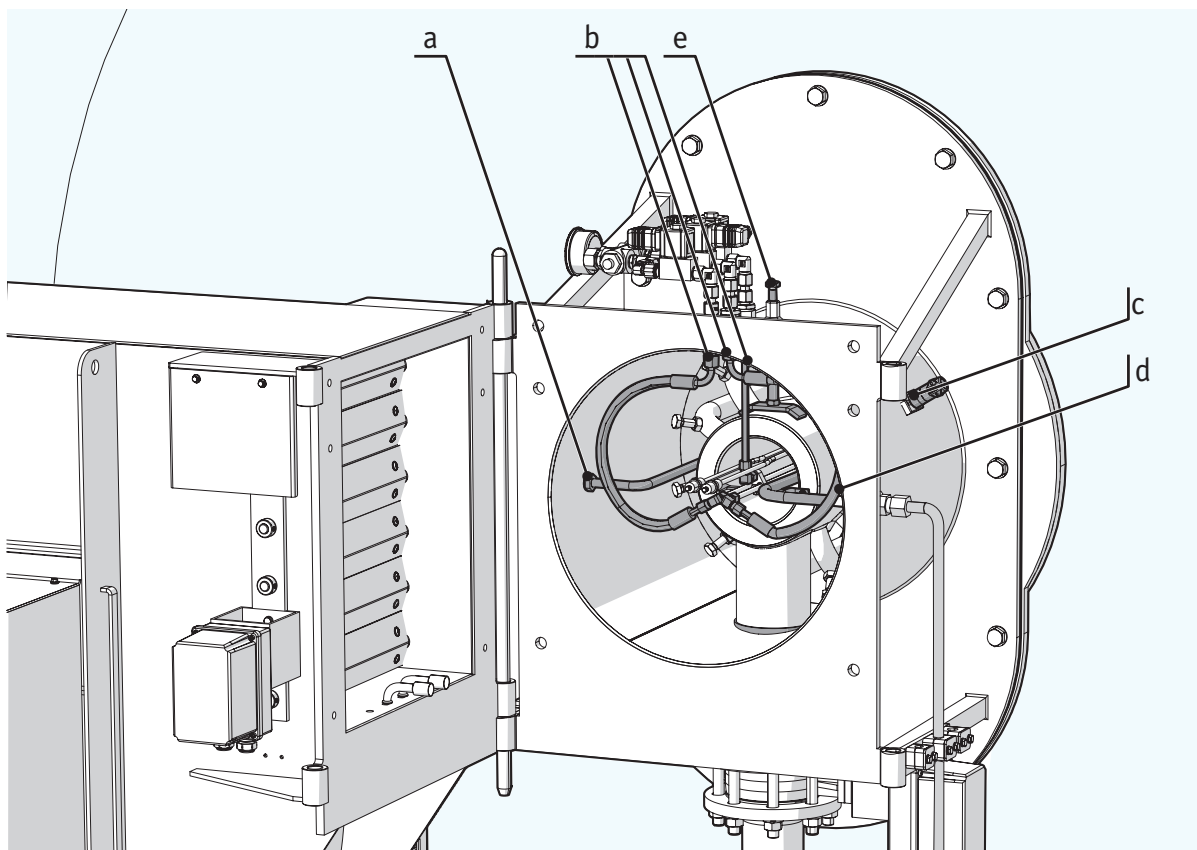

- f. Disconnect and remove the complete pilot burner with oil lances and pilot gas line
- g. Lift the burner head out of the combustor.
- h. Remove the gasket.

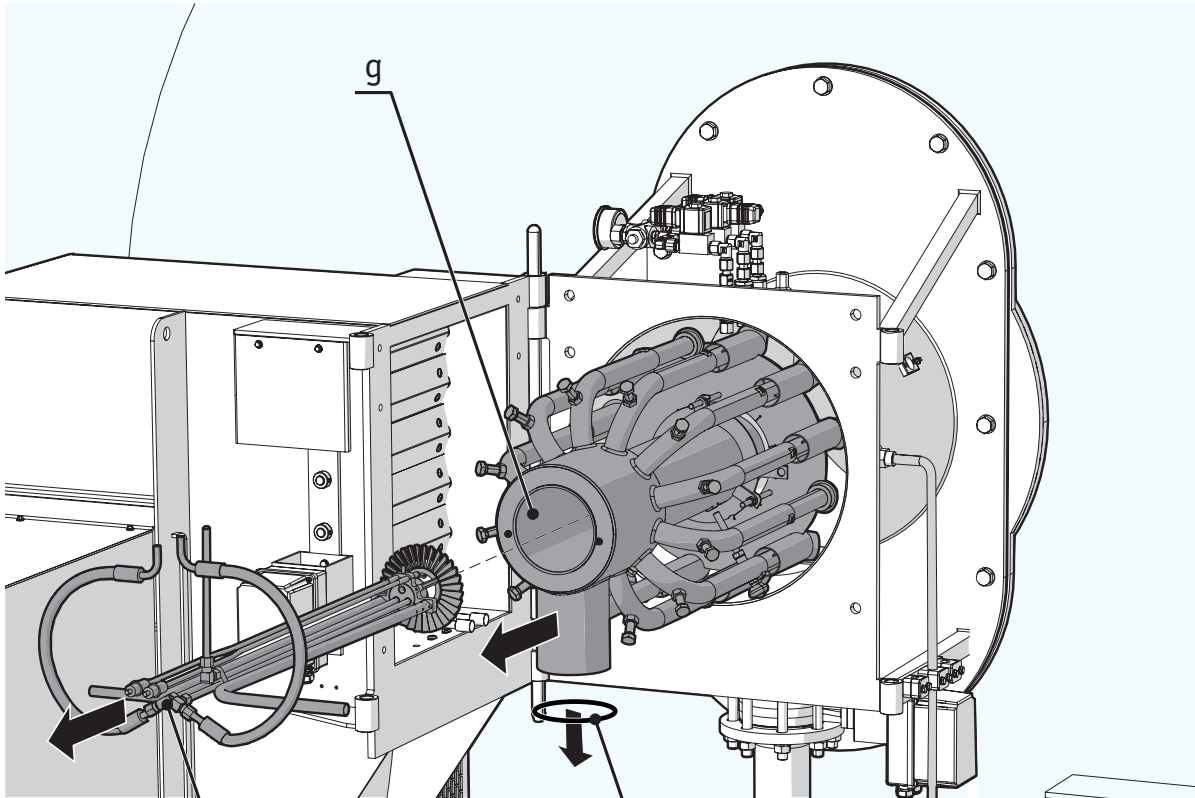

6. Check the following components of the burner head for any dirt or defects:

- Burner head gasket
- Flame plate and connections
- Inner tube
- Gas pipes
- Mixer tubes
- If necessary, clean or replace the components above.

7. Reassemble the burner.



9 Decommissioning and disposal

This section contains instructions and information on how to properly decommission and dispose of the burner.

⚠ CAUTION

The burner system may only be installed by qualified personnel. Handling the burner unit and supporting components without the required knowledge and experience may damage the burner system or cause hazardous situations during installation and use.

9.1 Decommissioning

To decommission the burner system:

1. Use the control switch on the control panel to switch the burner off.
2. Close the gas and oil supply to the burner.
3. Cut off the power to the burner.

9.2 Dismantling the burner

Required tools

- Mobile crane with adequate lifting capacity.
- Ring wrenches or adjustable spanners.
- Suitable hoisting equipment:
 - D-shackles
 - Round sling

To dismantle the burner:

1. Disconnect the cabling from the:
 - a. Fan housing
 - b. Gas train
 - c. Control panel
 - d. Boiler thermostat set
2. Remove the fan housing.
3. Disconnect the oil supply line from the combustor.
4. Disconnect the gas line adapter from the combustor.
5. Remove the combustor from the boiler.
6. Remove the boiler thermostat set.
7. Remove the Vitopack.

or

Remove the control panel and gas train.

9.3 Disposal

⚠ CAUTION

Separate and dispose the components of the burner into the applicable waste streams based on their material, in accordance with local regulations.

NOTICE

All structural components of a Vitotherm automatic forced draught burner are made of powder-coated steel and should be disposed of accordingly.



For more information on how to properly dispose of supplier parts, please refer to the OEM manual.



10 Transport and storage

This section contains instructions and information on how to properly transport and store the burner.

10.1 Transport

When transporting the components of the burner system separately, use suitable hoisting or lifting equipment.

-
- Heavy objects such as the fan housing and combustor may drop or topple when transported incorrectly.
- ⚠ WARNING**
- ▶ Use suitable lifting or hoisting equipment.
 - ▶ Make sure no personnel is below or near the object when lifting or hoisting.
-

10.1.1 Fan housing

The fan housing of the burner is equipped with two holes, located above the centre of gravity. These holes can be used to attach D-shackles and round slings to hoist the housing (see §4.3).

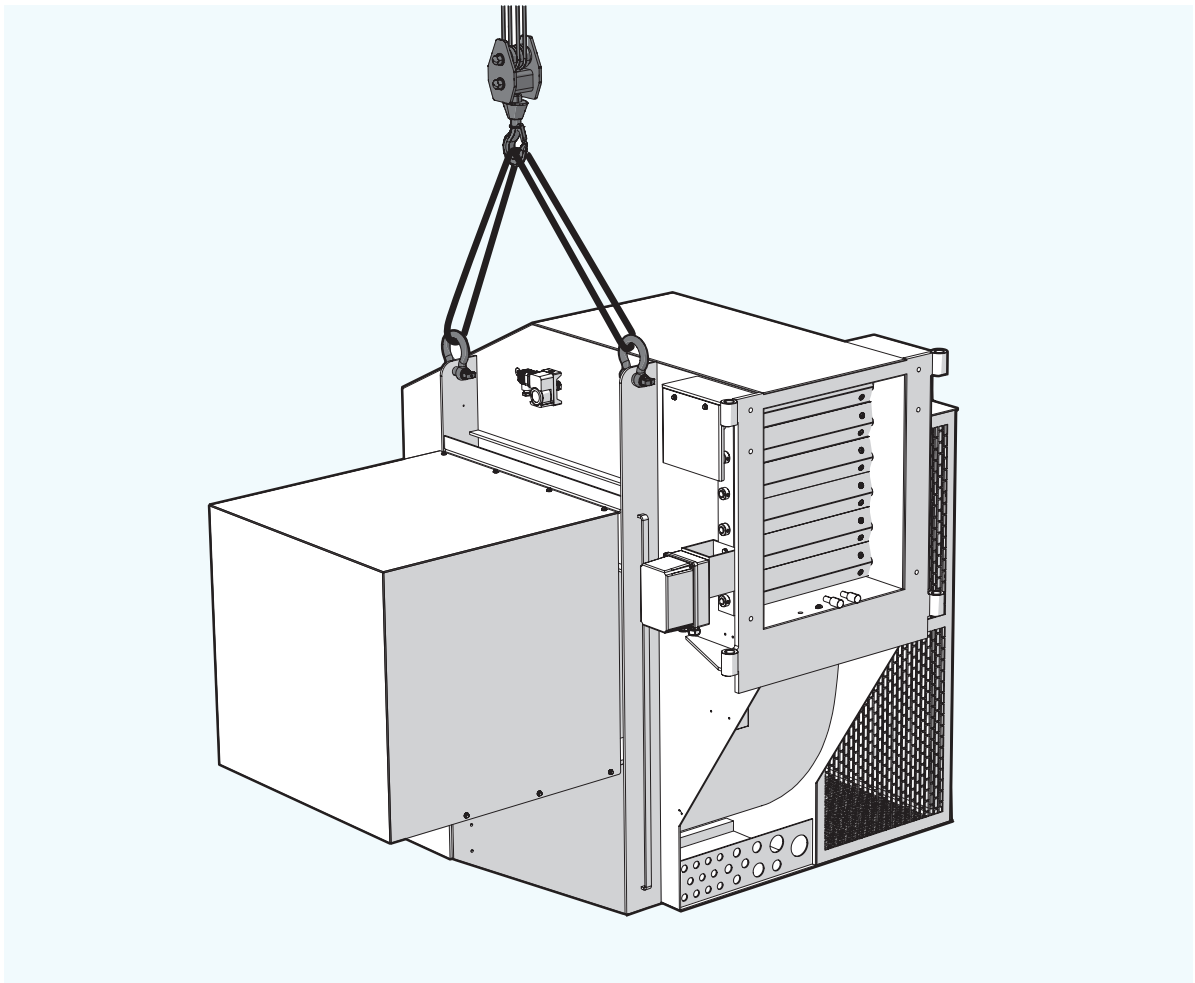

10.1.2 Combustor

The combustor can be lifted with a hoisting sling. This sling should be attached to the housing of the combustor, between the flange and the back plate.

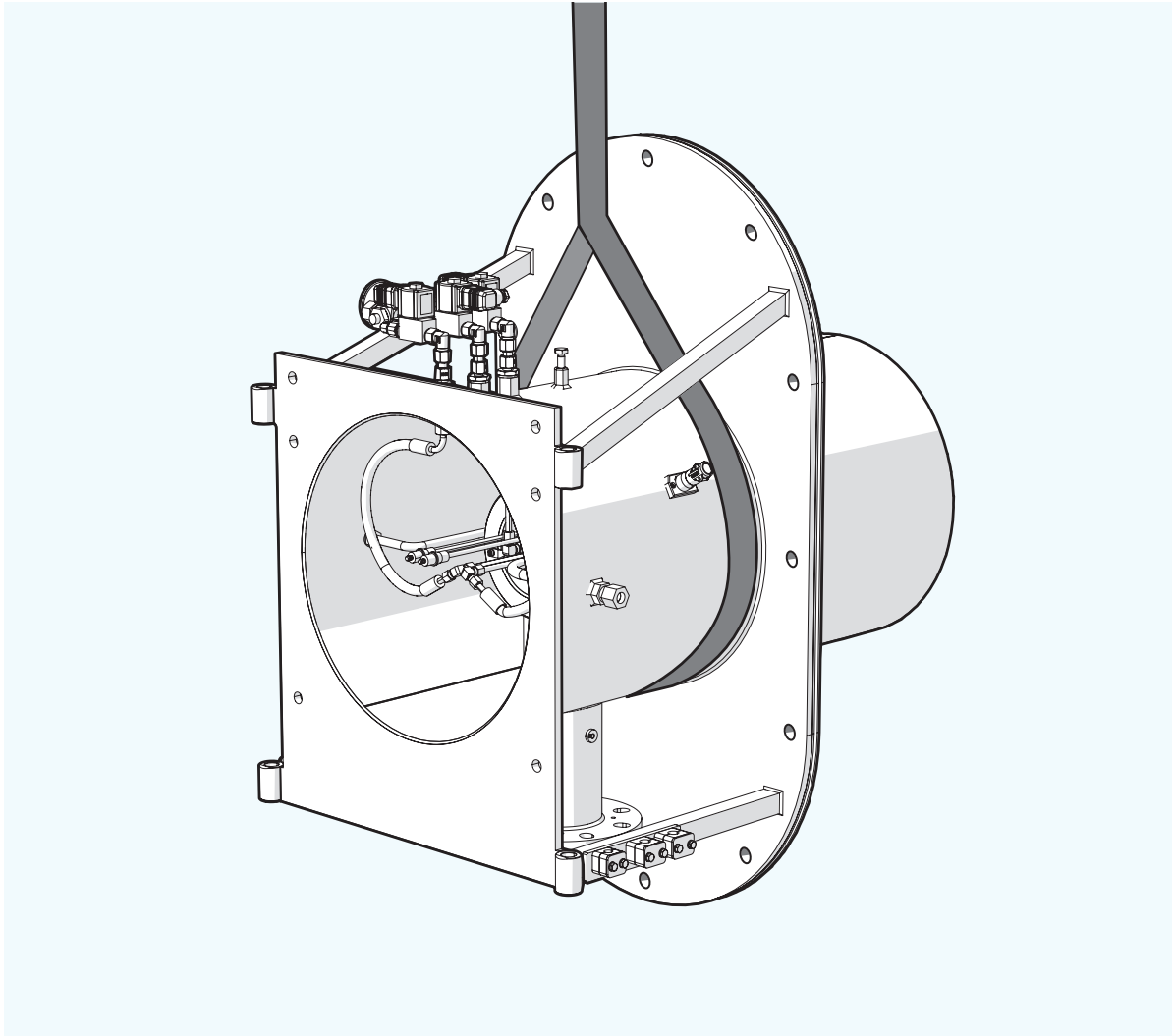

Slings might shift due to hoisting movements, causing unforeseen movement or toppling of the combustor.

⚠ WARNING

- ▶ Make sure that the sling is trapped in the combustor construction and cannot slide off.
- ▶ Do not attach slings to the open front section of the combustor, where the sling might slide off, or to the reinforcement bars.

10.1.3 Vitopack

The Vitopack is equipped with two holes at the top of the frame. These holes can be used to attach D-shackles and round slings to hoist the installation (see §4.7).

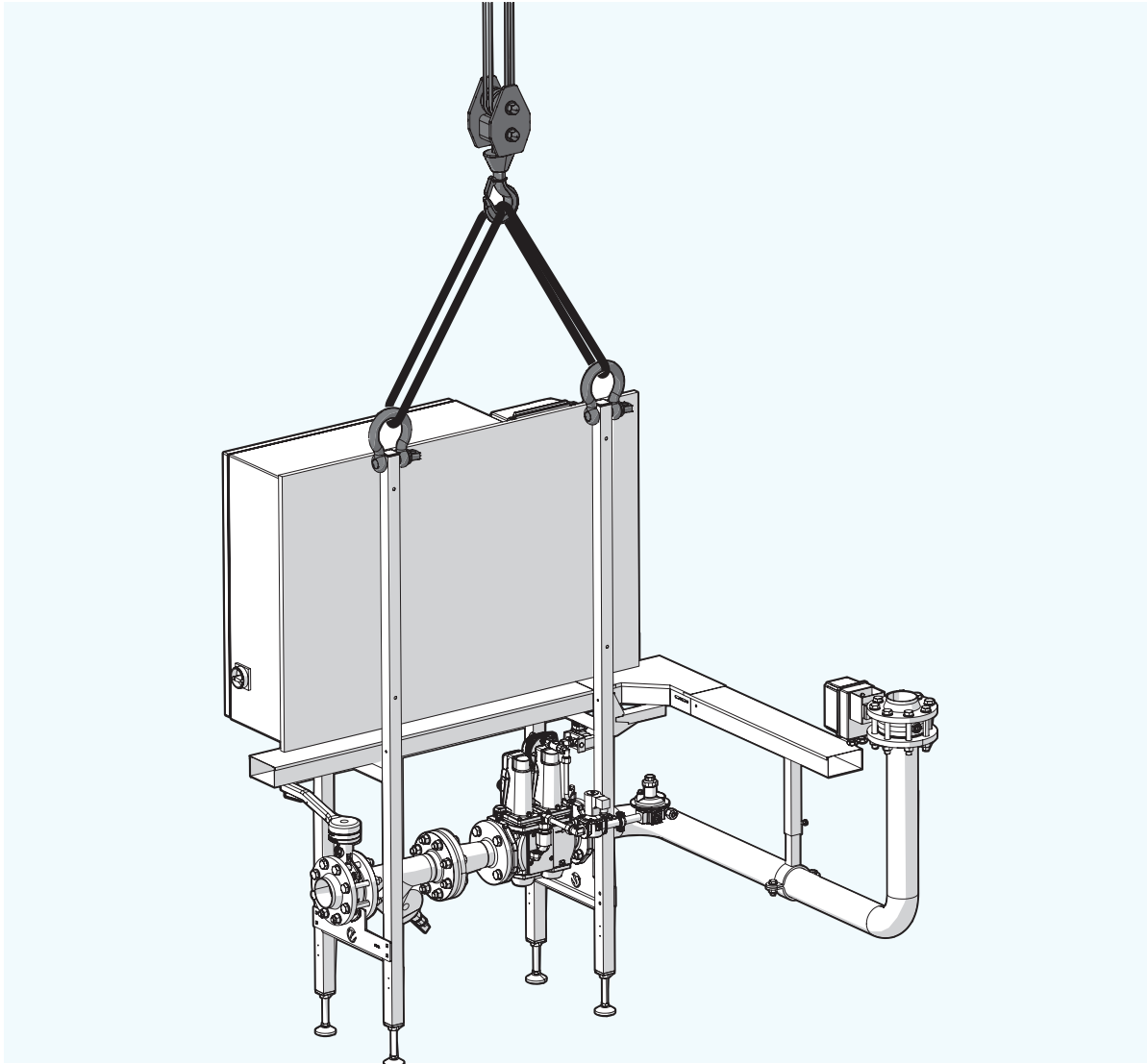

10.2 Storage

The steel components of the burner are sensitive to corrosion damage.

⚠ CAUTION

- ▶ Always store the burner in a dry, indoor location.
- ▶ Do not unpack the burner from the crate until you are ready to install it.

Appendices

A Burner system overview

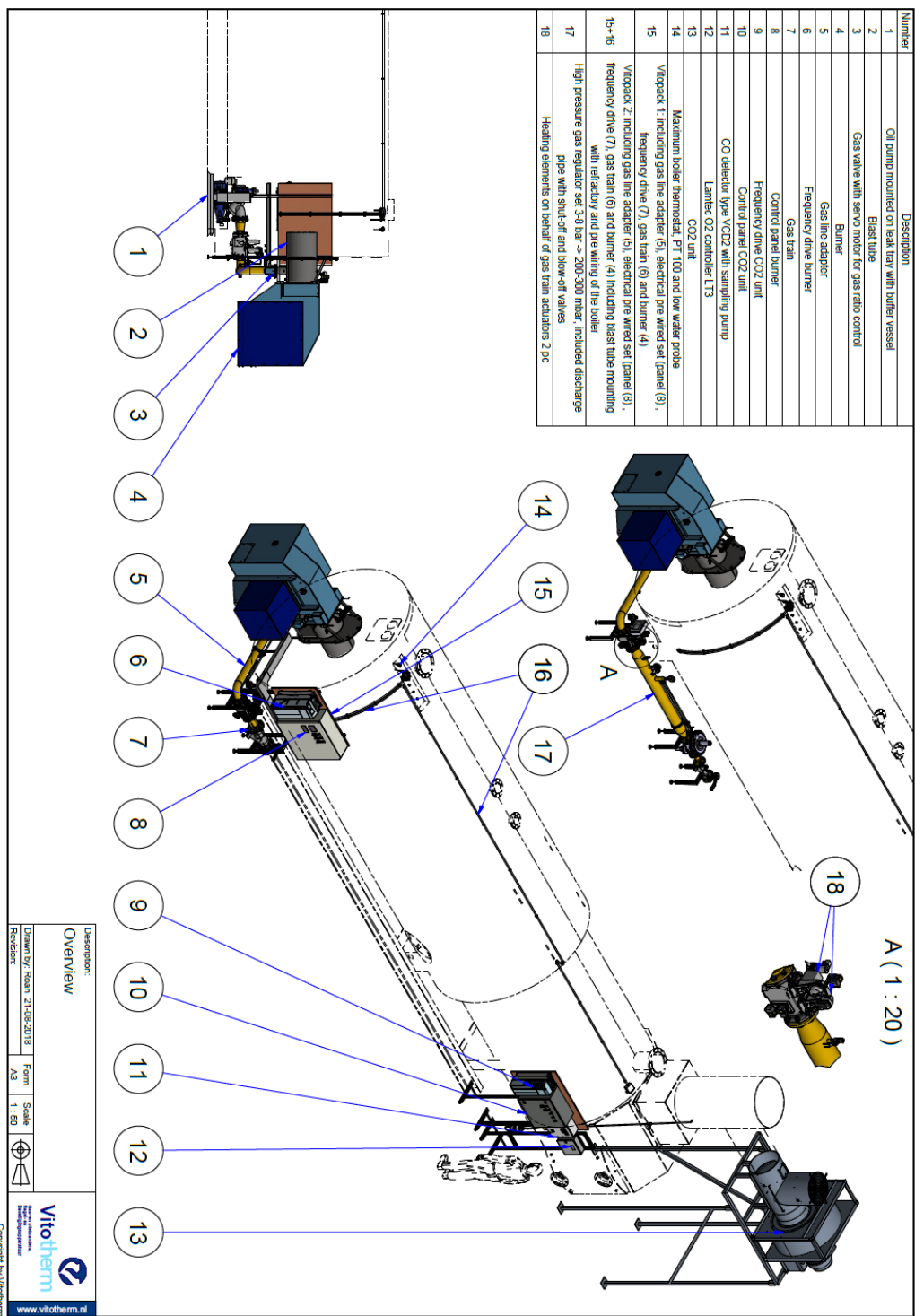

B Declaration of conformity



Vitotherm

Declaration of conformity								
Manufacturer:	VITOTHERM B.V.							
Adress:	Overgauwseweg 8 2641NE Pijnacker							
Products:	Force draft burners							
Type:	VITOTHERM B.V. burner types:							
<i>Gas burners:</i>	VGIs-100	VGIs-150	VGIs-200	VGIs-250	VGIs-300	VGIs-350	VGIs-400	VGIs-450
	VGIs-500	VGIs-600	VGIs-700	VGIs-800	VGIs-1000	VGIs-1250	VGIs-1500	
<i>Gas/oil burner:</i>	VGOIs-100	VGOIs-150	VGOIs-200	VGOIs-250	VGOIs-300	VGOIs-350	VGOIs-400	VGOIs-450
	VGOIs-500	VGOIs-600	VGOIs-700	VGOIs-800	VGOIs-1000	VGOIs-1250	VGOIs-1500	
<i>Oil burner:</i>	VOIs-100	VOIs-150	VOIs-200	VOIs-250	VOIs-300	VOIs-350	VOIs-400	VOIs-450
	VOIs-500	VOIs-600	VOIs-700	VOIs-800	VOIs-1000	VOIs-1250	VOIs-1500	
<i>Fuels:</i>	Natural gas LPG LNG BIO-gas Light oil BIO-oil							
	The suitability of fuels of different quality must be confirmed in advance by VITOTHERM B.V.							
Applications:	VITOTHERM BURNERS are suitable for intermittent firing and continuous firing on:							
	Warm-water / Hot-water Boilers , direct and indirect fired Steam Boilers Air Heaters direct and indirect fired Process applications							
Standards:	Mentioned products are in compliance with the following technical standards:							
	EN 267 EN 676 EN 746							
Directives:	Mentioned products are according the following European directives:							
	GAR 2016-426-EU MD 2006-42-EG PED 2014-68-EU EMC 2014-30-EU LVD 2014-35-EU CE-PIN 2009/142/EC							
NOx emission	VITOTHERM B.V. declares that the mentioned Products comply with the following standards:							
	BEMS 1. BImSchV NOx class 3							
Protection class IP:	Degree of protection							
	IP54 IP - EN 60529							
Marking of type plate:	The burners are labelled with:							
	CE mark CE Pin nr Identification No. of Notified Body EAC							

C Performance data (Metric)

MONO-block low NOx gas burner

Type	Boiler capacity (n = 93%)		Burner input	Control	Gas pressure	Max. boiler backpressure	Motor/drive power	Turn down	Consumption	Max. height
	MCal	kW	kW	Gas	Mbar	Mbar	kW	Gas	Gas (m³)	m
VGIs-100	1,000	1163	1250	Modulating	100-300	10	2,2	1:5	142	500
VGIs-150	1,500	1745	1875	Modulating	100-300	10	4,0	1:5	213	500
VGIs-200	2,000	2326	2500	Modulating	100-300	10	4,0	1:5	284	500
VGIs-250	2,500	2908	3125	Modulating	100-300	10	5,5	1:5	355	500
VGIs-300	3,000	3489	3750	Modulating	100-300	12	7,5	1:6	426	500
VGIs-350	3,500	4071	4375	Modulating	100-300	12	7,5	1:6	487	500
VGIs-400	4,000	4652	5000	Modulating	100-300	12	11,0	1:6	568	500
VGIs-450	4,500	5234	5625	Modulating	100-300	12	11,0	1:6	639	500
VGIs-500	5,000	5815	6250	Modulating	100-300	12	15,0	1:7	710	500
VGIs-600	6,000	6978	7500	Modulating	100-300	13	18,5	1:7	852	500
VGIs-700	7,000	8141	8750	Modulating	200-300	14	22	1:8	994	500
VGIs-800	8,000	9304	10000	Modulating	300	15	30	1:8	1136	500
VGIs-1000	10,000	11630	12500	Modulating	300	17	37	1:10	1420	500
VGIs-1250	12,000	13956	15000	Modulating	300	17	45	1:10	1704	500

MONO-block low NOx gas & emergency back-up oil burner

Type	Boiler capacity (n = 93%)		Burner input	Control		Gas pressure	Max. boiler backpressure	Motor/drive power	Turn down		Con- sumption		Max. height
	MCal	kW	kW	Gas	Oil	Mbar	Mbar	kW	Gas	Oil	Gas (m³)	Oil (kg/h)	mtr
V(G)OIs-100	1,000	1163	1250	Modul.	2-stage	100-300	10	2,2	1:5	1:2	142	84	500
V(G)OIs-150	1,500	1745	1875	Modul.	2-stage	100-300	10	4,0	1:5	1:2	213	126	500
V(G)OIs-200	2,000	2326	2500	Modul.	2-stage	100-300	10	4,0	1:5	1:2	284	168	500
V(G)OIs-250	2,500	2908	3125	Modul.	2-stage	100-300	10	5,5	1:5	1:2	355	210	500
V(G)OIs-300	3,000	3489	3750	Modul.	2-stage	100-300	12	7,5	1:6	1:2	426	252	500
V(G)OIs-350	3,500	4071	4375	Modul.	2-stage	100-300	12	7,5	1:6	1:2	487	294	500
V(G)OIs-400	4,000	4652	5000	Modul.	2-stage	100-300	12	11,0	1:6	1:2	568	336	500
V(G)OIs-450	4,500	5234	5625	Modul.	2-stage	100-300	12	11,0	1:6	1:2	639	378	500
V(G)OIs-500	5,000	5815	6250	Modul.	2-stage	100-300	12	15,0	1:7	1:2	710	420	500
V(G)OIs-600	6,000	6978	7500	Modul.	2-stage	100-300	13	18,5	1:7	1:2	852	504	500
V(G)OIs-700	7,000	8141	8750	Modul.	2-stage	200-300	14	22	1:8	1:2	994	588	500
V(G)OIs-800	8,000	9304	10000	Modul.	2-stage	300	15	30	1:8	1:2	1136	672	500
V(G)OIs-1000	10,000	11630	12500	Modul.	2-stage	300	17	37	1:10	1:2	1420	840	500
V(G)OIs-1250	12,000	13956	15000	Modul.	2-stage	300	17	45	1:10	1:2	1704	1008	500

MONO-block low NOx gas & long term oil dual fuel burner

Type	Boiler capacity ($\eta = 93\%$)		Burner input	Control		Gas pressure	Max. boiler backpressure	Motor / drive power	Turn down		Consumption		Max. height
	MCal	kW	kW	Gas	Oil	Mbar	Mbar	kW	Gas	Oil	Gas (m ³)	Oil (kg/h)	m
V(G)OIs-100	1,000	1163	1250	Modulating		100-300	10	2,2	1:5	1:5	142	84	500
V(G)OIs-150	1,500	1745	1875	Modulating		100-300	10	4,0	1:5	1:5	213	126	500
V(G)OIs-200	2,000	2326	2500	Modulating		100-300	10	4,0	1:5	1:5	284	168	500
V(G)OIs-250	2,500	2908	3125	Modulating		100-300	10	5,5	1:5	1:5	355	210	500
V(G)OIs-300	3,000	3489	3750	Modulating		100-300	12	7,5	1:6	1:5	426	252	500
V(G)OIs-350	3,500	4071	4375	Modulating		100-300	12	7,5	1:6	1:5	487	294	500
V(G)OIs-400	4,000	4652	5000	Modulating		100-300	12	11,0	1:6	1:5	568	336	500
V(G)OIs-450	4,500	5234	5625	Modulating		100-300	12	11,0	1:6	1:5	639	378	500
V(G)OIs-500	5,000	5815	6250	Modulating		100-300	12	15,0	1:7	1:5	710	420	500
V(G)OIs-600	6,000	6978	7500	Modulating		100-300	13	18,5	1:7	1:5	852	504	500
V(G)OIs-700	7,000	8141	8750	Modulating		200-300	14	22	1:8	1:5	994	588	500
V(G)OIs-800	8,000	9304	10000	Modulating		300	15	30	1:8	1:5	1136	672	500
V(G)OIs-1000	10,000	11630	12500	Modulating		300	17	37	1:10	1:5	1420	840	500
V(G)OIs-1250	12,000	13956	15000	Modulating		300	17	45	1:10	1:5	1704	1008	500

D Checklist Periodic Maintenance

		Vitotherm B.V. Overgauwseweg 8 2641 NE Pijnacker tel: +31153694757 Netherlands www.vitotherm.nl		Location name:	
		Burner type:			
		Serial number:			
		Customer reference:			
		Executed by (name):			
		Date:			
General preventive guidelines (M&E) for a Vitotherm burner installation on a hot water boiler					
Control panel Check status Burner flame controller unit Check status flame amplifier Check if copy of the program is made Check visual of electrical connections Check cables for any sign of overload / burning Check fuses circuit breakers rating correct Check for correct operation of timers Check operation of alarms on panel Check switch computer functional or manual use burner Check fuel interlocks Air transport Check modulation motor air damper Check free movement of air dampers Check and clean air dampers Check soundness shipments Converter Check display function Check if copy of settings is made Measuring nipples closed Checked ?	Burner unit Check all components are sure Check burner ignition system Check and clean igniters, replace if required Check condition of burner head Check injectors on condition Check connectors Check / clean oil nozzles Check ignition transformer Check and clean UV / IR scanner Check and clean wheel Check and clean air intake Check / remove status soundproofing material Check bearings (noise and flexibility) Check RPM sensor, mounting correct ? Motor Check general status gas train Check operation of gas train Check shutters and components for leak Check pilot valves on function Check main valves on function Check Leaktest				
High pressure Gas regulator Check if pressure output is stable Check Pressure relief setting and status Check Pressure exhaust setting and status	-	mbar			
Pressure switches Check LD Minimum gas pressure switch before gas valves Check LD1 minimum gas pressure switch after gas valves Check LD2-L Air pressure switch Check LD2-H Air pressure switch Check LT Leaktest control switch Check HD maximum gas pressure switch after gas regulator Check HD1 / Start maximum gas pressure switch after gas valves	-	mbar			
Switches (if present) Check ES-1 next to butterfly gas valve. Check ES-2 in to the main gas valve Check ES-3 next to the air damper open position. Check ES-4 next to the air damper closed position.	-	Setting < 10% closed position			
Boiler safety switches Check Maximum boiler temperature thermostat Check Minimum liquid level switch (low water probe) Check Maximum boiler pressure switch Check Minimum boiler pressure switch Check Shunt pump is running at burner release		Setting < 110 °C resistent Ω Setting < 3 Bar Setting > 0,2 Bar			
CO2 Check visual valve motor condition Check valve connection okay ? Check pipes connected well on the fan? Check Maximum temperature CO2 Check LD2-CO2 Air pressure switch Check Valve not closed ES6	-	Setting < 65°C mbar			
CO detection Check for correct operation and status Check pump operation Check sensor with 100 ppm CO gas Check pump pressure switch					
Condensor Check if condensation tray is clean Check if drain pipe is clean Check if damper is movable Check Maximum temperature condensor Check HD condensor maximum pressure switch by condensor Check Pump running at burner release		Setting < 95°C mbar			
Oil Check oil pump visual on status and running Check for leaks Check filter is clean Check operation of solenoid valves Check Maximum oil pressure switch Check Minimum oil pressure switch Check ES condensor valve position oil	-	bar bar			
Switches (if present) Check ES condensor valve position oil		Setting < 85% open; Blocking oil function when chimney not open			
Flue gas emissions Check O2 Check CO Check NOx Check flue gas temperature		>< % < ppm < ppm < °C			
Notes:					

Vitotherm BV

Overgauwseweg 8

2641 NE Pijnacker

T (+31) 015 369 47 57

F (+31) 015 369 77 42

info@vitotherm.nl

www.vitotherm.nl